

WYK 117K 111100011K
WYK 117K 111100011K

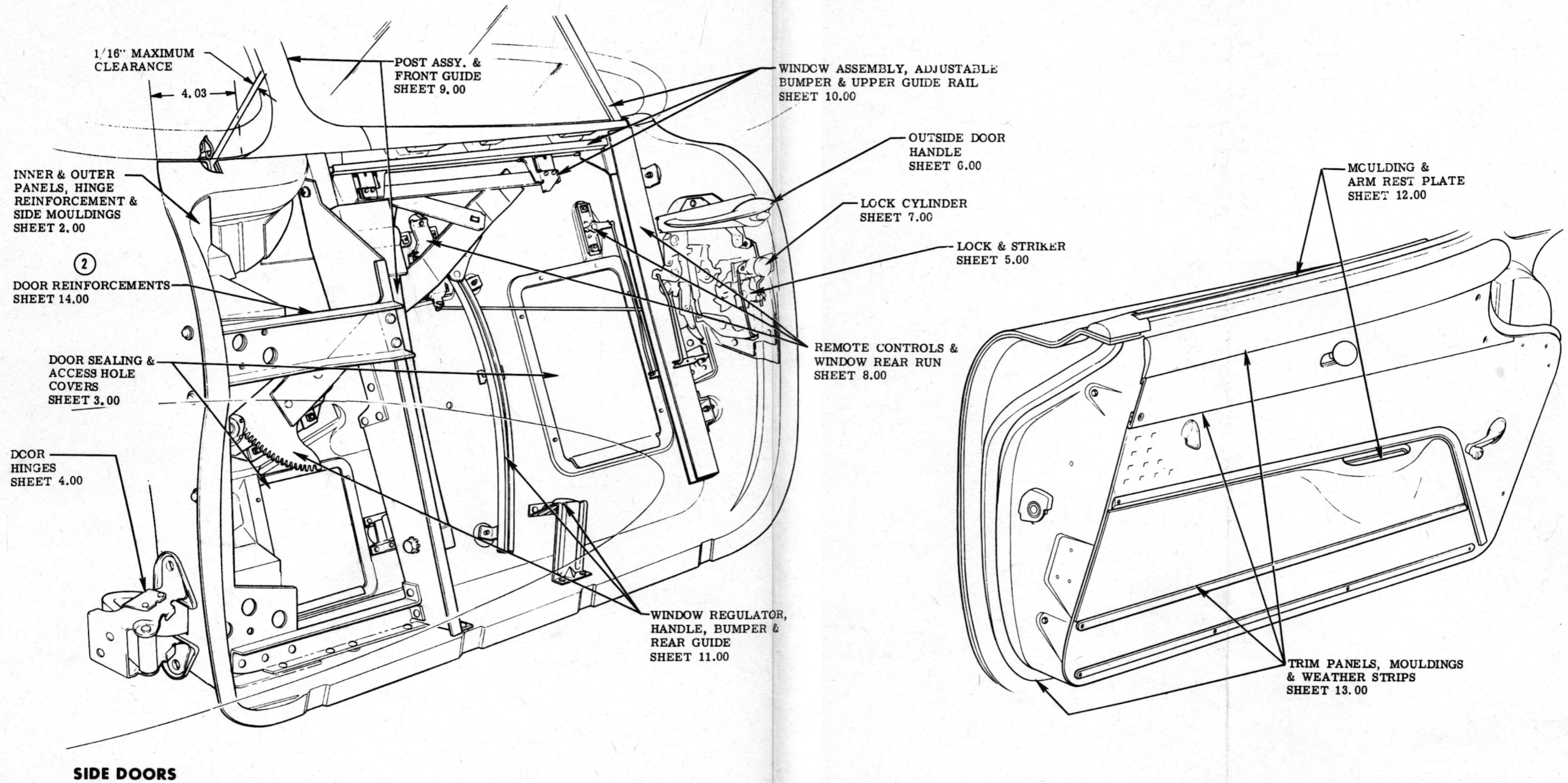

						NAME CORVETTE INSTRUCTION MANUAL			
		REF.	DRAWN	CHECKED	SECT.	SHEET			
6-11-57	2	VIEW REV. & NOTE ADDED	624	V	F				
4-2-56	1	REDRAWN & REVISED 8093-5909-5618			F				
DATE	SYM.	REVISION RECORD	AUTH.	DR.	CK.	DATE	PART No.		
						9-15-55	3726900	F 1.00	

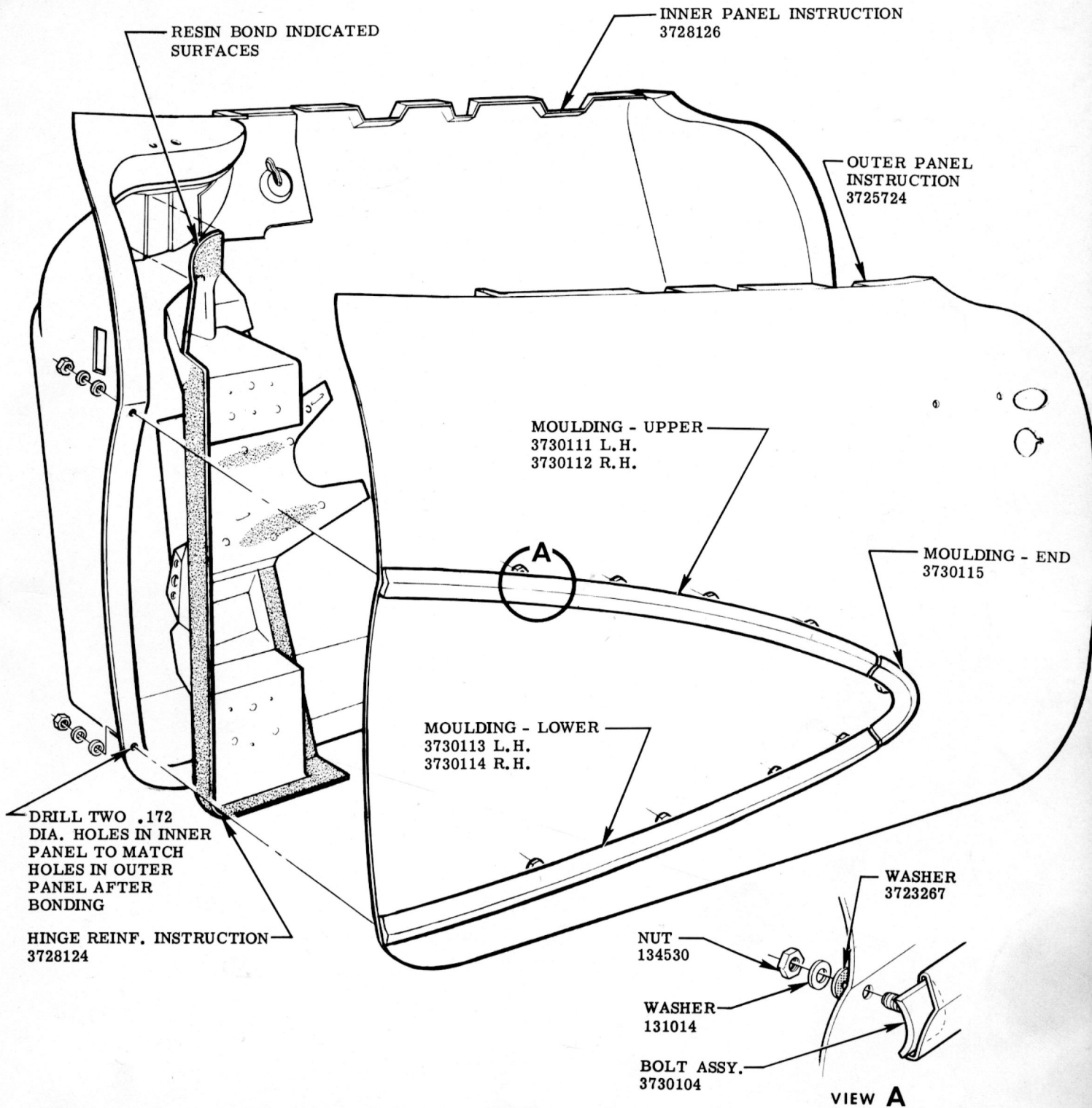

INNER & OUTER PANELS, HINGE REINFORCEMENT & SIDE MOULDINGS

						NAME	CORVETTE INSTRUCTION MANUAL			
						REF.	DRAWN J. J.	CHECKED L. S.	SECT.	SHEET
7-31-56	4	REDRAWN & REV. FOR 57	2416	V	F	DATE	PART No.		F	2.00
DATE	SYM.	REVISION RECORD	AUTH.	DR.	CK.	9-15-55	3726900			

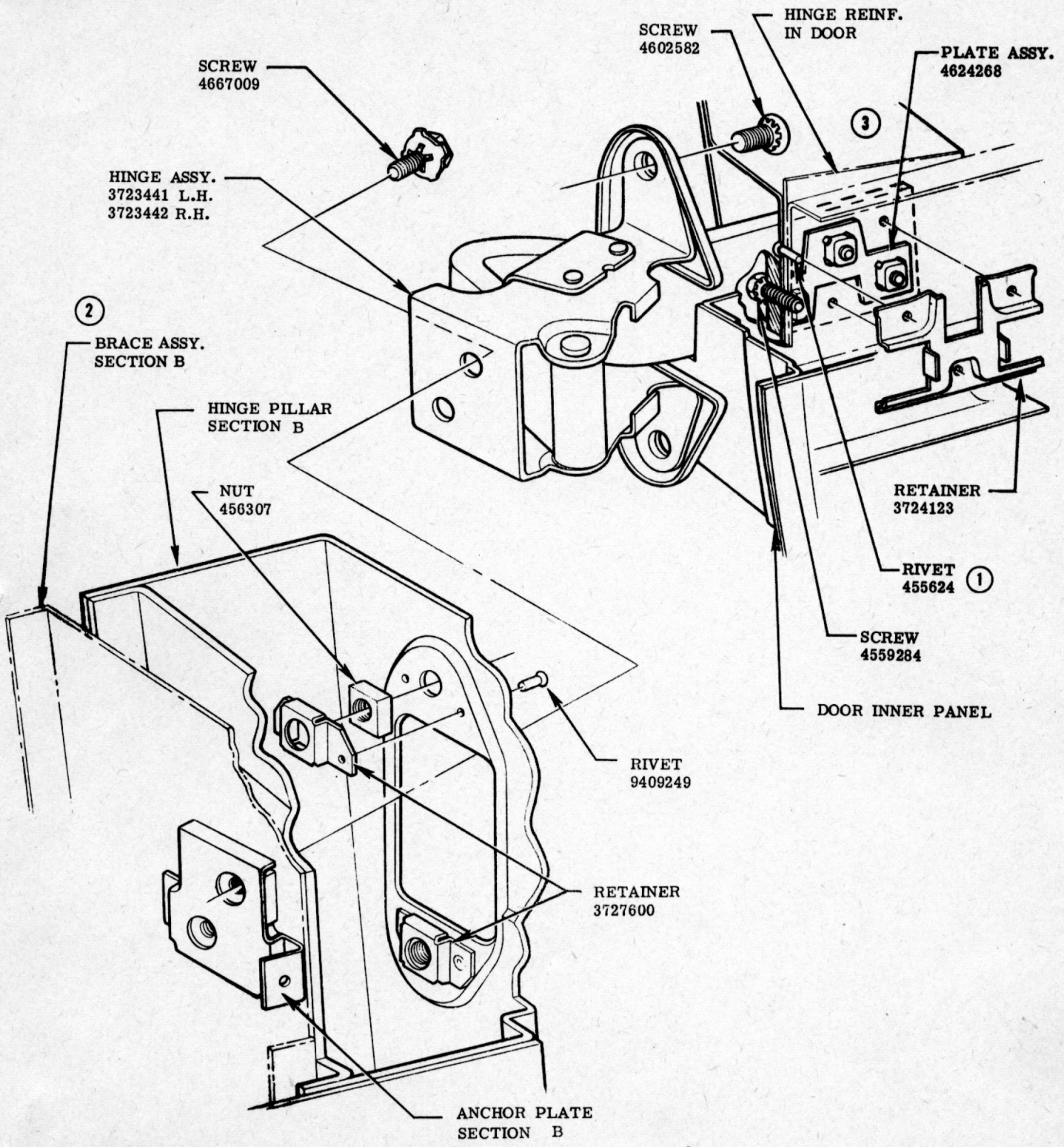

DOOR HINGE

					CORVETTE INSTRUCTION MANUAL				
					NAME				SHEET
	3	VIEW REVISED			REF.	DRAWN J. J.	CHECKED L. S.	SECT. F	4.00
6-11-57	2	VIEW REV. & NOTE ADDED	624	V	DATE				
7-23-56	1	WAS 9409249 IN ERROR			9-15-55	PART No.	3726900		
DATE	SYM.	REVISION RECORD	AUTH.	DR.	CK.				

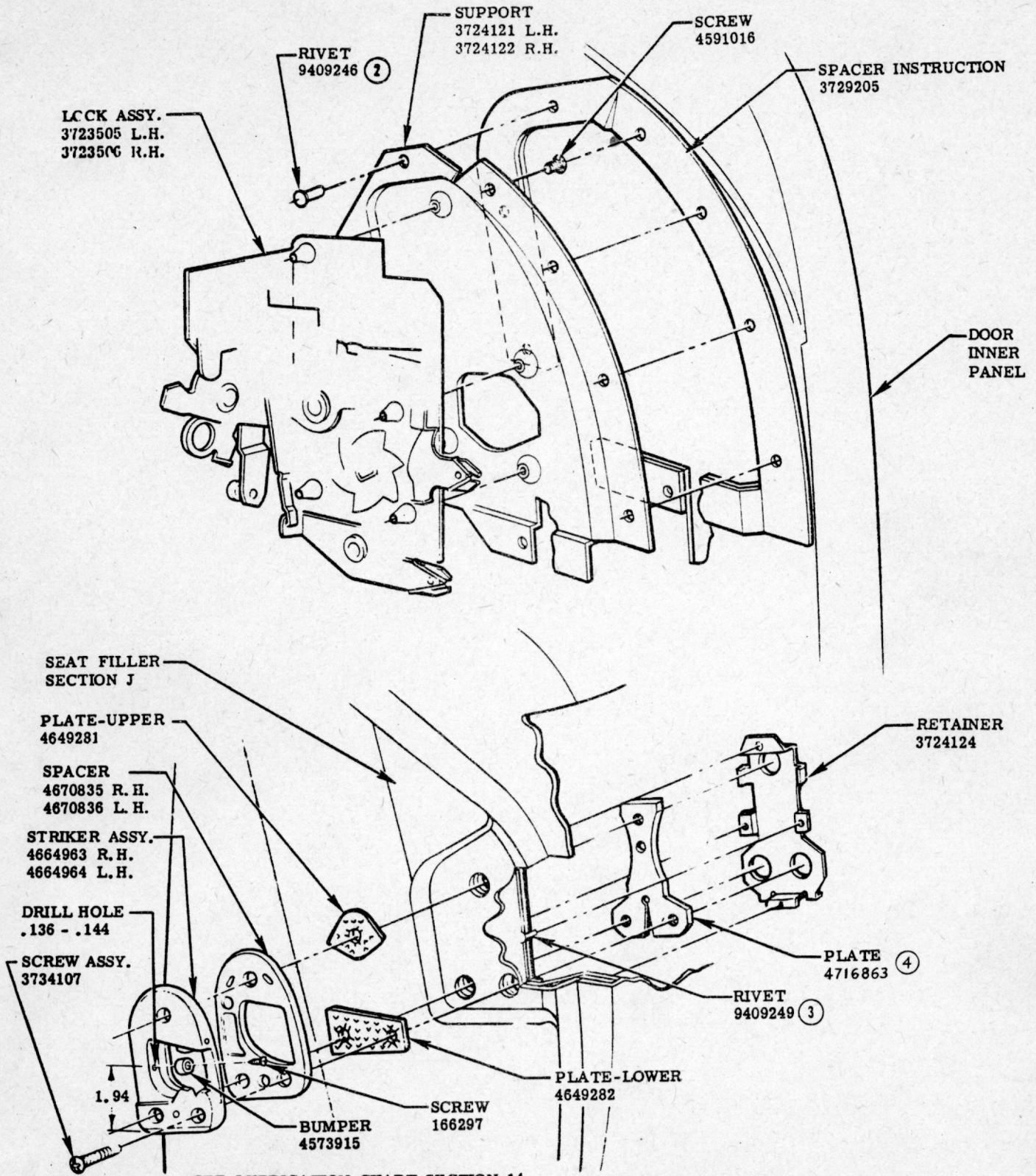

SEE LUBRICATION CHART SECTION 14

LOCK & STRIKER.

DATE	SYM.	REVISION RECORD	AUTH.	DR.	CK.	NAME	CORVETTE INSTRUCTION MANUAL			
6-1-57	4	WAS 4668255	675		F	REF.	DRAWN J. J.	CHECKED L. S.	SECT. F	SHEET 5.00
4-30-57	3	WAS 118089	9797		F	DATE	PART No.			
3-25-57	2	WAS 9409244	528		F	.9-15-55	3726900			
3-12-56	1	REDRAWN & REVISED 7971	6841	V	F					
		6794	5960							

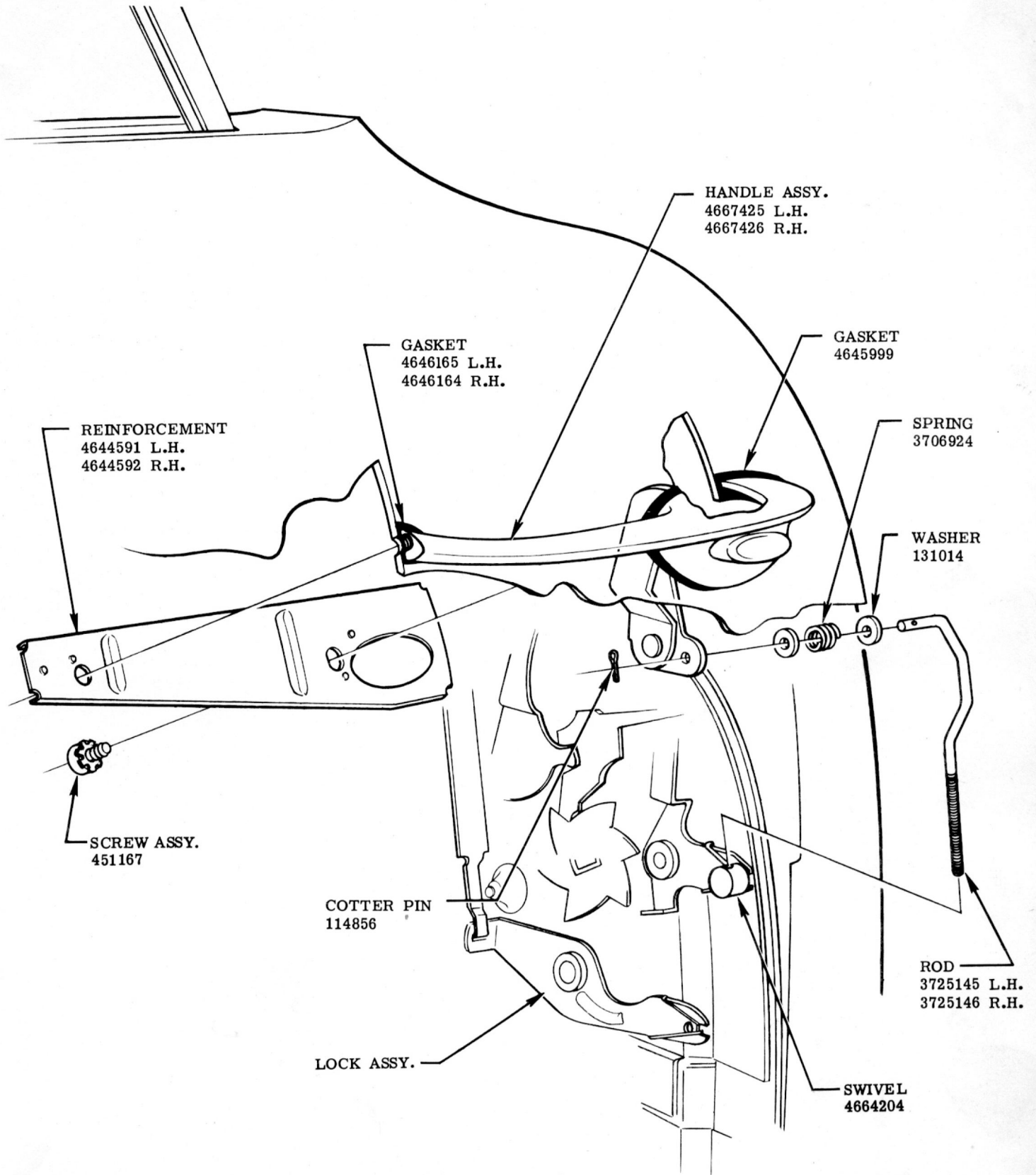

OUTSIDE DOOR HANDLE

					NAME					CORVETTE INSTRUCTION MANUAL					
					REF.		DRAWN		CHECKED		SECT.		SHEET		
							J. J.		L. S.		F		6.00		
7-31-56					1		REDRAWN & REVISED FOR 57					2415		F	
DATE					SYM.		REVISION RECORD					AUTH.		DR. CK.	
							DATE					PART No.			
							9-15-55					3726900			

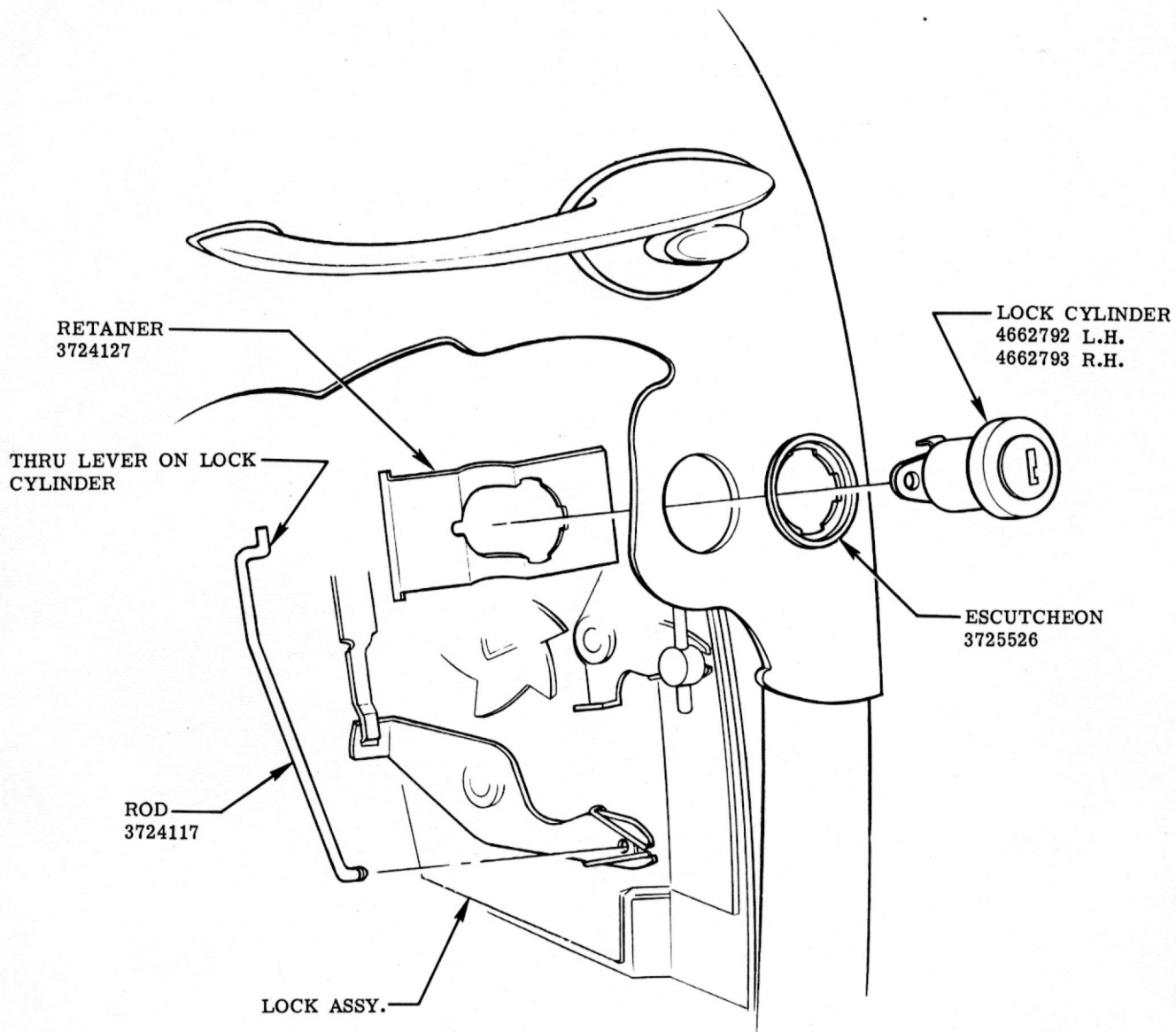

LOCK CYLINDER

						NAME	CORVETTE INSTRUCTION MANUAL			
						REF.	DRAWN R. M.	CHECKED L. S.	SECT.	SHEET
						DATE	PART No.		F	7.00
DATE	SYM.	REVISION RECORD	AUTH.	DR.	CK.	9-15-55	3726900			

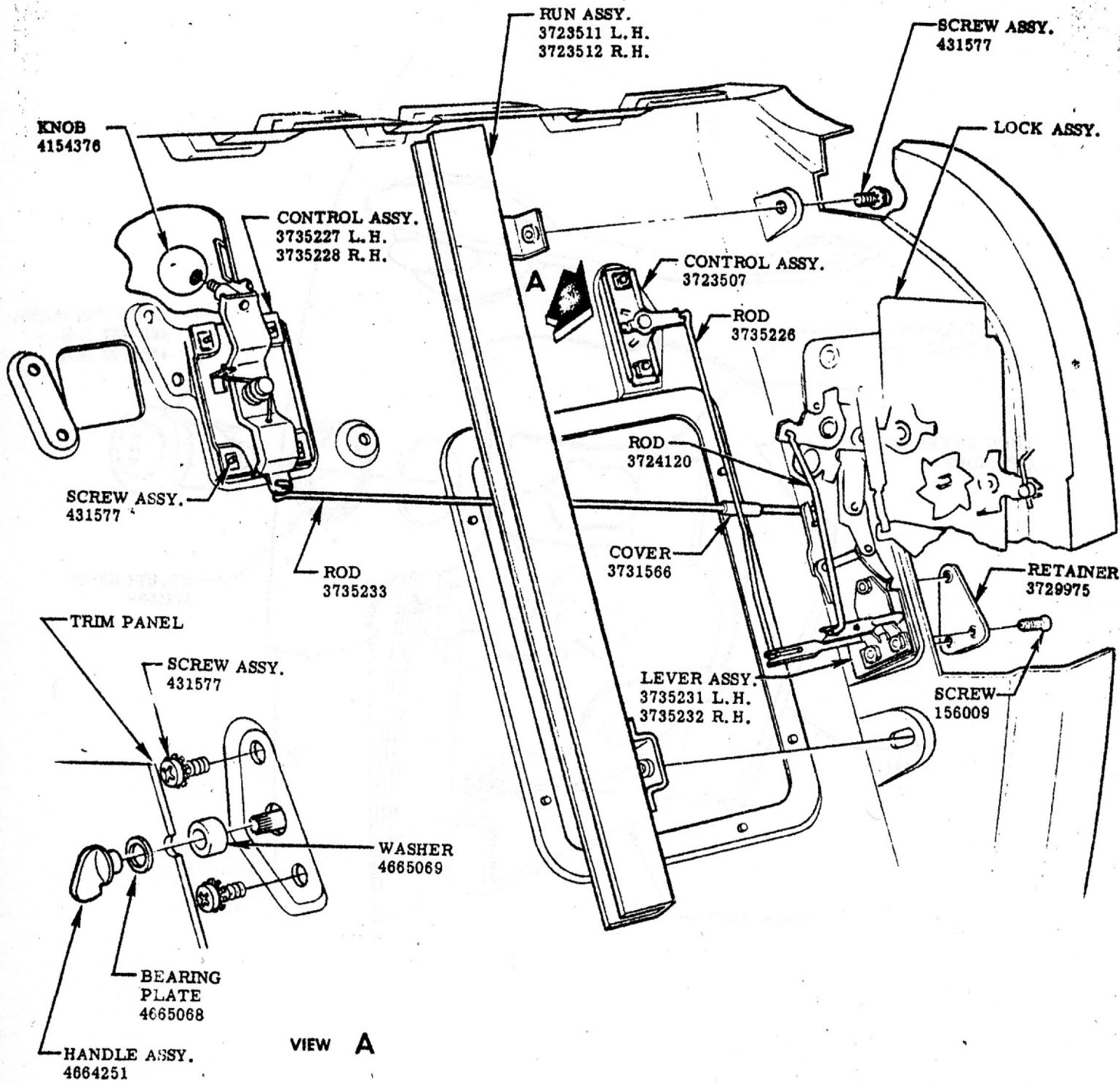

SEE LUBRICATION CHART SECTION 14

REMOTE CONTROLS & WINDOW REAR RUN

				NAME					CORVETTE INSTRUCTION MANUAL				
				REF.	DRAWN		CHECKED		SECT.	SHEET			
4-23-56				1	J. J.		L. S.		F	8.00			
				REDRAWN & REVISED		7990	7816	V	F				
						7607-7583	5960						
DATE	SYM	REVISION RECORD		AUTH	DR	CK	DATE	PART No.		3726900			
							9-15-55						

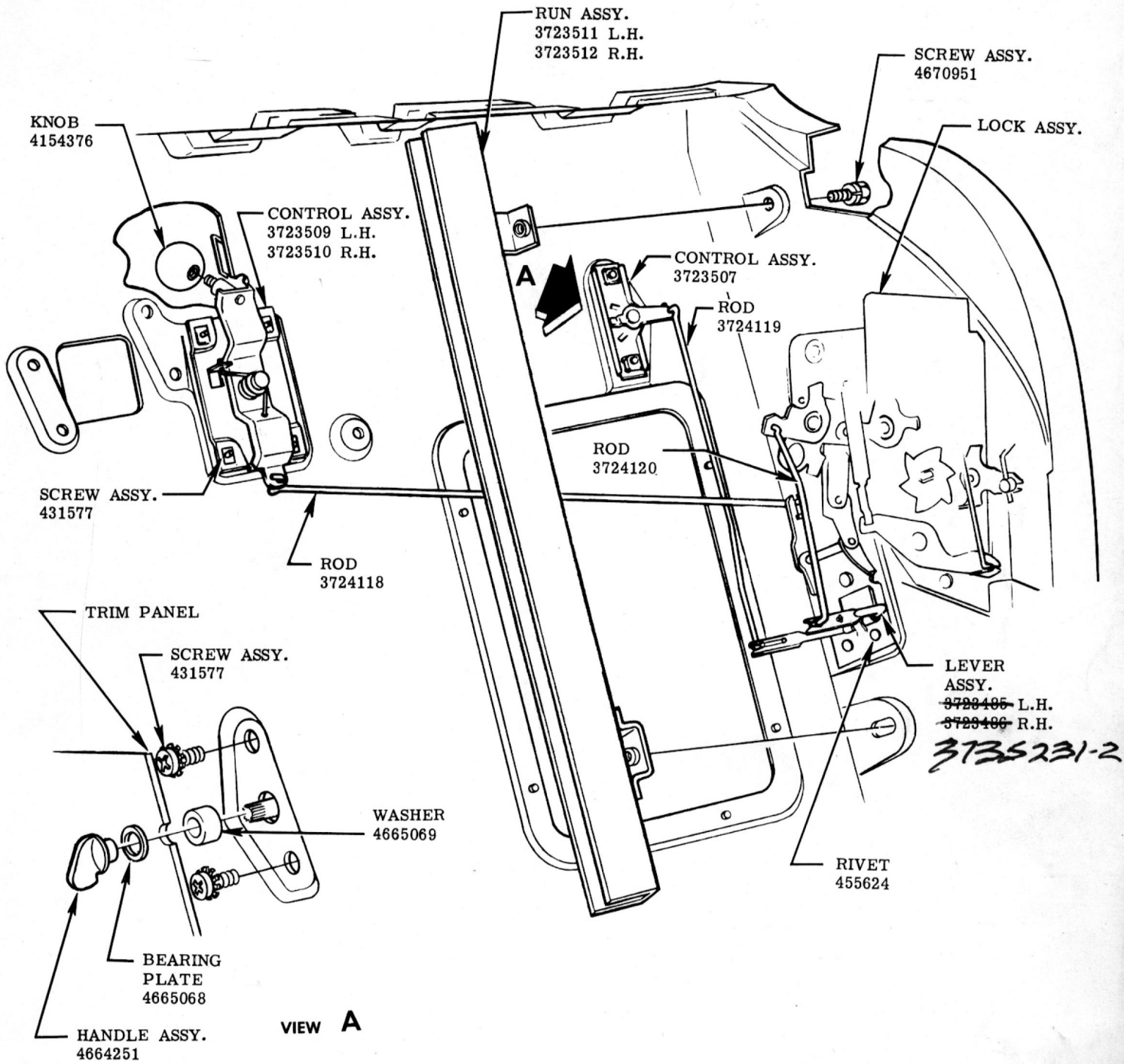

SEE LUBRICATION CHART SECTION 14

REMOTE CONTROLS & WINDOW REAR RUN

						NAME	CORVETTE INSTRUCTION MANUAL			
						REF.	DRAWN J. J.	CHECKED L. S.	SECT. F	SHEET 8.00
						DATE 9-15-55	PART No. 3726900			
DATE	SYM.	REVISION RECORD	AUTH.	DR.	CK.					

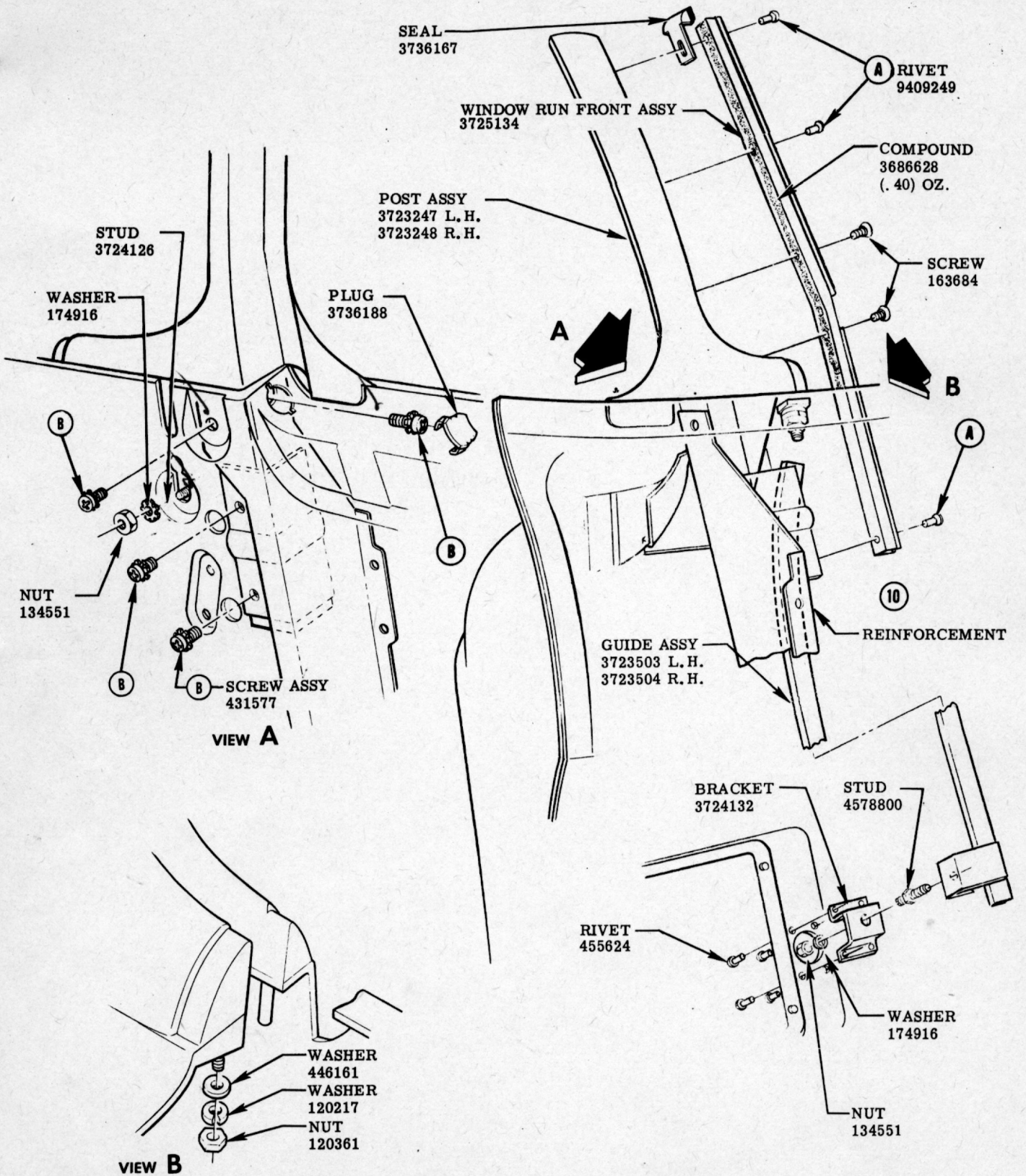

POST ASSEMBLY & FRONT GUIDE

					NAME CORVETTE INSTRUCTION MANUAL				
					REF.	DRAWN J. J.	CHECKED L. S.	SECT. F	SHEET 9.00
6-11-57	9	VIEW REV. & NOTE ADDED	624	V	DATE 9-15-55	PART No. 3726900			
DATE	SYM.	REVISION RECORD	AUTH.	DR.	CK.				

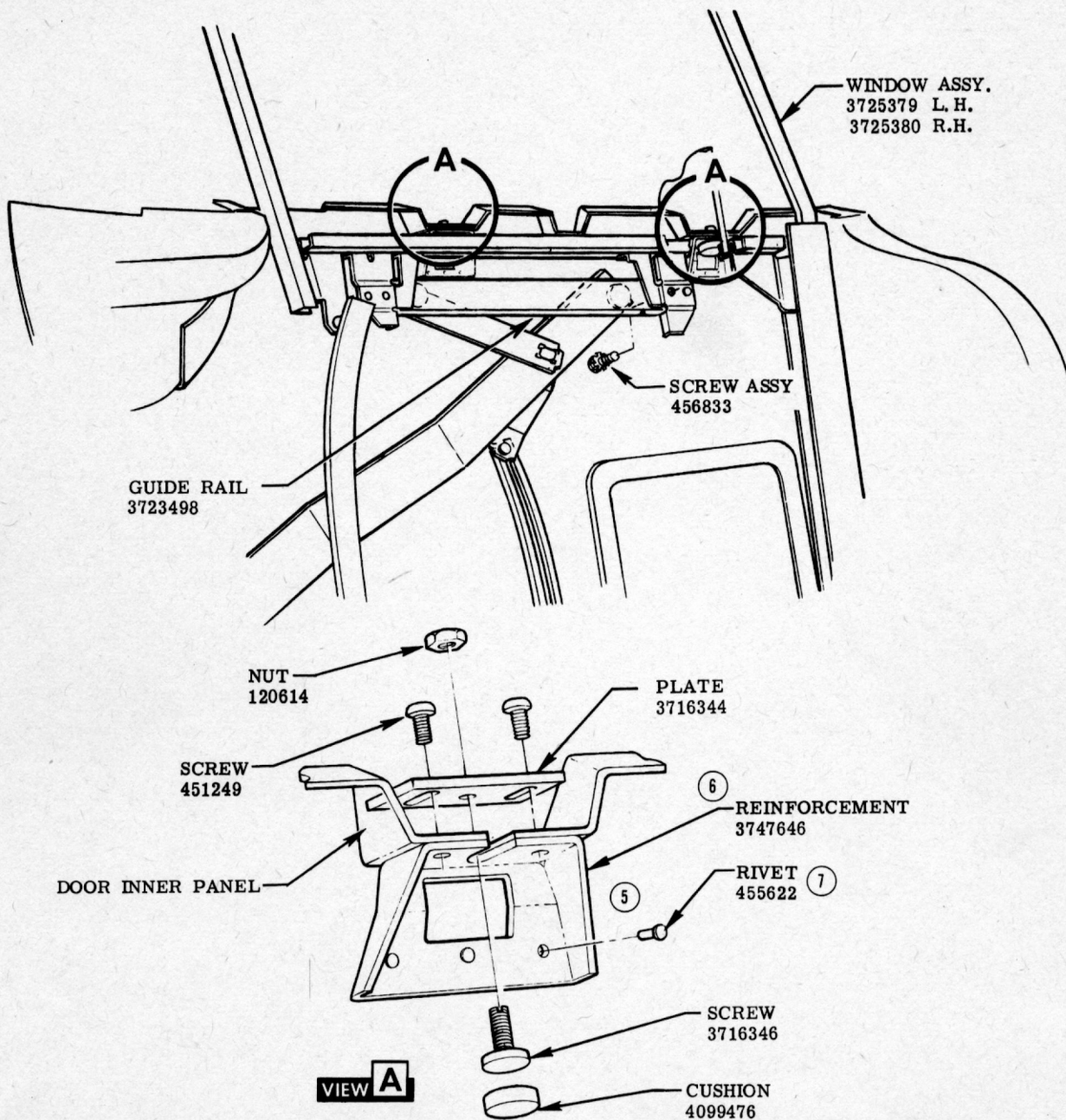

**WINDOW ASSEMBLY, ADJUSTABLE
BUMPER & UPPER GUIDE RAIL.**

					NAME	CORVETTE INSTRUCTION MANUAL			
	7	PART ADDED			REF.	DRAWN J. J.	CHECKED L. S.	SECT.	SHEET
	6	WAS 3716345 RETAINER						F	10.00
	5	9409249 RIVET REMOVED			DATE	PART No.	3726900		
5-13-57	4	REDRAWN	500	V	9-15-55				
DATE	SYM.	REVISION RECORD	AUTH.	DR.	CK.				

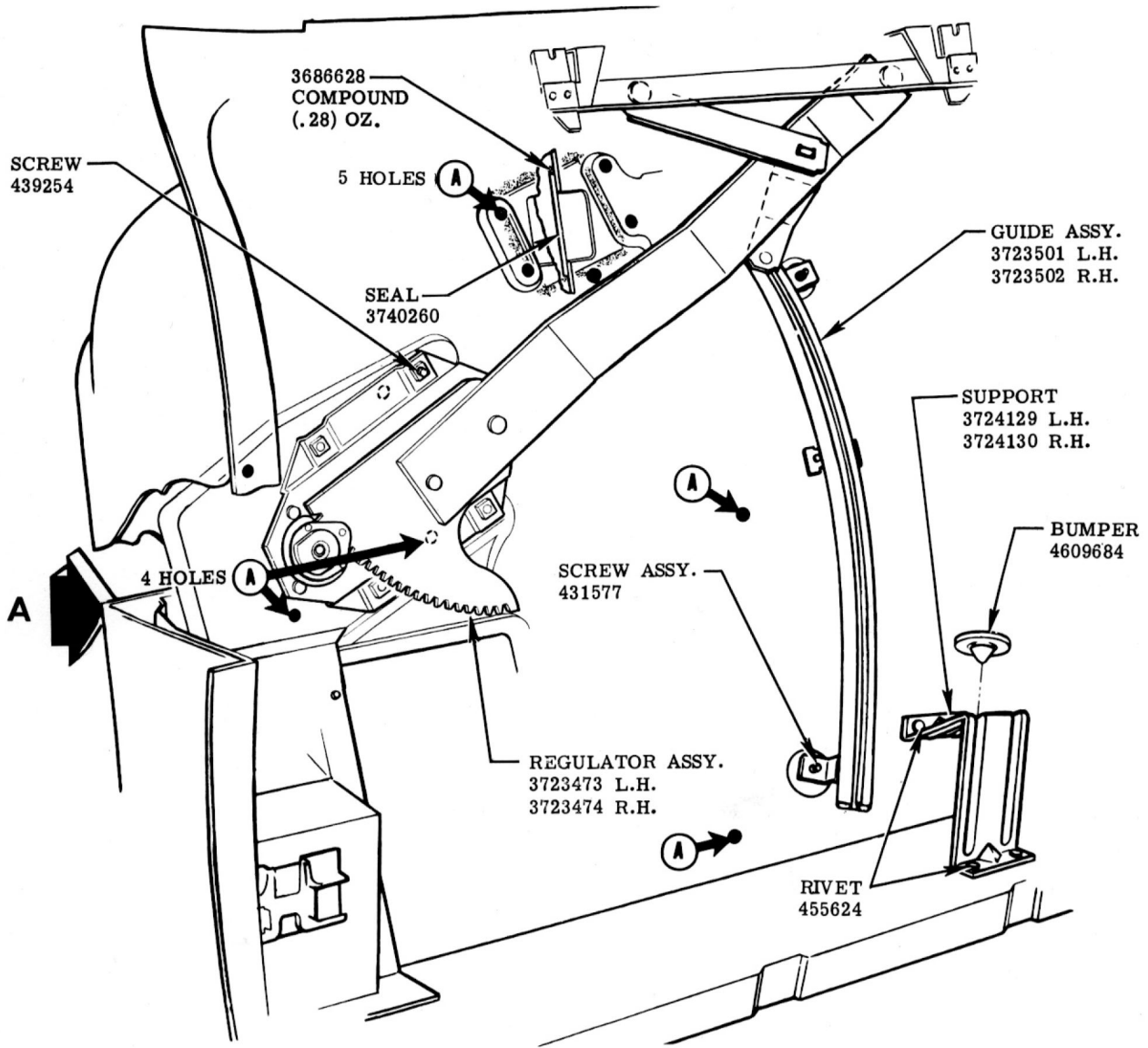
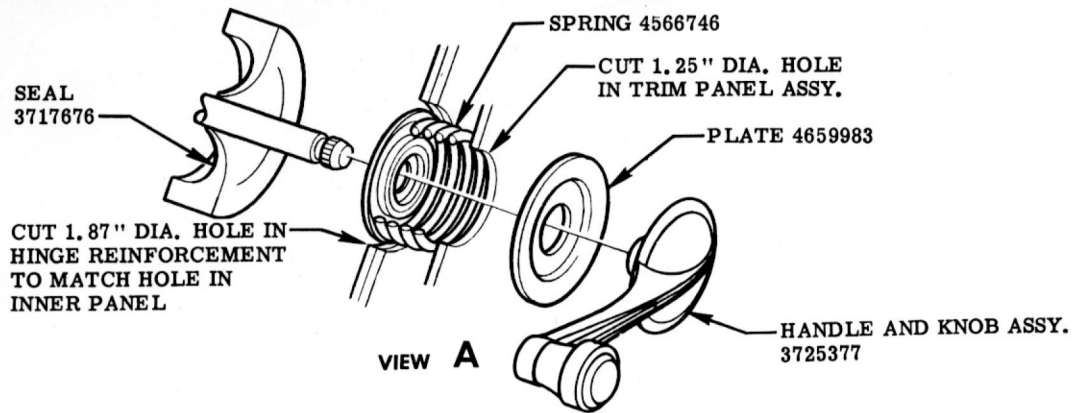

(A) → = FILL ELECTRIC WINDOW REGULATOR HOLES INDICATED BY THIS SYMBOL WITH RESIN

WINDOW REGULATOR, BUMPER & REAR GUIDE

					NAME				CORVETTE INSTRUCTION MANUAL			
					REF.	DRAWN		CHECKED		SECT.	SHEET	
						J. J.		L. S.		F	11.00	
					DATE	PART No.						
11-13-56	3	REDRAWN & REVISED	4059	V F	9-15-55	3726900						
DATE	SYM.	REVISION RECORD	AUTH.	DR. CK.								

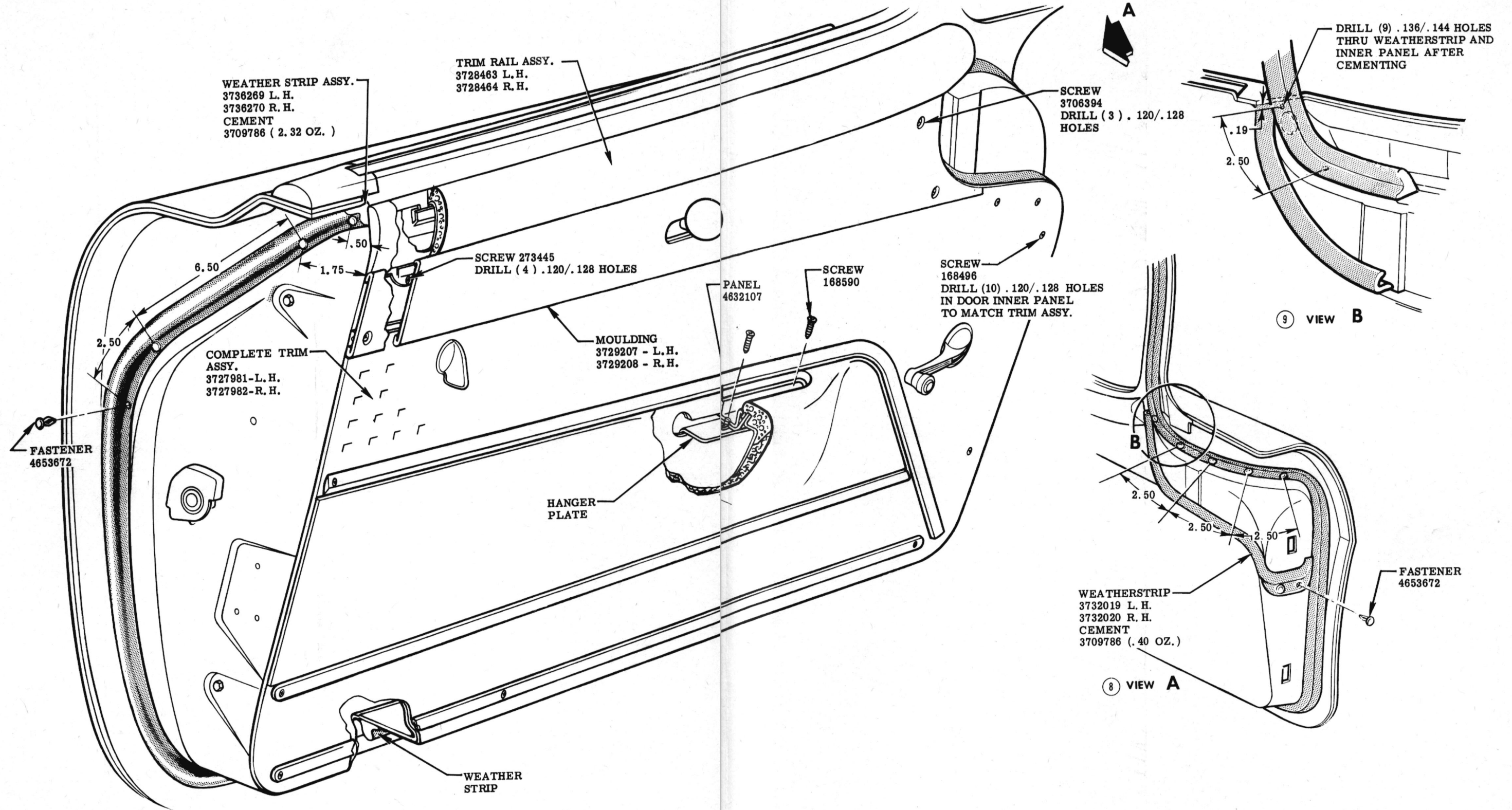

TRIM PANEL, MOULDING & WEATHER STRIPS

					NAME CORVETTE INSTRUCTION MANUAL					
DATE	SYM.	REVISION RECORD	AUTH.	DR.	CK.	REF.	DRAWN	CHECKED	SECT.	SHEET
	9	VIEW REVISED				F	J. J.	L. S.	F	13.00
	8	VIEW REVISED								
4-9-57	7	REDRAWN	490			DATE 9-15-55	PART No. 3726900			

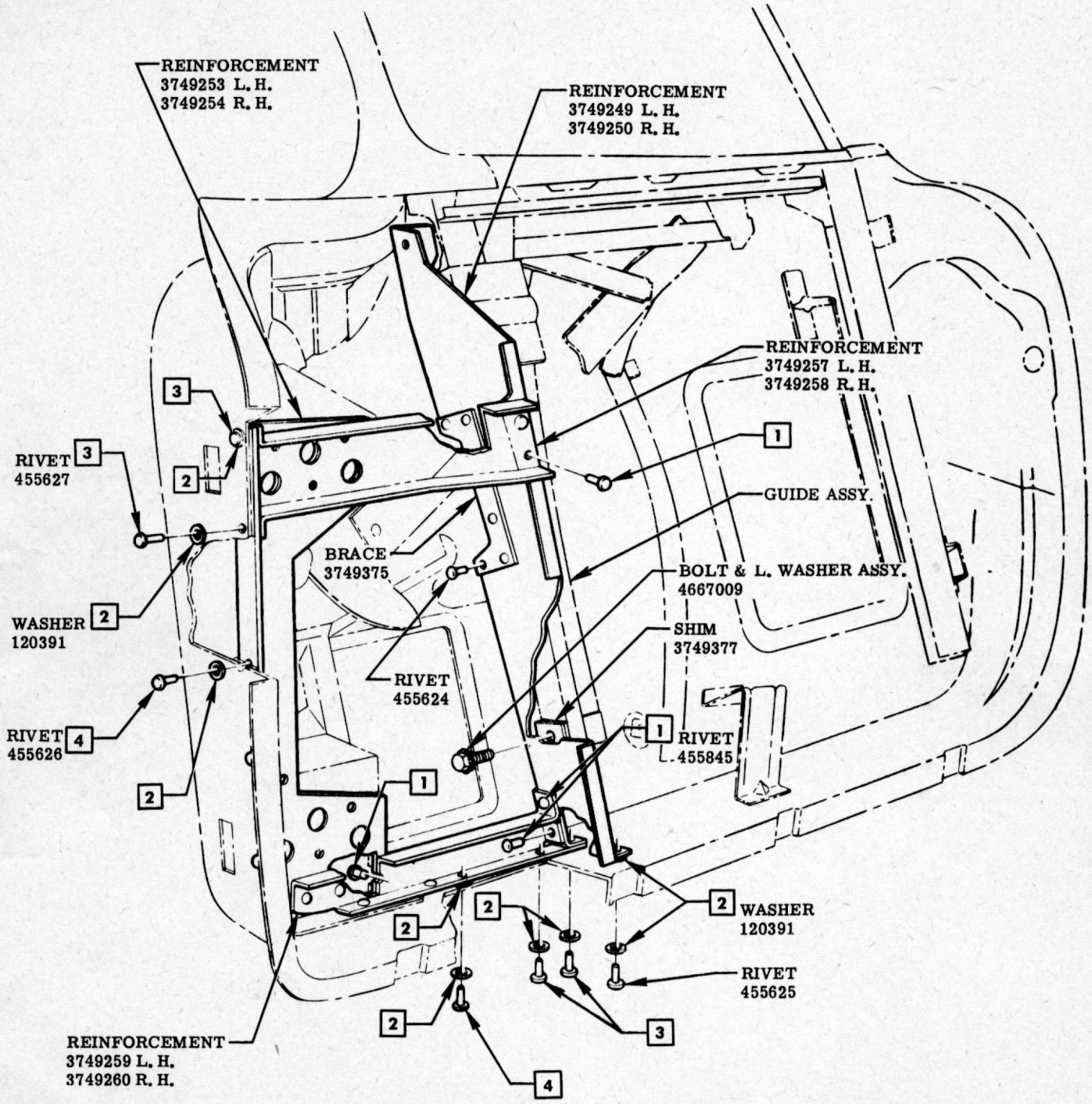

SIDE DOOR REINFORCEMENTS

					NAME CORVETTE INSTRUCTION MANUAL				
					REF. L-48297	DRAWN V	CHECKED F	SECT. F	SHEET 14.00
7-11-57	RELEASED		624		DATE 7-8-57	PART No. 3726900			
DATE	SYM.	REVISION RECORD	AUTH.	DR.	CK.				