

WYLLIE & CO. LTD.
PRINTERS
GLASGOW

WYLLIE & CO. LTD.
PRINTERS
GLASGOW



CORVETTE INSTRUCTION MANUAL INTRODUCTION

The Corvette Instruction Manual illustrates the operations required for the final assembly of the car.

The manual is arranged in sections corresponding as closely as practicable to the Uniform Parts Classification Groups to which the component parts and assemblies are assigned at the point of release. Section O is an index to the U.P.C. sections. Section index drawings are provided at the head of sections where warranted. Assembly Instructions for Factory Optional Accessories and Regular Production Options are shown separately at the rear of the manual and are indexed on the following page.

Major exceptions to placement of parts and assemblies in sections corresponding to their U. P. C. groups are as follows:

1. Section 12 has been expanded to include engine electrical wiring.
2. For torque specifications, refer to 3728000, Torque Instruction Manual.
3. For all plastic bonding operations use Resin 3711175.

This manual has been designed to expedite furnishing the latest information to the user. It is imperative, therefore, that additions and revisions be inserted in their proper places and that superseded sheets be removed and destroyed.

○ This symbol with a numeral, when shown, indicates changes.



CORVETTE INSTRUCTION MANUAL INTRODUCTION

The Corvette Instruction Manual illustrates the operations required for the final assembly of the car.

The manual is arranged in sections corresponding as closely as practicable to the Uniform Parts Classification Groups to which the component parts and assemblies are assigned at the point of release. Section O is an index to the U.P.C. sections. Section index drawings are provided at the head of sections where warranted. Assembly Instructions for Factory Optional Accessories and Regular Production Options are shown separately at the rear of the manual and are indexed on the following page.

Major exceptions to placement of parts and assemblies in sections corresponding to their U. P. C. groups are as follows:

1. Section 2 has been eliminated. The frame assy. number is shown in Section 1.
2. Section 12 has been expanded to include engine electrical wiring.
3. For torque specifications, refer to 3728000, Torque Instruction Manual.
4. For all plastic bonding operations use Resin 3711175. For all metal to plastic bonding operations use Resin 3730229

This manual has been designed to expedite furnishing the latest information to the user. It is imperative, therefore, that additions and revisions be inserted in their proper places and that superseded sheets be removed and destroyed.

○ This symbol with a numeral, when shown, indicates changes.



CORVETTE

F. O. A. AND R. P. O. INSTRUCTION INDEX

F. O. A. 101	HEATER
F. O. A. 102	RADIO
F. O. A. 107	PARKING BRAKE ALARM
F. O. A. 108	COURTESY LIGHT
F. O. A. 109	WINDSHIELD WASHER
R. P. O. 313	AUTOMATIC TRANSMISSION
R. P. O. 419	HARD TOP
R. P. O. 426	POWER LIFT WINDOWS
R. P. O. 469	DUAL FOUR BARREL CARBURETORS
R. P. O. 473	HYDRAULIC FOLDING TOP



R. P. O. AND F. O. A. INDEX

* SPEEDWAY TYPE TIRE CASING	R. P. O. 290
+ CLOSE RATIO TRANSMISSION	R. P. O. 303
AUTOMATIC TRANSMISSION	R. P. O. 313
HARD TOP	R. P. O. 419
PARKING BRAKE ALARM	R. P. O. 420
COURTESY LIGHT	R. P. O. 421
WINDSHIELD WASHER	R. P. O. 422
POWER LIFT WINDOWS	R. P. O. 426
HEATER	F. O. A. 101
RADIO	F. O. A. 102
OIL FILTER	F. O. A. 104
* R. P. O. 290 SAME AS SECTION 10 EXCEPT TIRE NUMBER 3721705	
+ R. P. O. 303 SAME AS SECTION 7 EXCEPT TRANSMISSION NUMBER 3729697	

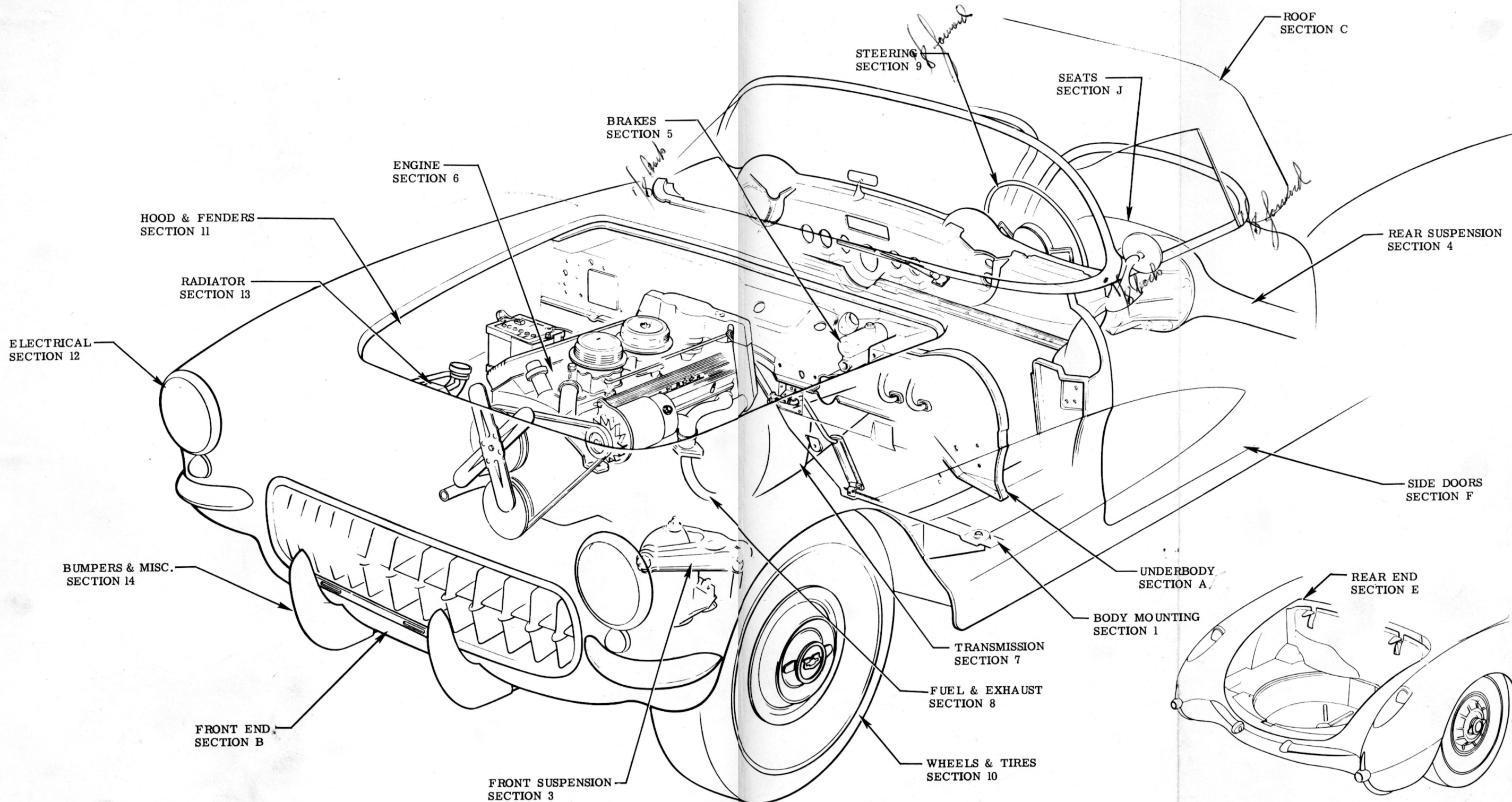

LUBRICATION CHART SECTION 14
GENERAL INDEX

						NAME CORVETTE INSTRUCTION MANUAL				
						REF.	DRAWN W.S.	CHECKED L.S.	SECT.	SHEET
						DATE 9-15-55	PART No. 3726900		0	1.00
DATE	SYM.	REVISION RECORD	AUTH.	DR.	CK.					