

WAXMILLER & COMPANY

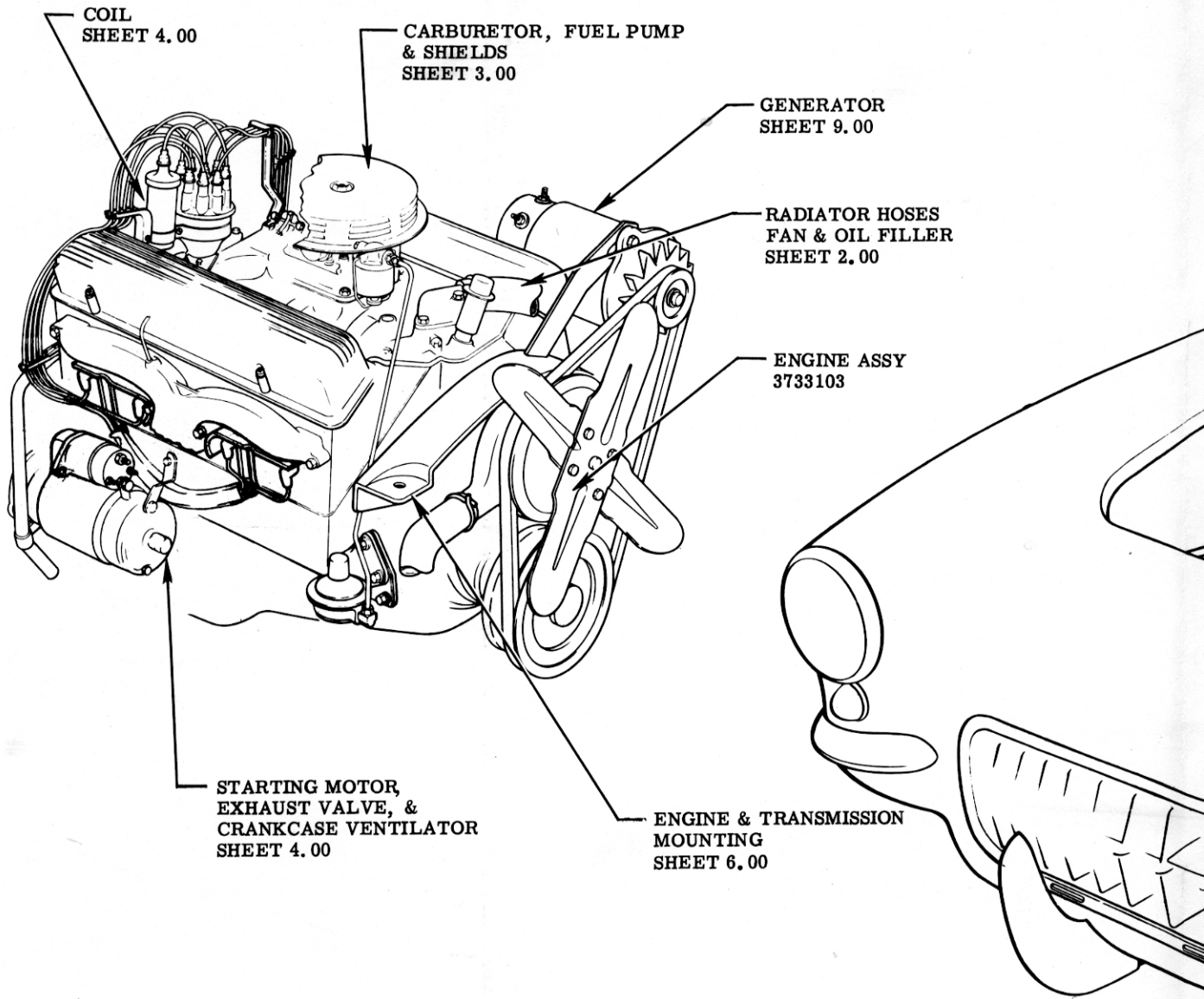

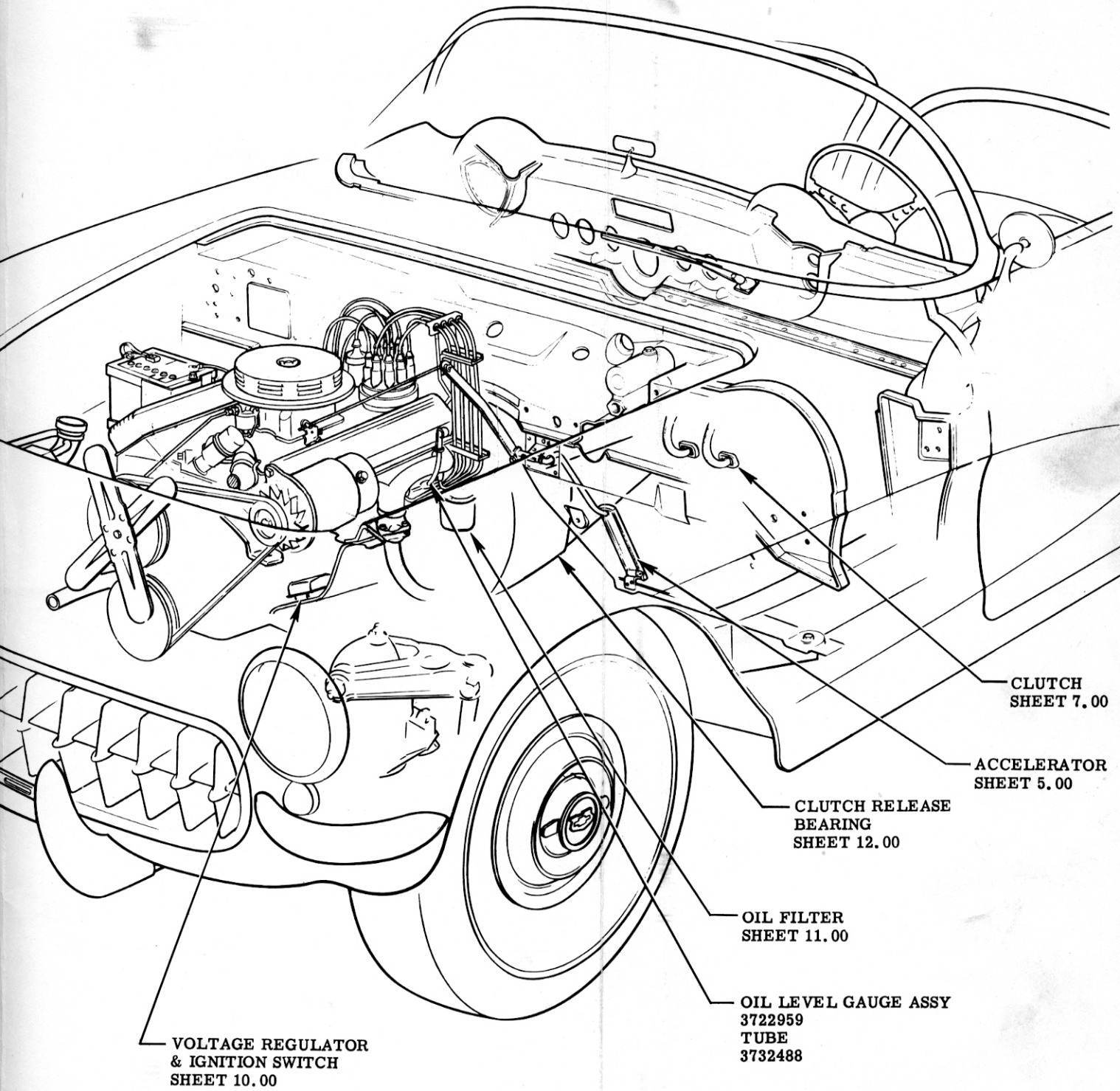

						NAME CORVETTE INSTRUCTION MANUAL				
7-31-56	4	REDRAWN & REVISED FOR 57	8010		F	REF.	DRAWN W.S.	CHECKED L.S.	SECT.	SHEET
			5098	V		DATE	PART No.		6	1.00
						9-15-55	3726900			
DATE	SYM.	REVISION RECORD	AUTH.	DR.	CK.					

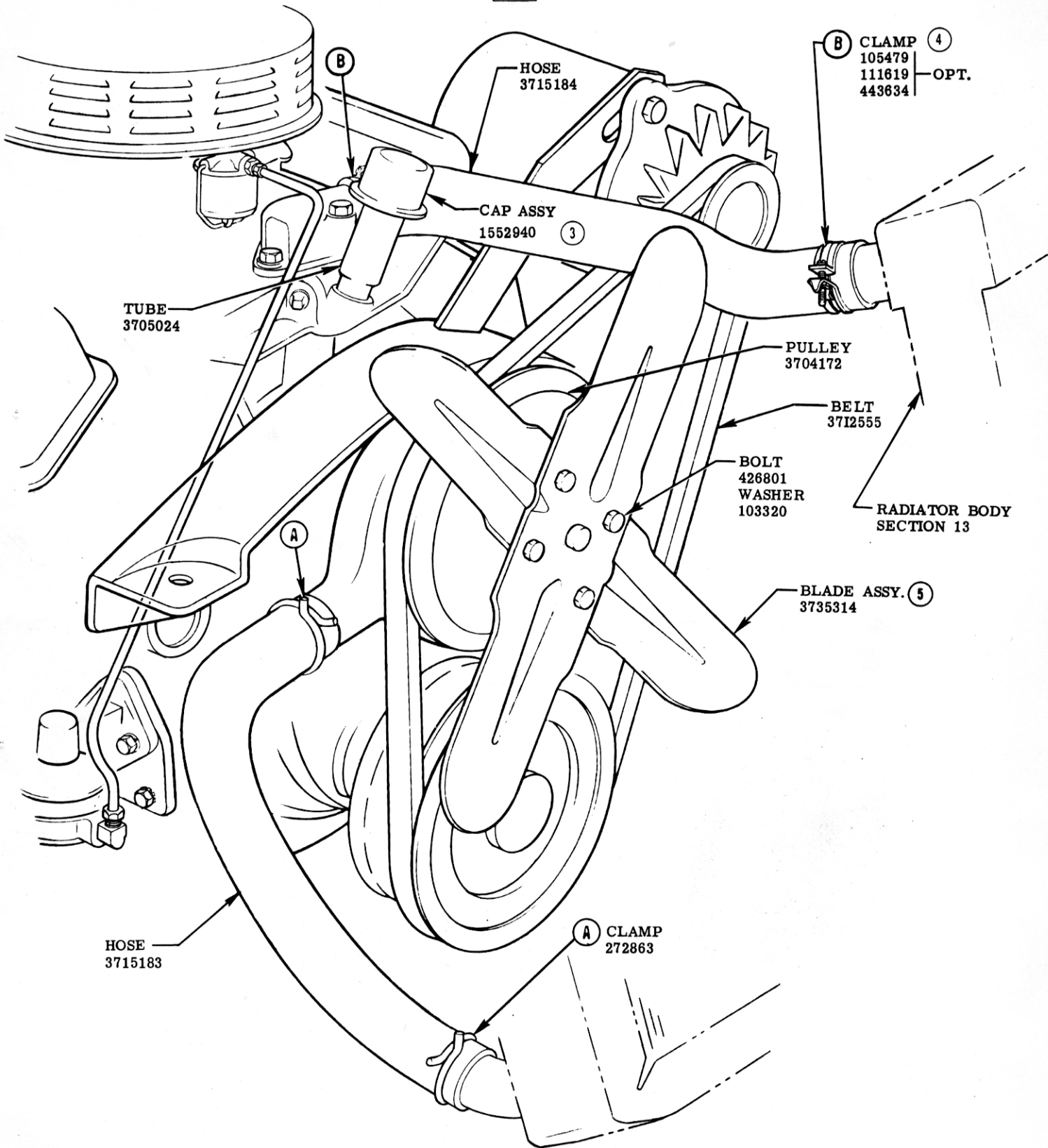

SEE LUBRICATION CHART SECTION 14
RADIATOR HOSES, FAN & OIL FILLER

REVISION RECORD					CORVETTE INSTRUCTION MANUAL					
DATE	SYM.	REVISION RECORD	AUTH.	DR.	CK.	NAME	DRAWN W.S.	CHECKED L.S.	SECT.	SHEET
2-27-57	5	WAS 3704803			F	CORVETTE INSTRUCTION MANUAL	PART No. 3726900		6	2.00
11-26-56	4	WAS 272861	170		F					
7-16-56	3	WAS 1552719	2116	V	F					
5-28-56	2	REDRAWN & REVISED	8242	V	F					
						DATE				
						9-15-55				

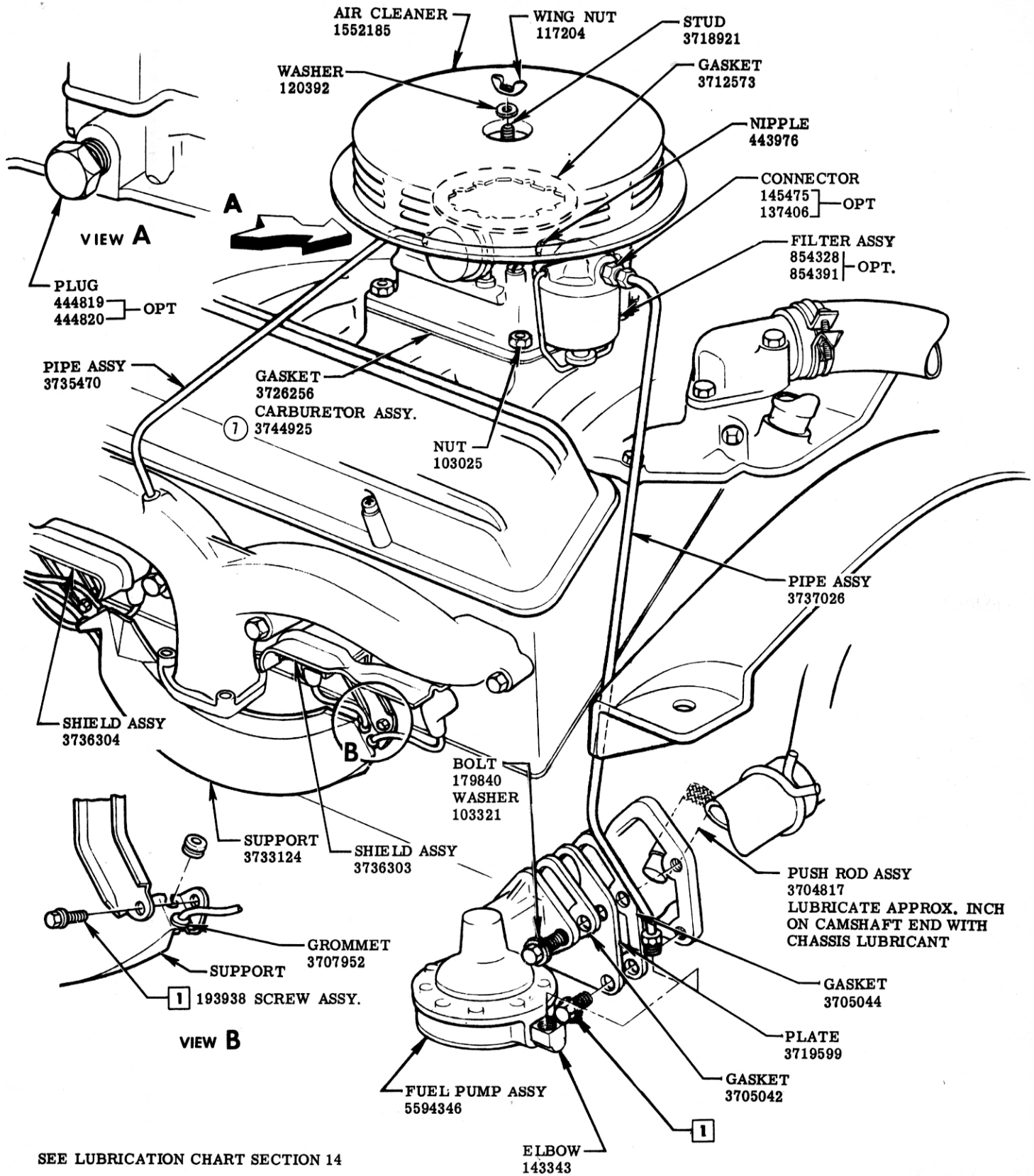

SEE LUBRICATION CHART SECTION 14

CARBURETOR, FUEL PUMP & SHIELD

					CORVETTE INSTRUCTION MANUAL			
REF.	DATE	NAME	SYMBOL	DR.	DRAWN	CHECKED	SECT.	SHEET
7	1-7-57	WAS 3733246		F		V	6	3.00
6		REDRAWN	6073					
REVISION RECORD					PART No. 3726900			
DATE SYM. REVISION RECORD AUTH. DR. CK.					DATE 9-15-55			

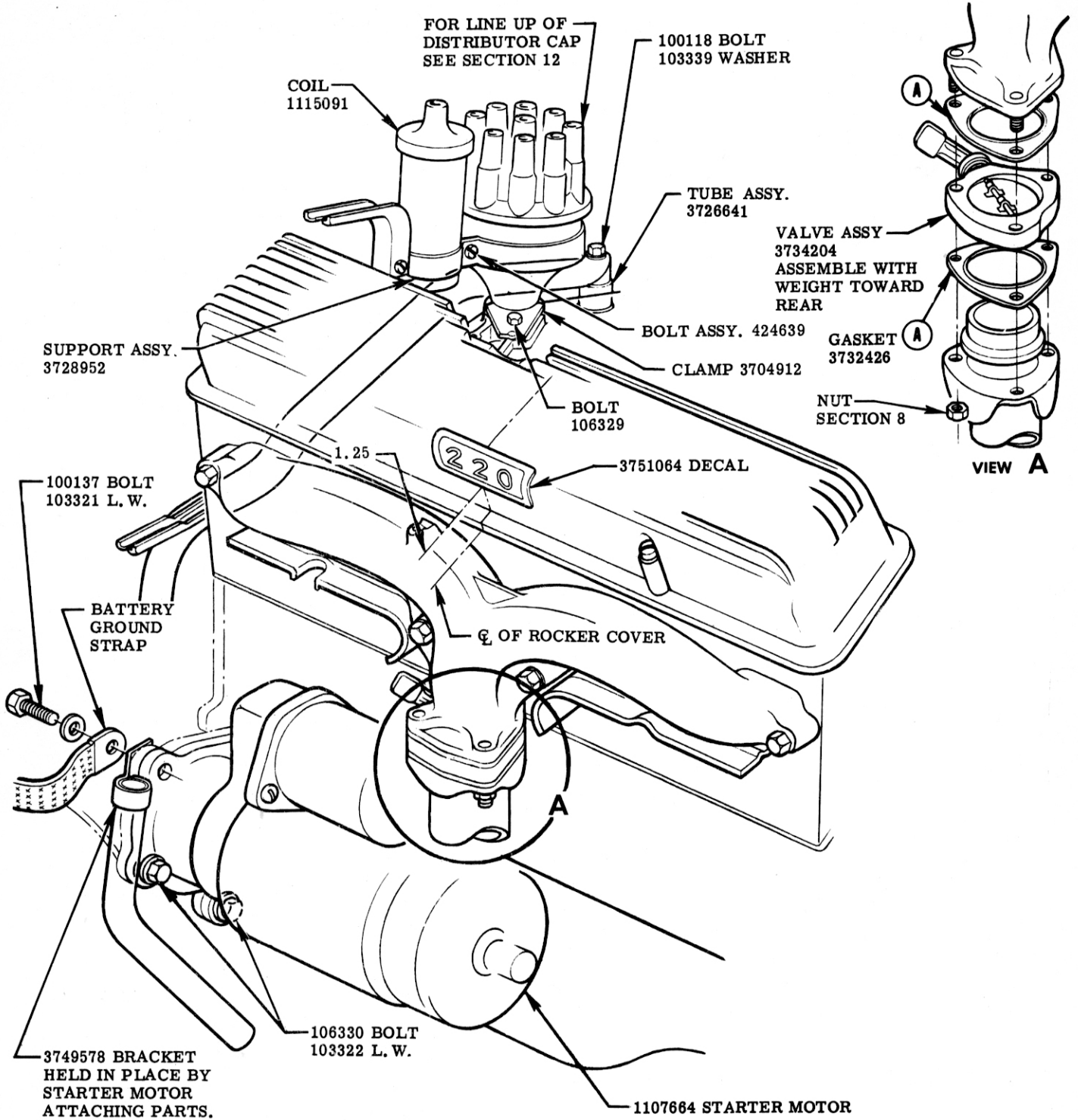

STARTING MOTOR, EXHAUST VALVE, CRANKCASE VENTILATOR, & COIL

							NAME CORVETTE INSTRUCTION MANUAL				
							REF.	DRAWN W. S.	CHECKED L. S.	SECT.	SHEET
7-25-57	5	REDRAWN & REVISED	700	606	V	F	DATE 9-15-55	PART No. 3726900		6	4.00
DATE	SYM.	REVISION RECORD		AUTH.	DR.	CK.					

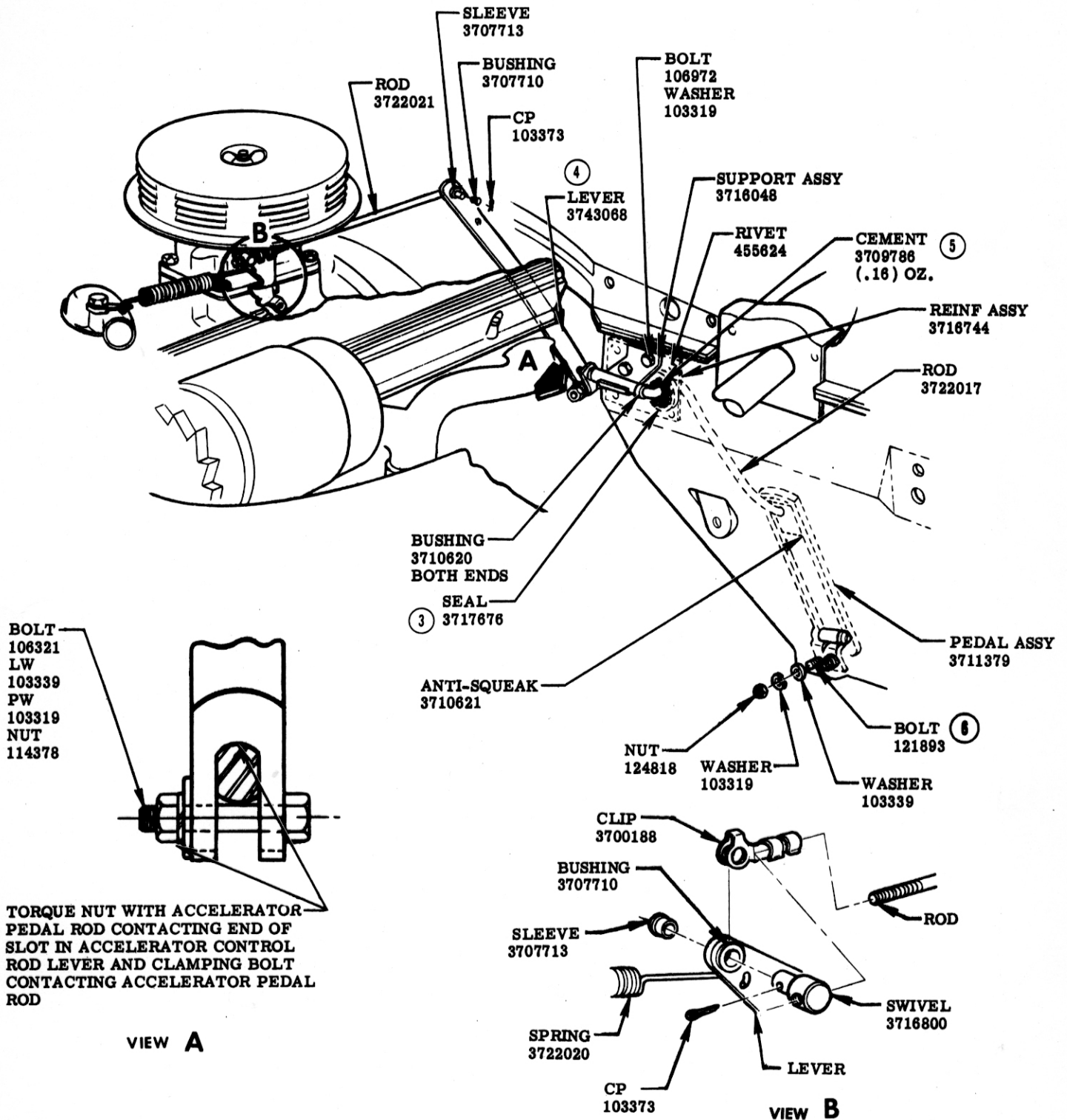

SEE LUBRICATION CHART SECTION 14

ACCELERATOR

DATE	SYM.	REVISION RECORD	AUTH.	DR.	CK.	NAME	CORVETTE INSTRUCTION MANUAL			SECT.	SHEET
4-9-57	6	WAS 106972	489	V	F						
	5	PART ADDED	4059		F						
11-13-56	4	WAS 3722018	4139	V	F						
7-16-56	3	WAS 3717576 IN ERROR			F						
5-28-56	2	REDRAWN & REVISED	8242	V	F						
						DATE	PART No			6	5.00
						9-15-55	3726900				

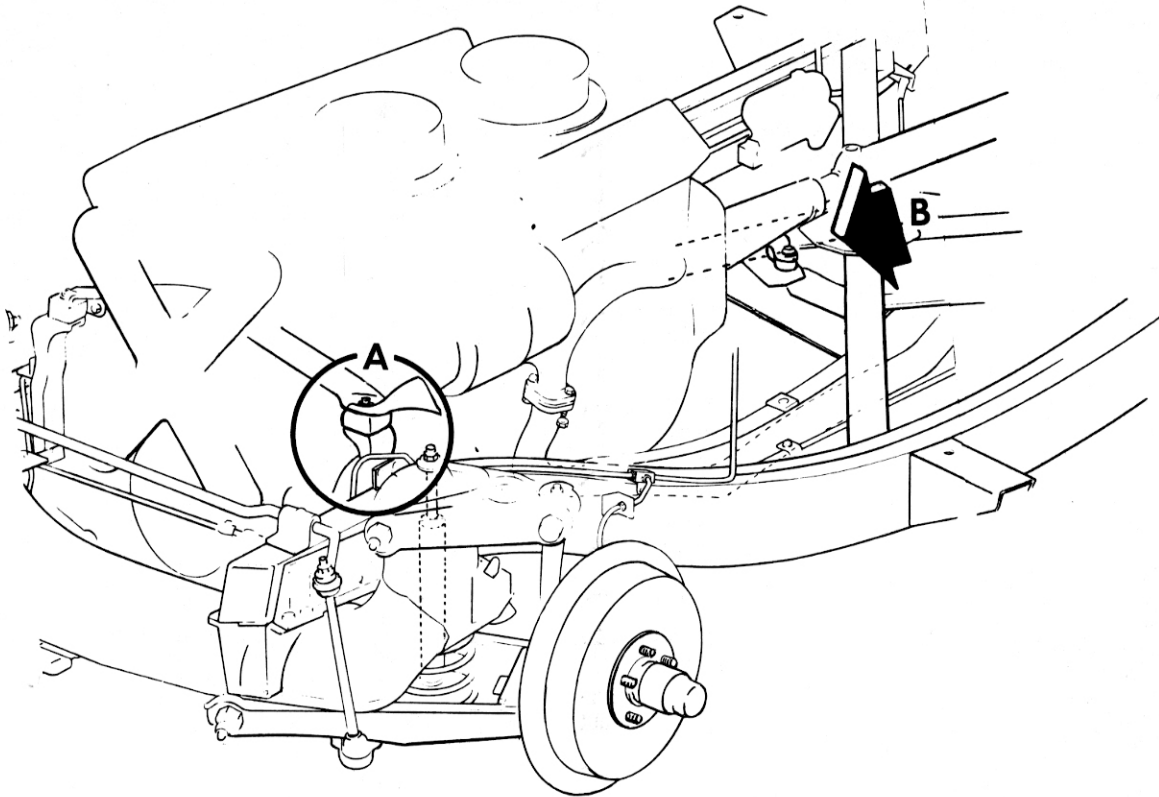

SUGGESTED ENGINE MOUNTING PROCEDURE

With engine positioned in chassis, the rubber cushions at both sides of the engine and at the transmission must not be distorted or cramped. To accomplish this objective the following assembly procedure is suggested.

1. Prior to Assembling engine in chassis:

Right & left hand engine front mountings, are to be assembled on engine with the mounting bolt nuts loose (engaged only 2 or 3 turns). Transmission support & cross-member assembly is to be assembled to center crossmember-leave bolts loose.

2. Assembly to chassis:

The distance between frame bracket upper supports is to be measured, and the number of shims required indicated on the right hand side member. Lower engine on combination locator & jack which locates the engine central in the frame and fore & aft by locating from the gauge holes in the top of frame side members to front face of engine.

3. After assembling engine in chassis:

Tighten two lower L.H. frame bracket bolts. Tighten two upper L.H. frame bracket bolts. Insert shims on R.H. side as indicated on side member. Tighten two lower R.H. frame bracket bolts. Tighten two upper R.H. frame bracket bolts. Remove engine from locator and jack. (Weight of engine is now on front & rear mounts). Tighten R.H. mounting bolt nut to specified torque. Tighten the 4 transmission support crossmember bolts. Shake engine (to relieve strain on mounts). Tighten L.H. mounting bolt nut to torque specified.

SHIMS
3711744
R. H. SIDE ONLY



GENERAL MOTORS CORPORATION

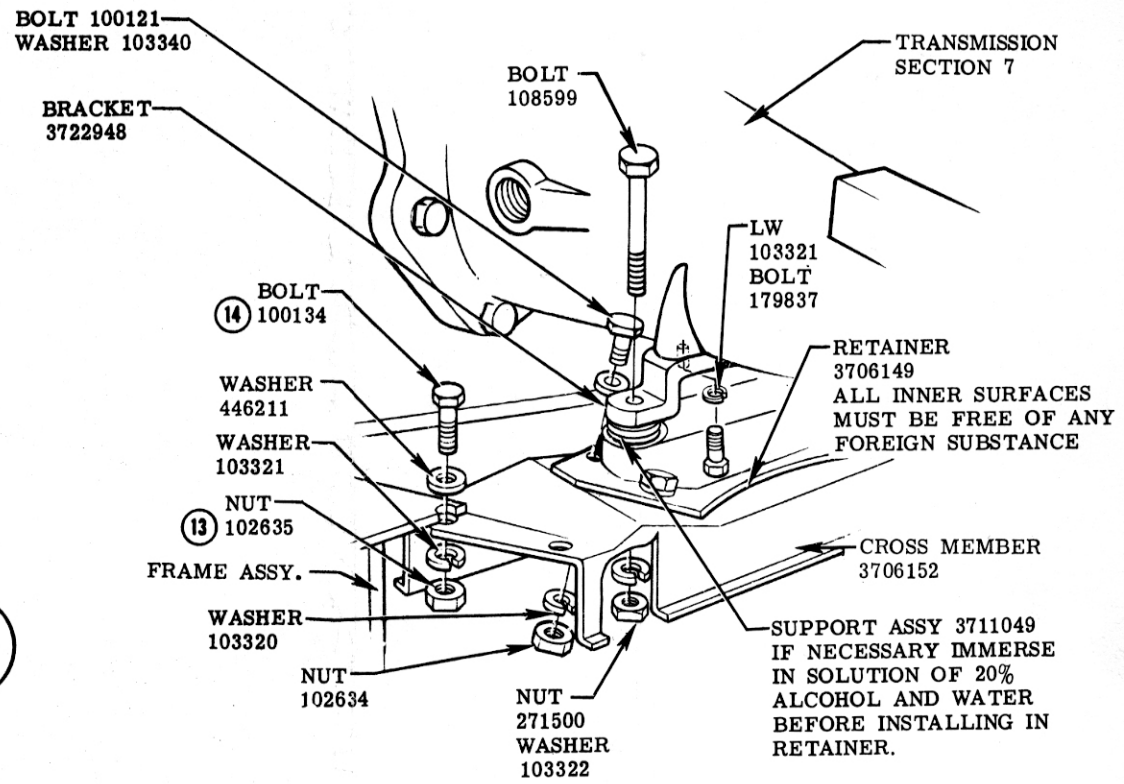
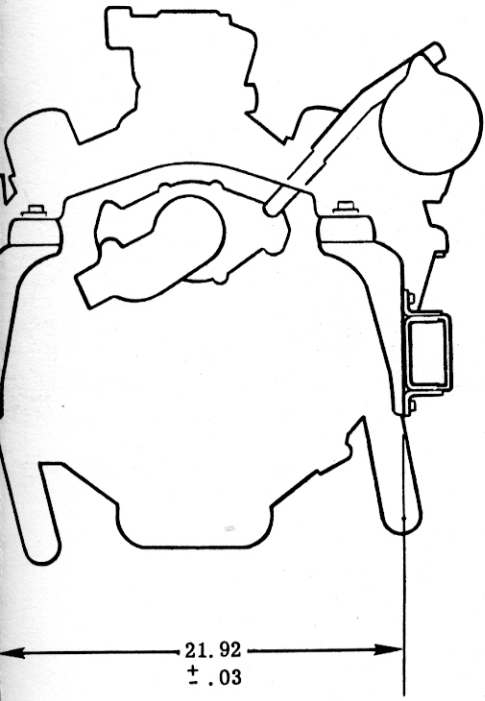

VIEW B

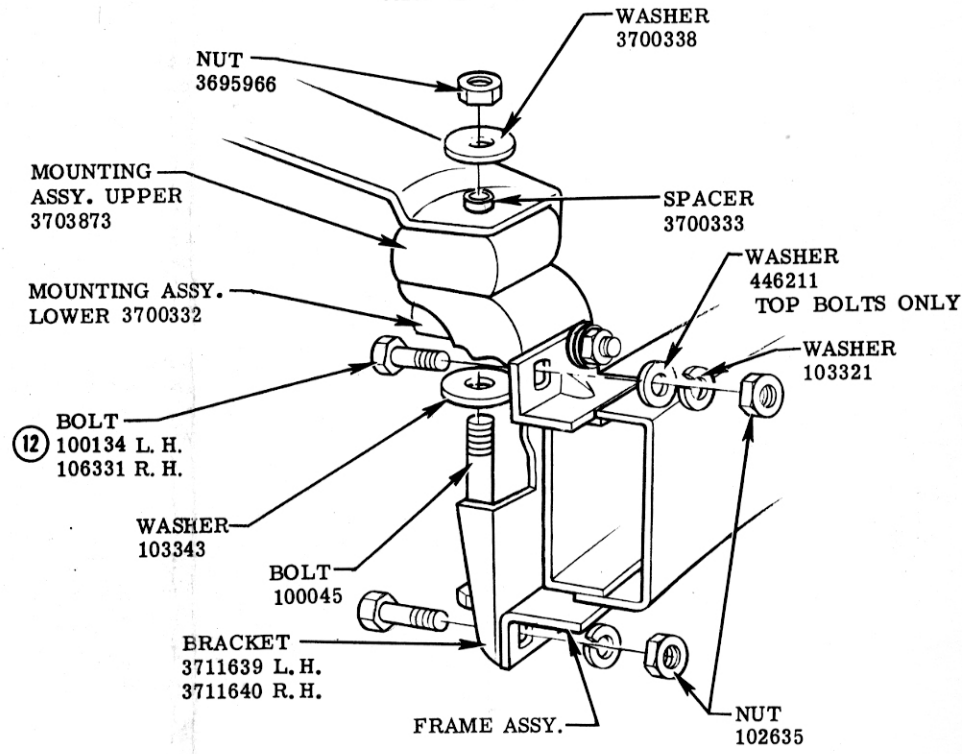

VIEW A

					CORVETTE INSTRUCTION MANUAL					
DATE	SYM.	REVISION RECORD	AUTH.	DR.	CK.	NAME	DRAWN C. C.	CHECKED L. S.	SECT.	SHEET
						F				
		14 WAS 100026								
		13 WAS 103026								
		12 WAS 100026								
11-5-56	11	REDRAWN	3729						6	6.00
						DATE 9-15-55	PART No. 3726900			

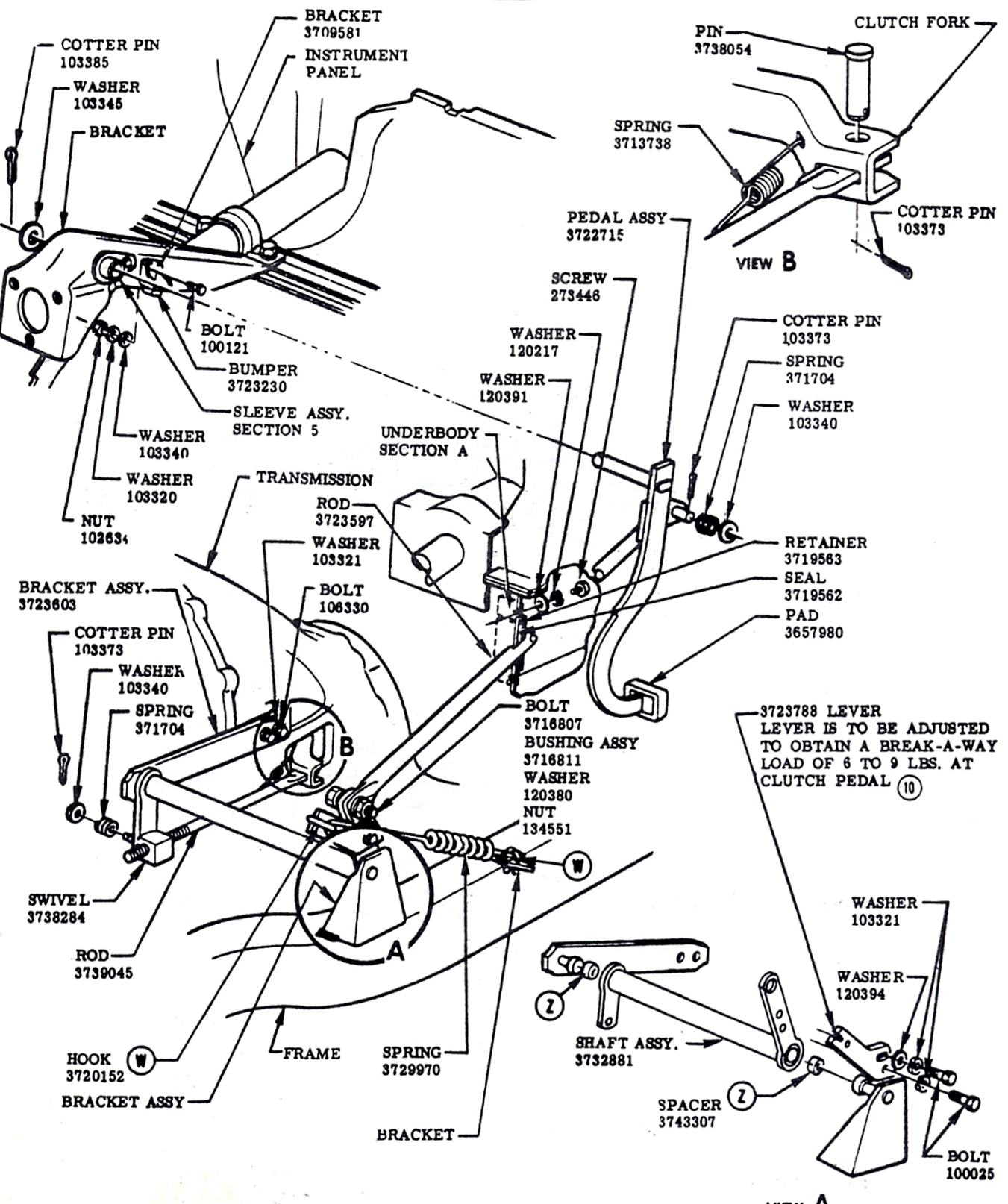

SEE LUBRICATION CHART SECTION 14
CLUTCH

NAME						CORVETTE INSTRUCTION MANUAL					
REF.	DRAWN	CHECKED	SECT.	SHEET							
10		V		6	7.00						
1-21-57	9					DATE	9-15-55	PART No.	3726900		
DATE	SYM.	REVISION RECORD	AUTH.	DR.	CK.						
		NOTE ADDED			F						
		REDRAWN	7131								

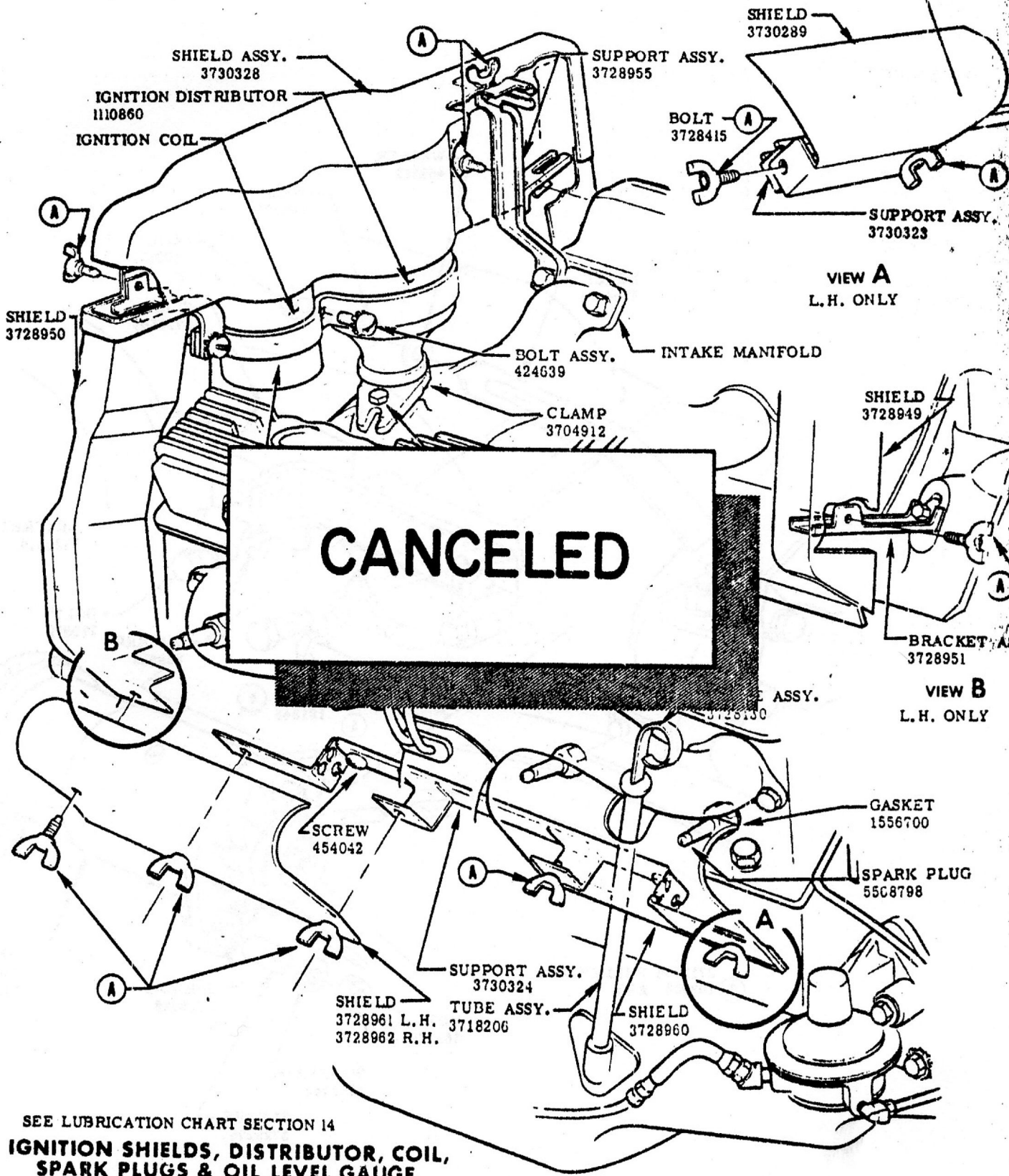

CANCELED

SEE LUBRICATION CHART SECTION 14
**IGNITION SHIELDS, DISTRIBUTOR, COIL,
 SPARK PLUGS & OIL LEVEL GAUGE**

					NAME CORVETTE INSTRUCTION MANUAL				
					REF.	DRAWN W.S.	CHECKED L.S.	SECT.	SHEET
								6	8.00
					DATE 9-15-55	PART No. 3726900			
DATE	SYM.	REVISION RECORD	AUTH.	DR. CK.					
2-2-56		1 SHEET CANCELLED SEE SHEET 4.00		F					

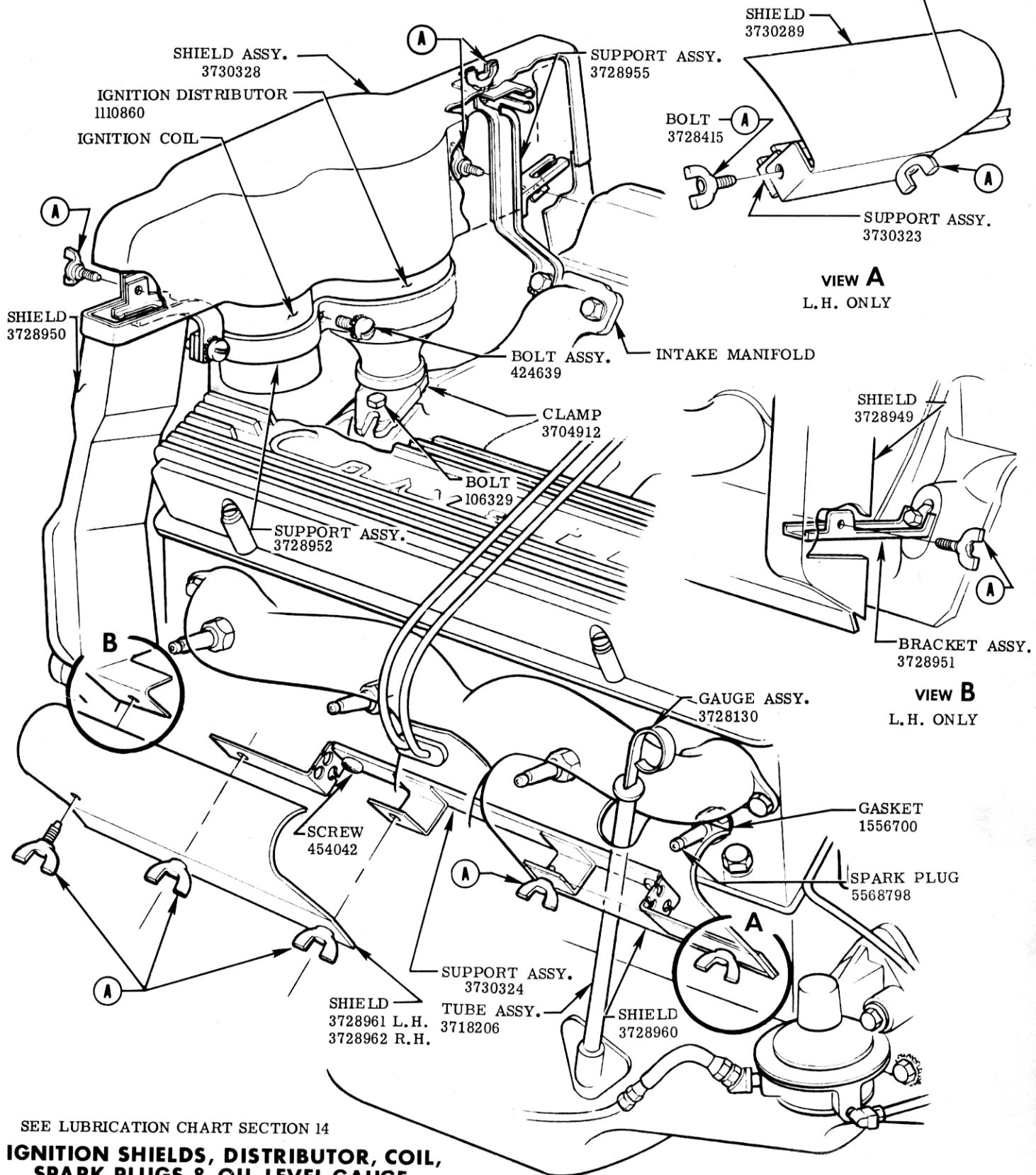

SEE LUBRICATION CHART SECTION 14

**IGNITION SHIELDS, DISTRIBUTOR, COIL,
SPARK PLUGS & OIL LEVEL GAUGE**

						NAME	CORVETTE INSTRUCTION MANUAL			
						REF.	DRAWN W.S.	CHECKED L.S.	SECT.	SHEET
						DATE	PART No.		6	8.00
DATE	SYM.	REVISION RECORD	AUTH.	DR.	CK.	9-15-55	3726900			

Schwartz

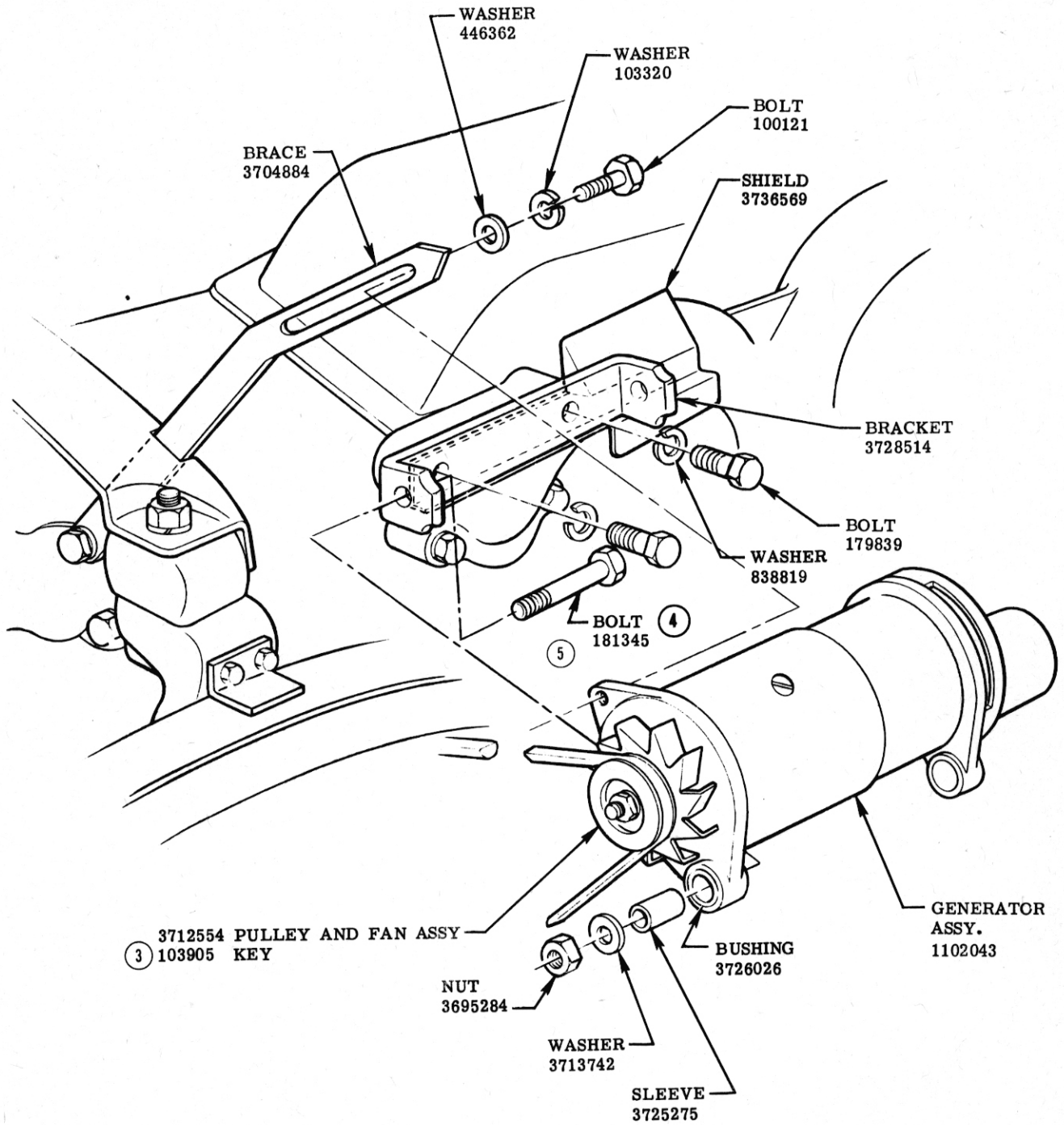

SEE LUBRICATION CHART SECTION 14

GENERATOR

					CORVETTE INSTRUCTION MANUAL					
DATE	SYM.	REVISION RECORD	AUTH.	DR.	CK.	NAME	DRAWN C. C.	CHECKED L. S.	SECT.	SHEET
8-2-57	5	WAS 183147	3064	P	F	REF.				
4-9-57	4	WAS 181345	338	V	F	DATE				
11-5-56	3	103905 KEY ADDED	5325		F	9-15-55	PART No.	3726900	6	9.00
6-4-56	2	REDRAWN & REVISED	1460	V	F					

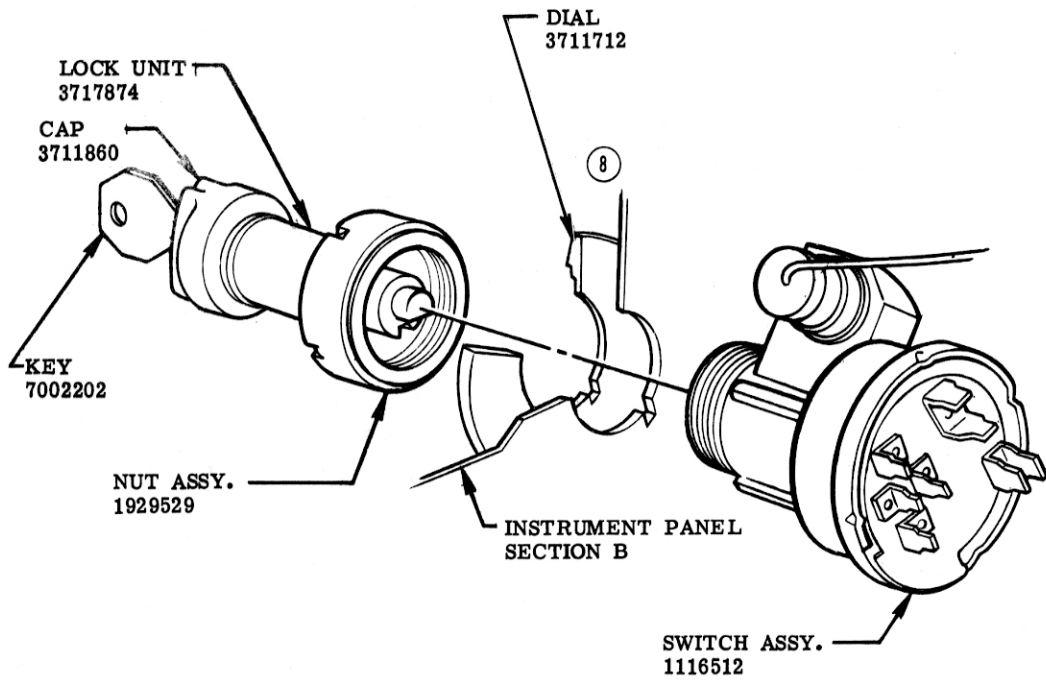
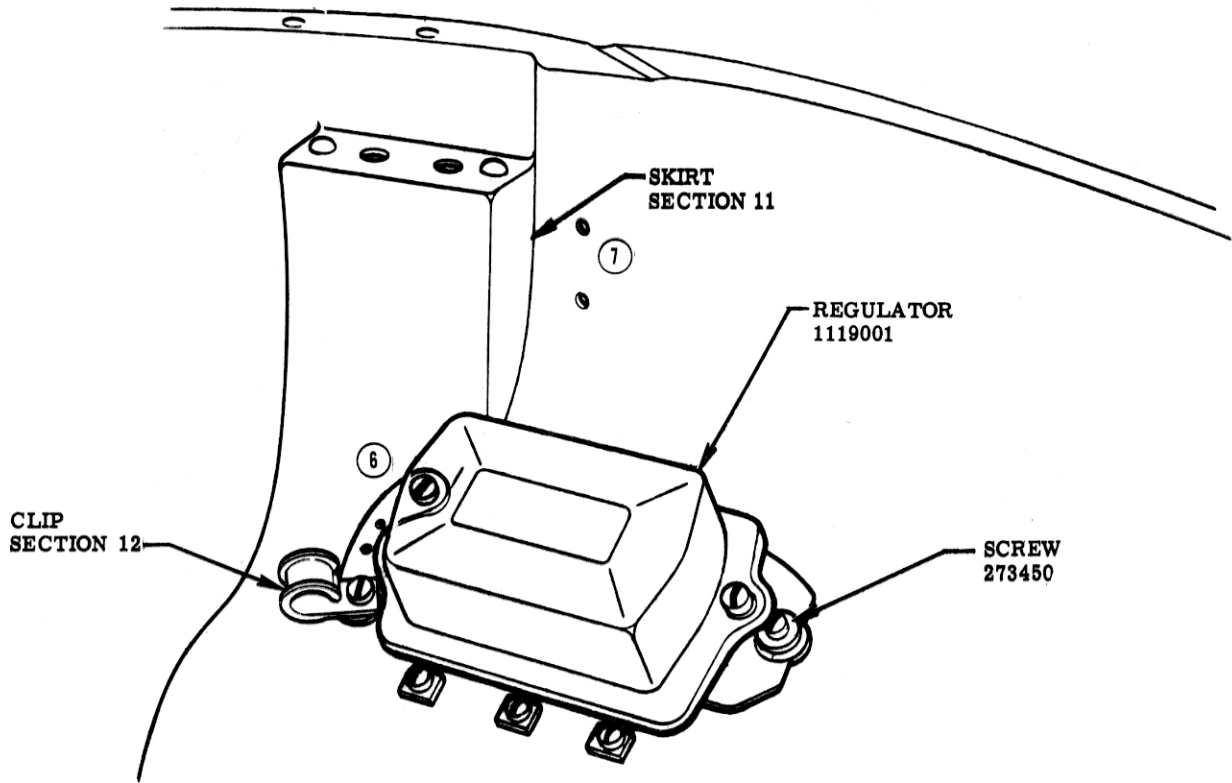

IGNITION SWITCH & VOLTAGE REGULATOR

					NAME CORVETTE INSTRUCTION MANUAL					
8		3711713 BEZEL REMOVED	6620	V	F	REF.	DRAWN O.W.	CHECKED W.M.	SECT.	SHEET
		7 RELAY MTG HOLES ROTATED							6	10.00
		6 CLIP RELOCATED								
1-21-57	5	REDRAWN	6145			DATE 9-15-55	PART No. 3726900			
DATE	SYM.	REVISION RECORD	AUTH.	DR.	CK.					

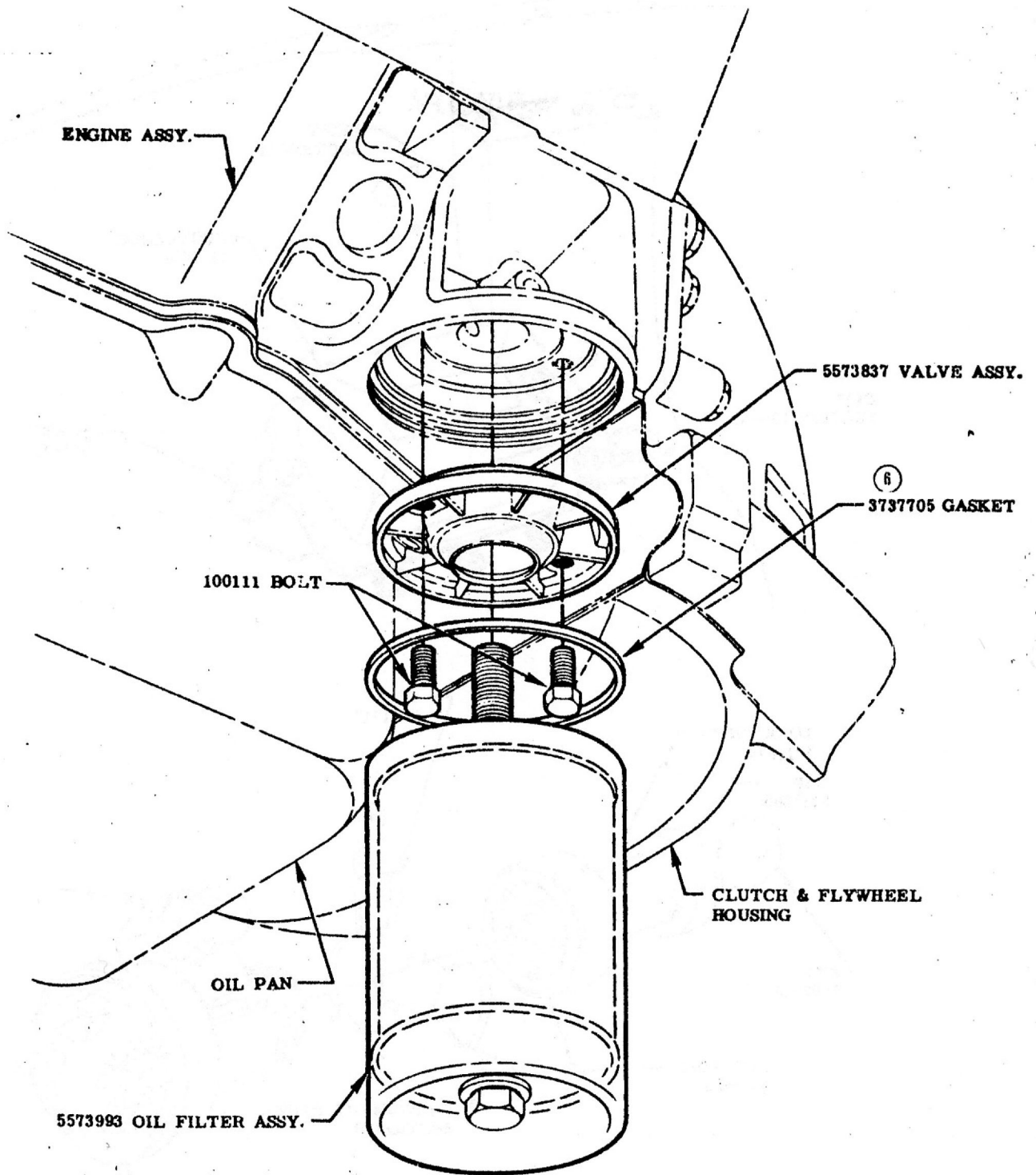

SEE LUBRICATION CHART
SECTION 14

OIL FILTER

					NAME CORVETTE INSTRUCTION MANUAL				
					REF.	DRAWN C. C.	CHECKED W. M.	SECT.	SHEET
5-28-56	6	WAS 5573827	8580	V F	DATE	PART No.	6	11.00	
2-27-56	5	REDRAWN & REVISED	6960	F	9-15-55	3726900			
DATE	SYM.	REVISION RECORD	AUTH.	DR.	CK.				

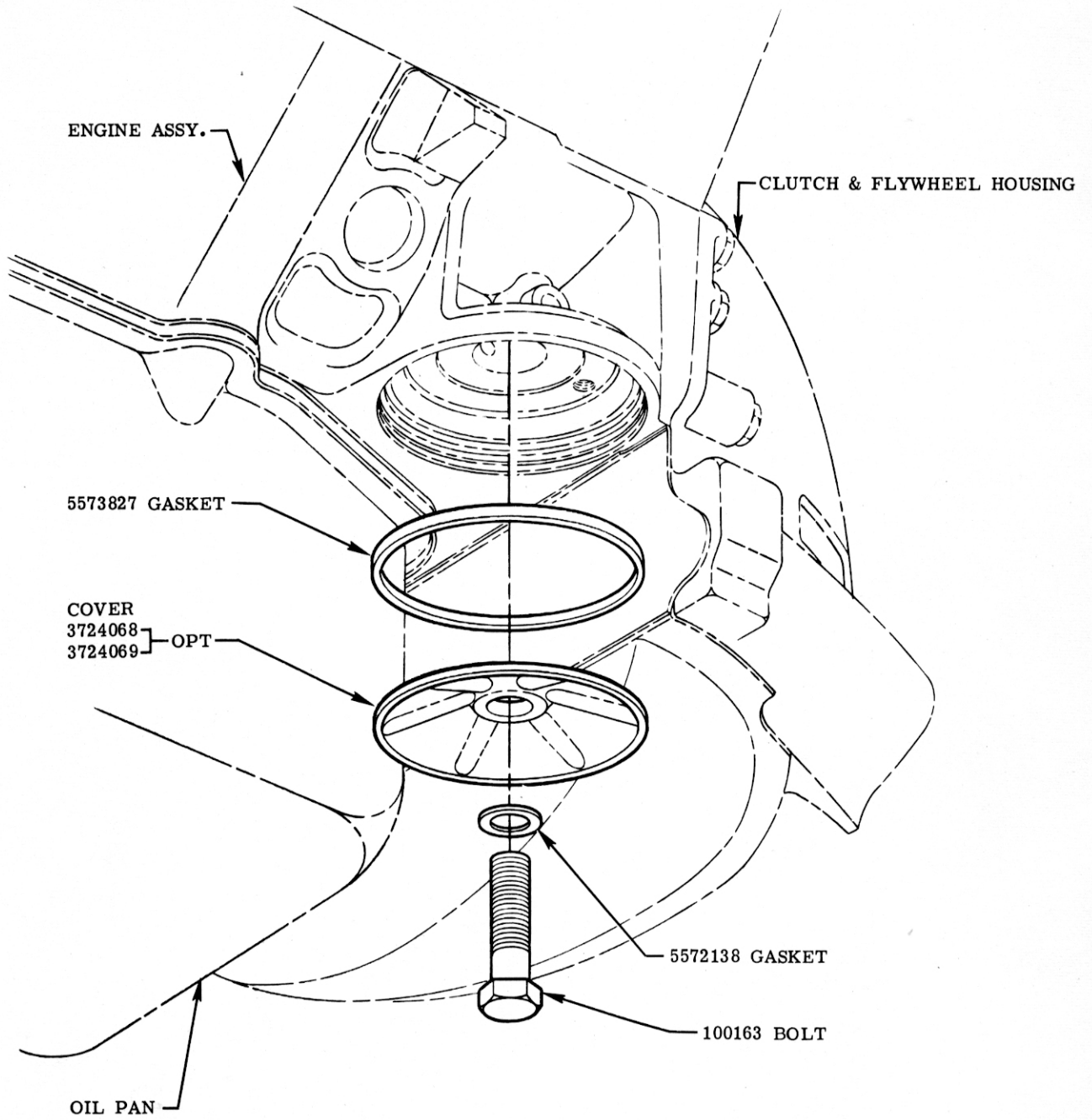

FILTER CAVITY

						NAME	CORVETTE INSTRUCTION MANUAL			
						REF.	DRAWN C. C.	CHECKED W. M.	SECT.	SHEET
						DATE	PART No.		6	11.00
DATE	SYM.	REVISION RECORD	AUTH.	DR.	CK.	9-15-55	3726900			

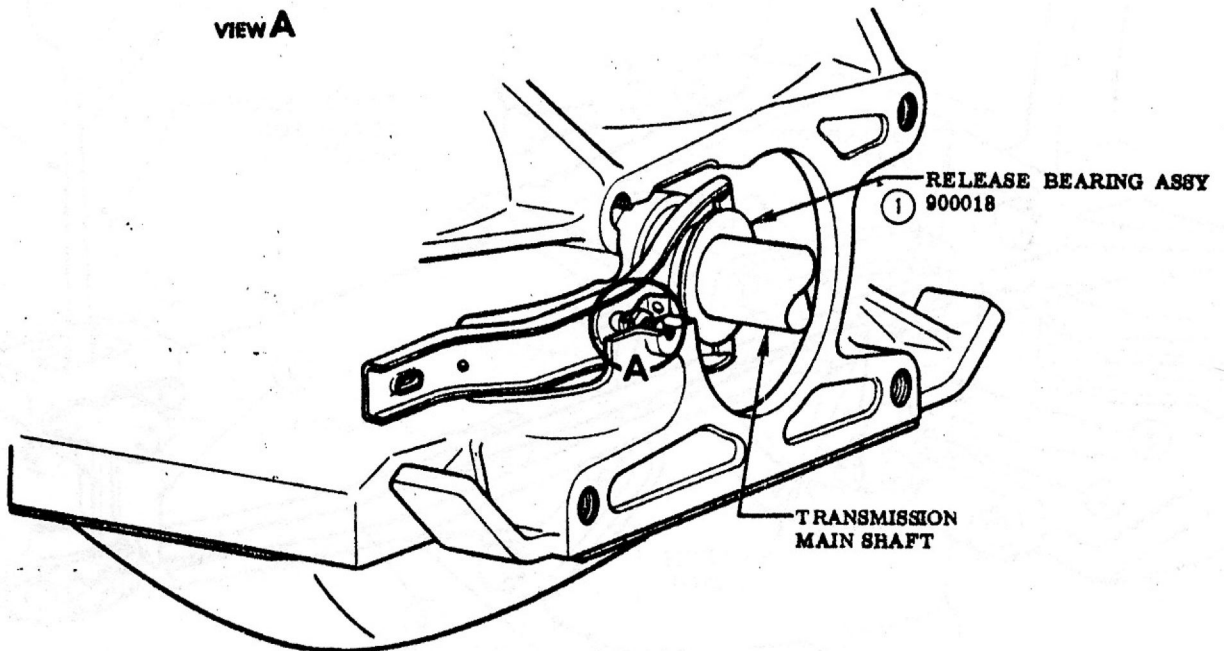
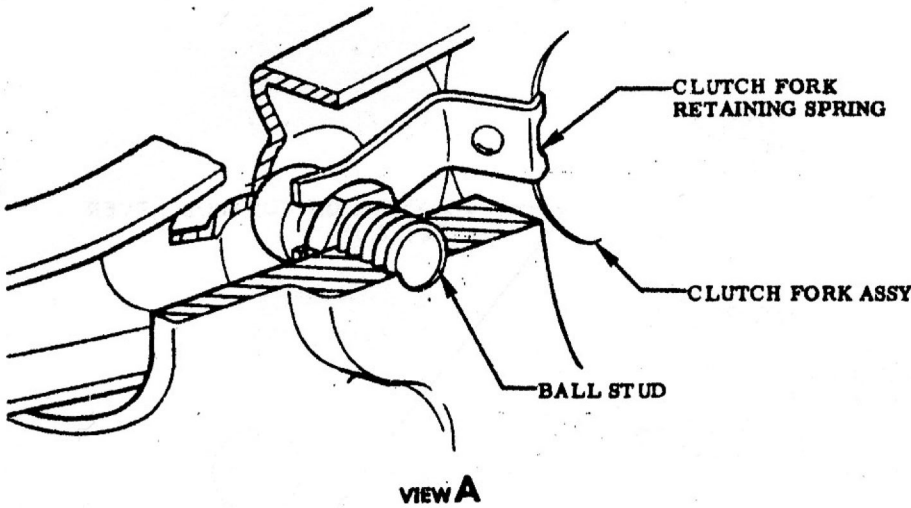

BRUSH A UNIFORM LAYER OF LUBRICANT TO THESE SURFACES FOR FULL CIRCUMFERENCE

FILL THIS GROOVE WITH LUBRICANT FOR FULL CIRCUMFERENCE. APPLY WITH SPECIAL GUN

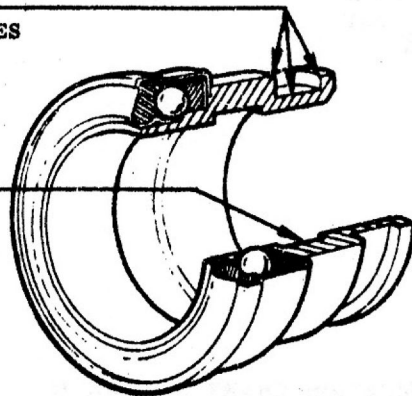

SEE LUBRICATION CHART SECTION 14
CLUTCH RELEASE BEARING

						NAME	CORVETTE INSTRUCTION MANUAL				
						REF.	DRAWN	CHECKED	SECT.	SHEET	
								L. B.	6	12.00	
1-30-54	1	WAS 3724507			F	DATE	PART No.				
DATE	SYM.	REVISION RECORD	AUTH.	DR.	CK.	9-15-55	3726900				

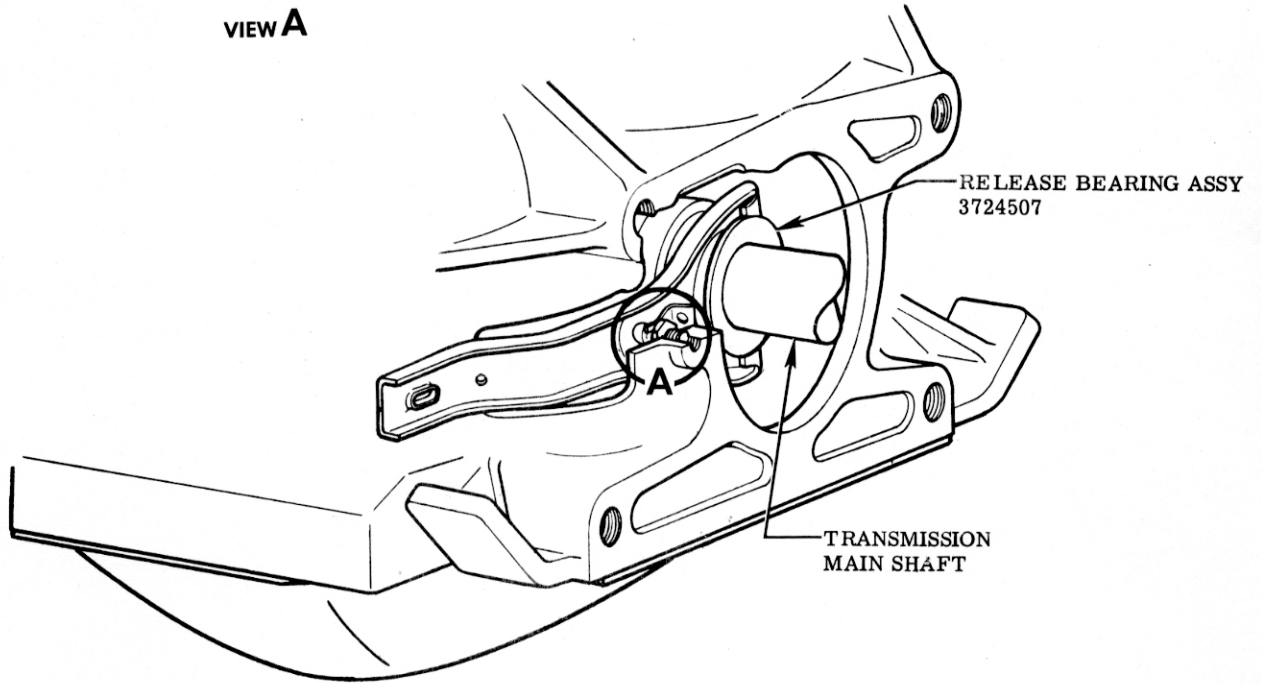
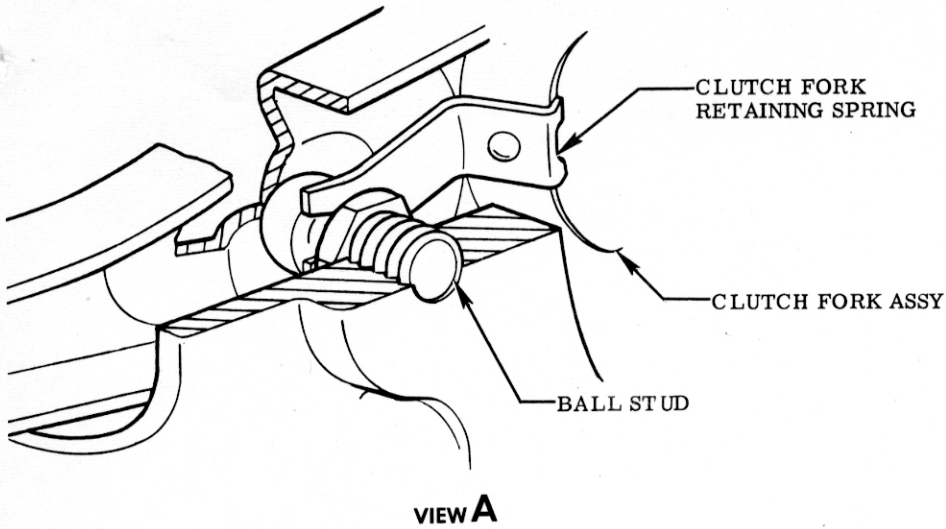

BRUSH A UNIFORM LAYER OF LUBRICANT TO THESE SURFACES FOR FULL CIRCUMFERENCE

FILL THIS GROOVE WITH LUBRICANT FOR FULL CIRCUMFERENCE. APPLY WITH SPECIAL GUN

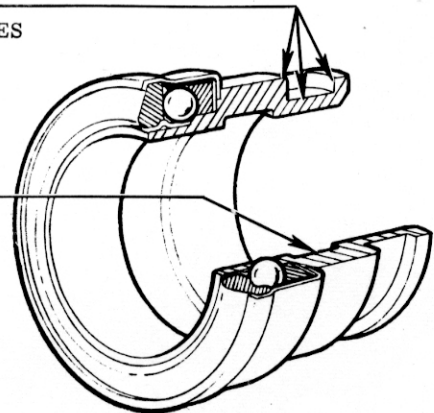

SEE LUBRICATION CHART SECTION 14

CLUTCH RELEASE BEARING

						NAME CORVETTE INSTRUCTION MANUAL				
						REF.	DRAWN	CHECKED L. S.	SECT.	SHEET
						DATE 9-15-55	PART No. 3726900		6	12.00
DATE	SYM.	REVISION RECORD	AUTH.	DR.	CK.					