

WAXMILLER & COMPANY

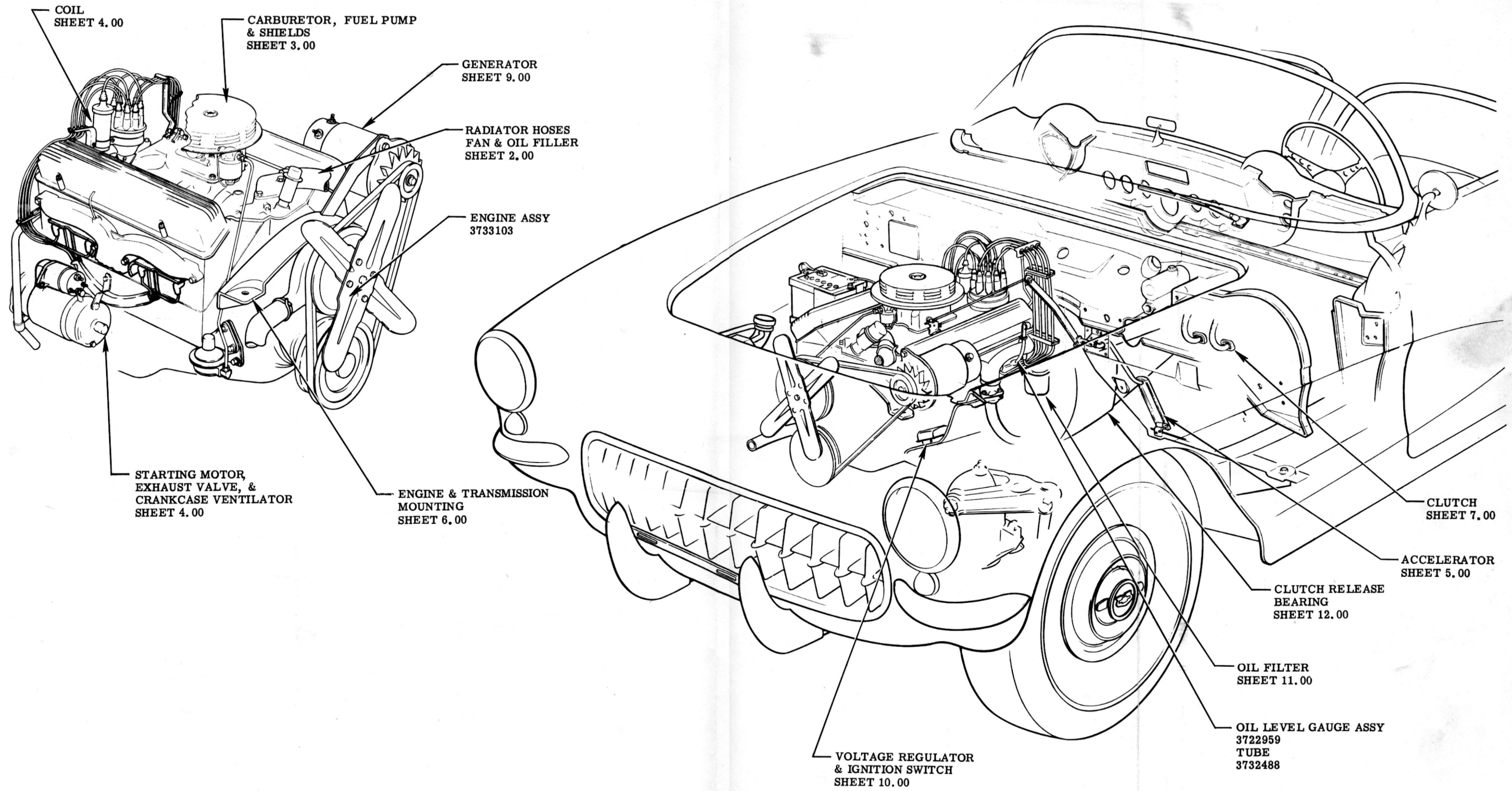

SEE LUBRICATION CHART SECTION 14
ENGINE

							NAME CORVETTE INSTRUCTION MANUAL			
REF.	DRAWN	CHECKED	SECT.	SHEET			W.S.	L.S.		
7-31-56	4	REDRAWN & REVISED FOR 57	8010	F	DATE	9-15-55	PART No.	3726900	6	1.00
DATE	SYM.	REVISION RECORD	AUTH.	DR.	CK.					

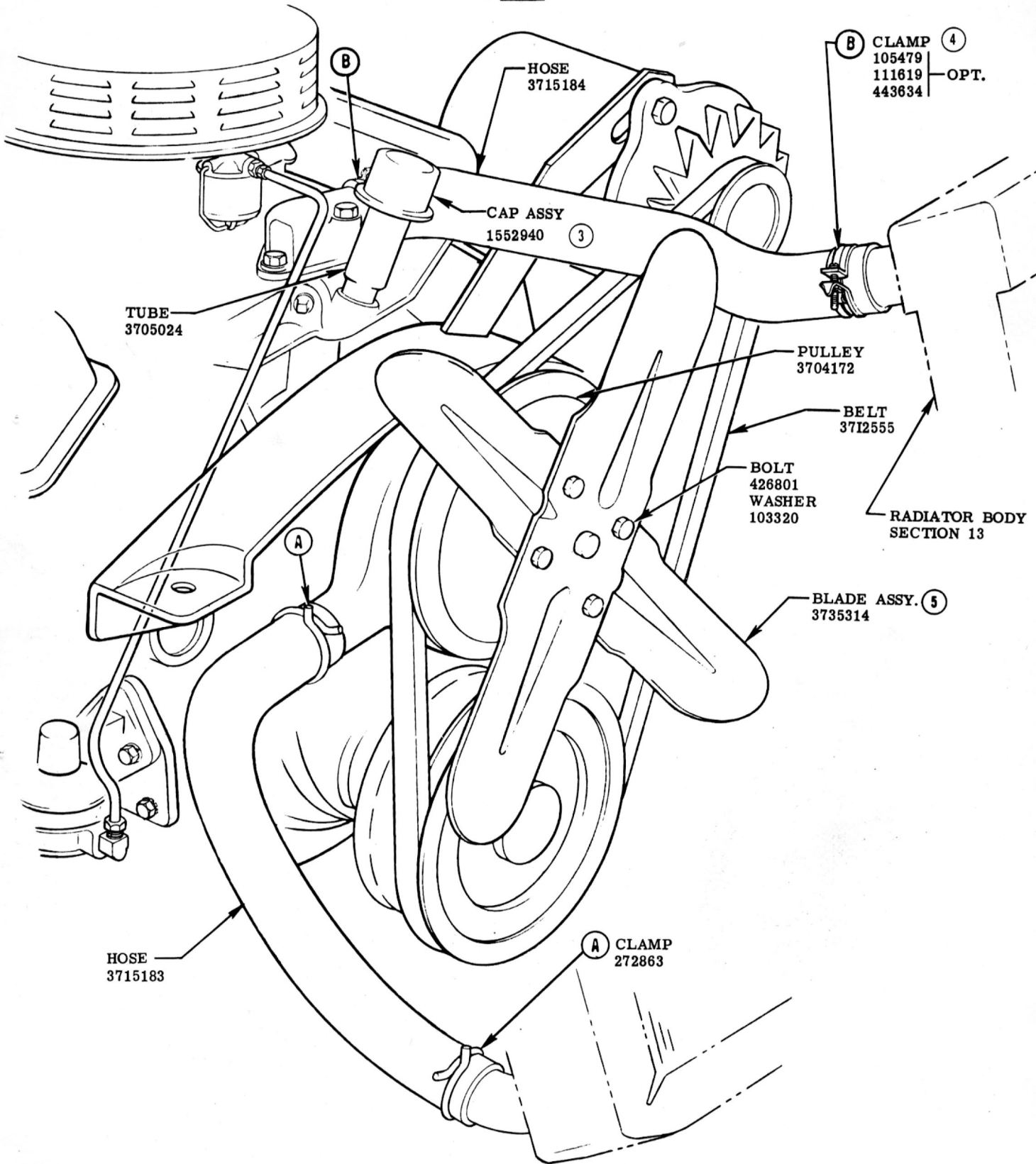

SEE LUBRICATION CHART SECTION 14
RADIATOR HOSES, FAN & OIL FILLER

						CORVETTE INSTRUCTION MANUAL				
DATE	SYM.	REVISION RECORD	AUTH.	DR.	CK.	REF.	DRAWN W.S.	CHECKED L.S.	SECT.	SHEET
2-27-57	5	WAS 3704803			F				6	2.00
11-26-56	4	WAS 272861		170	F					
7-16-56	3	WAS 1552719		2116	V F					
5-28-56	2	REDRAWN & REVISED		8242	V F					
						DATE	PART No.			
						9-15-55	3726900			

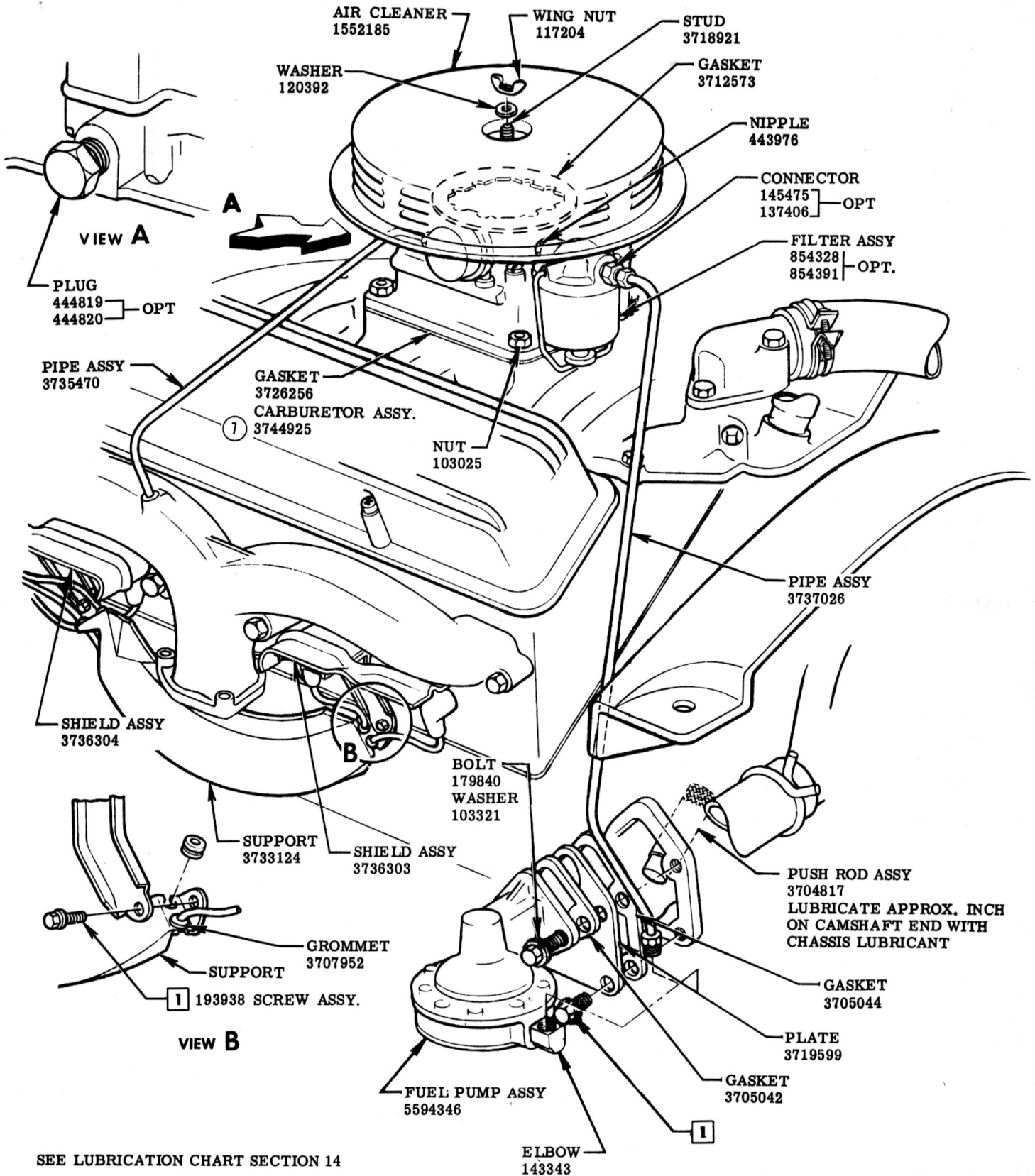

SEE LUBRICATION CHART SECTION 14

CARBURETOR, FUEL PUMP & SHIELD

					CORVETTE INSTRUCTION MANUAL				
REF.	DATE	SYM.	AUTH.	DR.	NAME	DRAWN	CHECKED	SECT.	SHEET
7									
1-7-57	6		6073					6	3.00
DATE	SYM.	REVISION RECORD	AUTH.	DR.	CK.	DATE	PART No.		
						9-15-55	3726900		

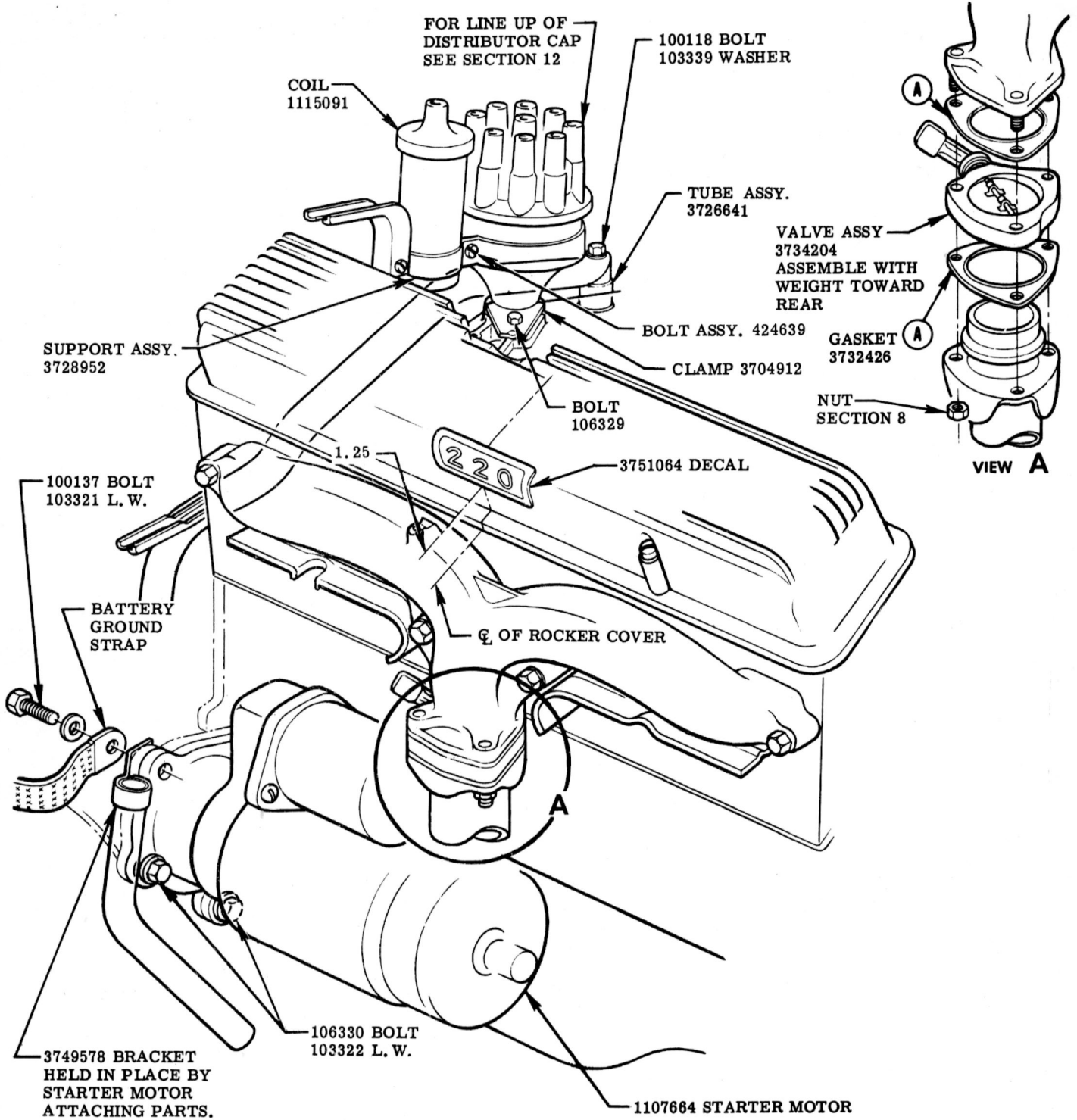

**STARTING MOTOR, EXHAUST VALVE,
CRANKCASE VENTILATOR, & COIL**

							NAME	CORVETTE INSTRUCTION MANUAL			
							REF.	DRAWN W. S.	CHECKED L. S.	SECT.	SHEET
7-25-57	5	REDRAWN & REVISED	700	606	V	F	DATE	PART No.	3726900	6	4.00
DATE	SYM.	REVISION RECORD		AUTH.	DR.	CK.	9-15-55				

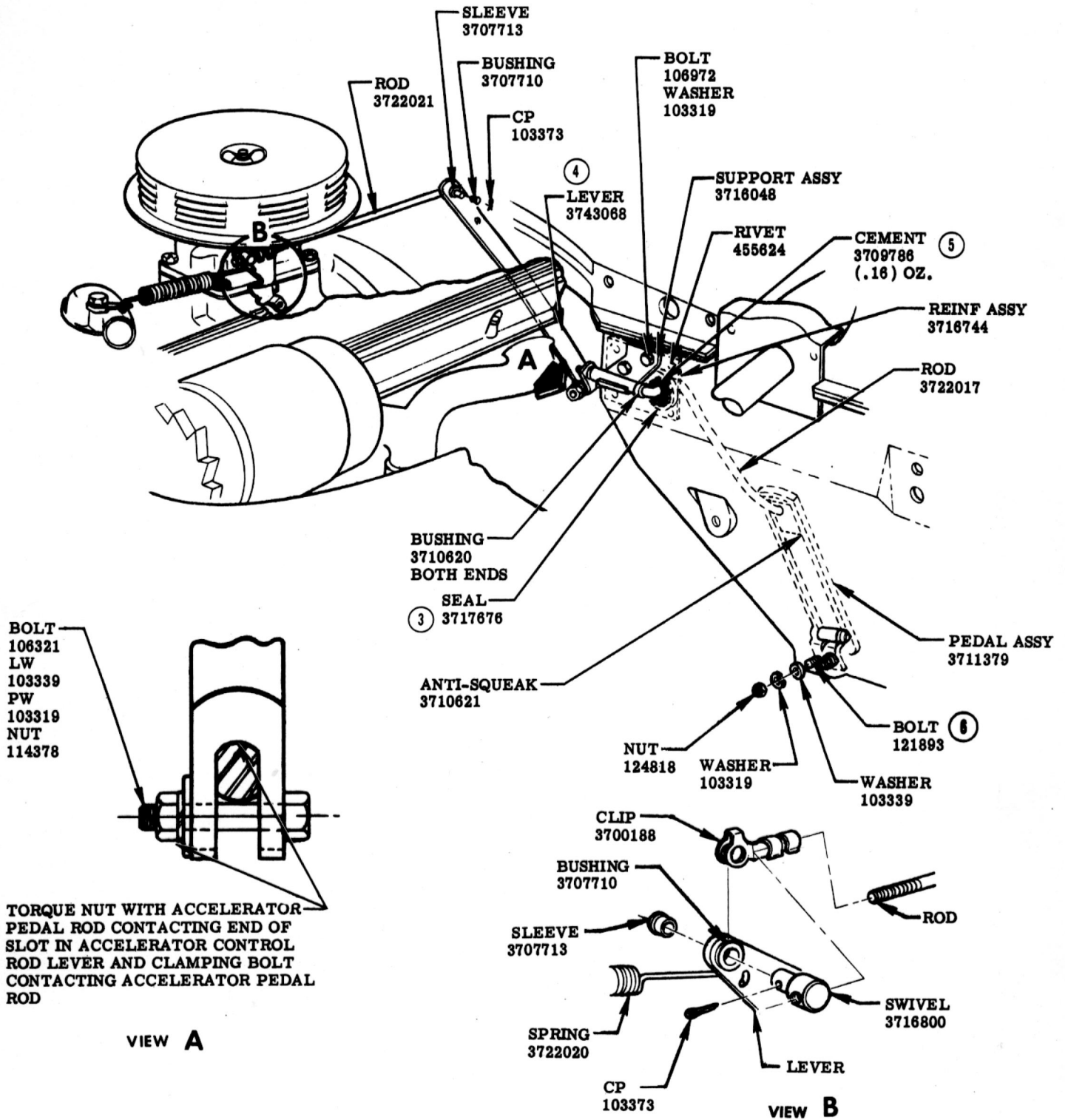

SEE LUBRICATION CHART SECTION 14

ACCELERATOR

DATE	SYM.	REVISION RECORD	AUTH.	DR.	CK.	NAME	REF.	DRAWN	CHECKED	SECT.	SHEET
4-9-57	6	WAS 106972	489	V	F	CORVETTE INSTRUCTION MANUAL					
	5	PART ADDED	4059		F						
11-13-56	4	WAS 3722018	4139	V							
7-16-56	3	WAS 3717576 IN ERROR			F			O. W.	L. S.		
5-28-56	2	REDRAWN & REVISED	8242	V	F					6	5.00
						DATE	9-15-55	PART No	3726900		

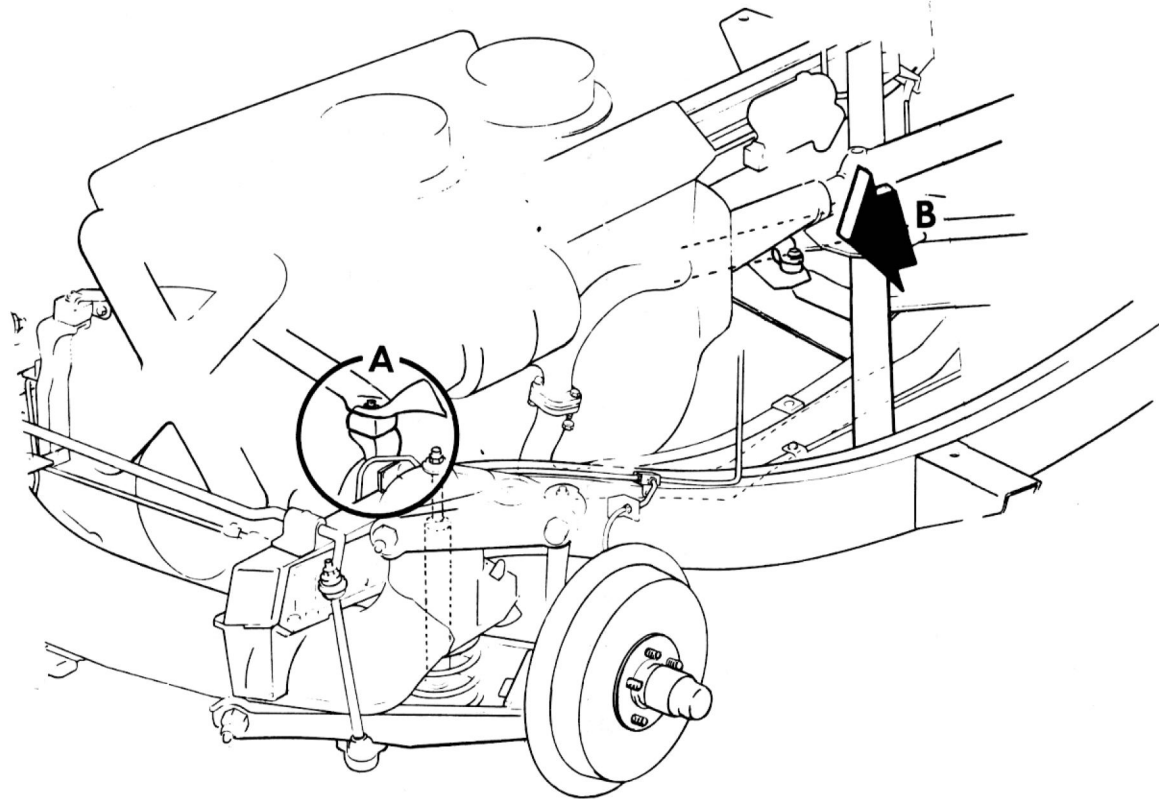

SUGGESTED ENGINE MOUNTING PROCEDURE

With engine positioned in chassis, the rubber cushions at both sides of the engine and at the transmission must not be distorted or cramped. To accomplish this objective the following assembly procedure is suggested.

1. Prior to Assembling engine in chassis:

Right & left hand engine front mountings, are to be assembled on engine with the mounting bolt nuts loose (engaged only 2 or 3 turns). Transmission support & cross-member assembly is to be assembled to center crossmember-leave bolts loose.

2. Assembly to chassis:

The distance between frame bracket upper supports is to be measured, and the number of shims required indicated on the right hand side member. Lower engine on combination locator & jack which locates the engine central in the frame and fore & aft by locating from the gauge holes in the top of frame side members to front face of engine.

3. After assembling engine in chassis:

Tighten two lower L.H. frame bracket bolts. Tighten two upper L.H. frame bracket bolts. Insert shims on R.H. side as indicated on side member. Tighten two lower R.H. frame bracket bolts. Tighten two upper R.H. frame bracket bolts. Remove engine from locator and jack. (Weight of engine is now on front & rear mounts). Tighten R.H. mounting bolt nut to specified torque. Tighten the 4 transmission support crossmember bolts. Shake engine (to relieve strain on mounts). Tighten L.H. mounting bolt nut to torque specified.

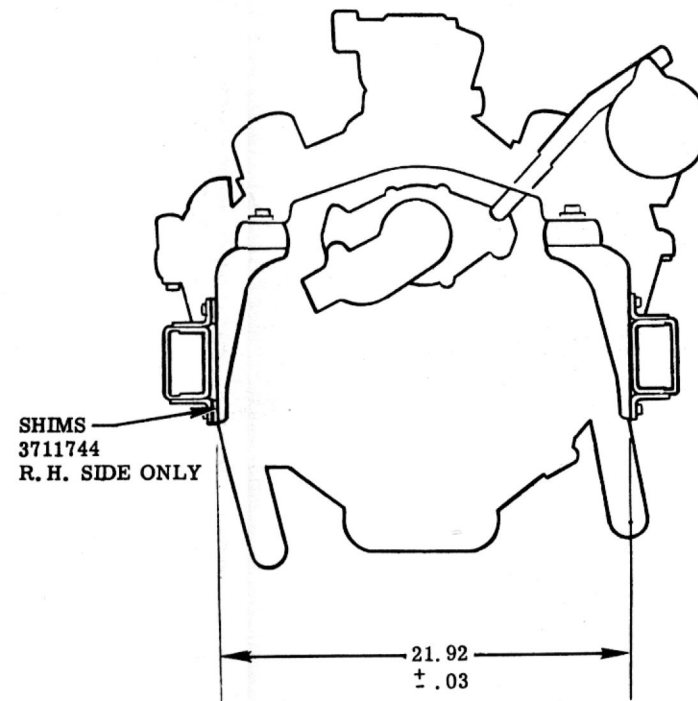

SHIMS
3711744
R. H. SIDE ONLY

21.92
± .03

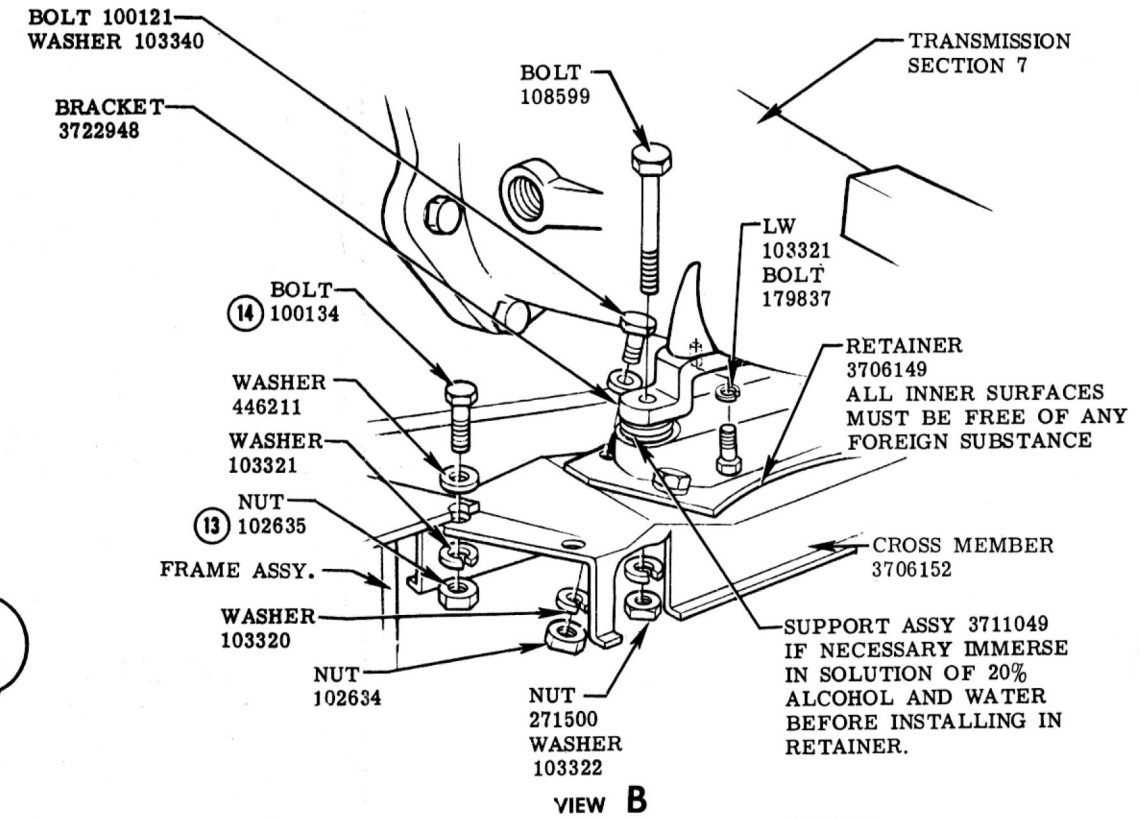

BOLT 100121
WASHER 103340

BRACKET
3722948

BOLT
108599

TRANSMISSION
SECTION 7

LW
103321
BOLT
179837

(14) BOLT
100134

WASHER
446211

WASHER
103321

(13) NUT
102635

FRAME ASSY.

WASHER
103320

NUT
102634

NUT
271500
WASHER
103322

RETAINER
3706149
ALL INNER SURFACES
MUST BE FREE OF ANY
FOREIGN SUBSTANCE

CROSS MEMBER
3706152

SUPPORT ASSY 3711049
IF NECESSARY IMMERSE
IN SOLUTION OF 20%
ALCOHOL AND WATER
BEFORE INSTALLING IN
RETAINER.

VIEW B

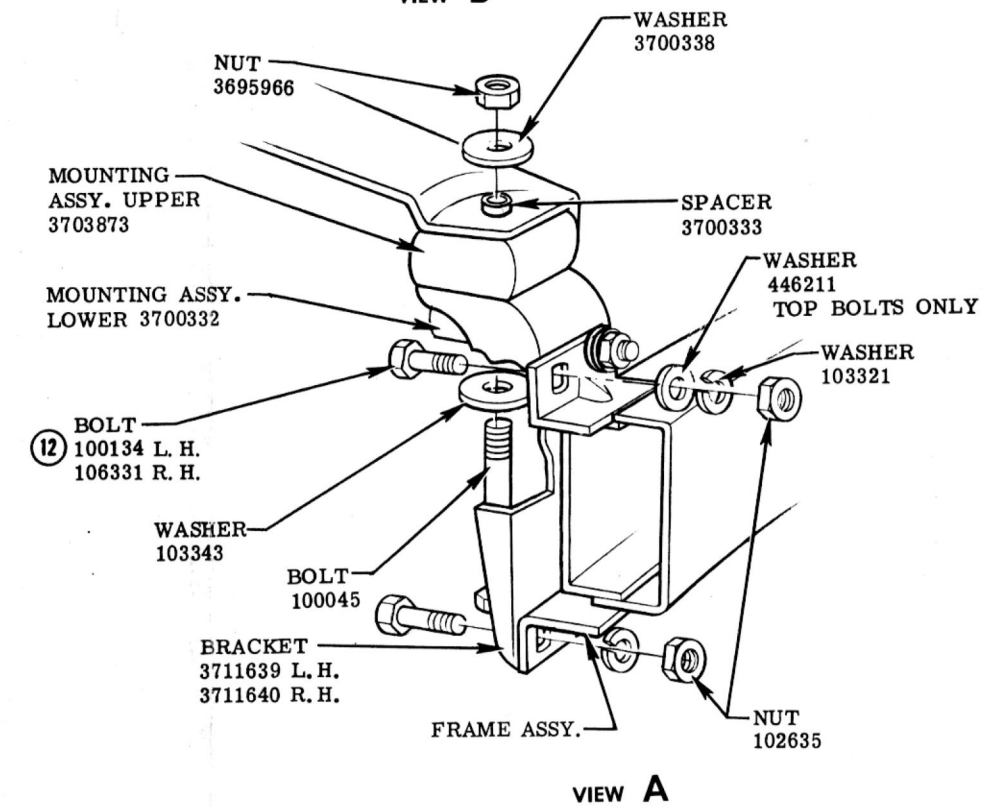

NUT
3695966

WASHER
3700338

MOUNTING
ASSY. UPPER
3703873

SPACER
3700333

MOUNTING ASSY.
LOWER 3700332

WASHER
446211
TOP BOLTS ONLY

WASHER
103321

(12) BOLT
100134 L. H.
106331 R. H.

WASHER
103343

BOLT
100045

BRACKET
3711639 L.H.
3711640 R.H.

FRAME ASSY.

NUT
102635

VIEW A

REVISION RECORD					CORVETTE INSTRUCTION MANUAL					
DATE	SYM.	REVISION	AUTH.	DR.	CK.	NAME	DRAWN C. C.	CHECKED L. S.	SECT.	SHEET
		14	WAS 100026			F				
		13	WAS 103026							
		12	WAS 100026							
11-5-56		11	REDRAWN		3729					
						DATE	PART No.		6	6.00
						9-15-55	3726900			

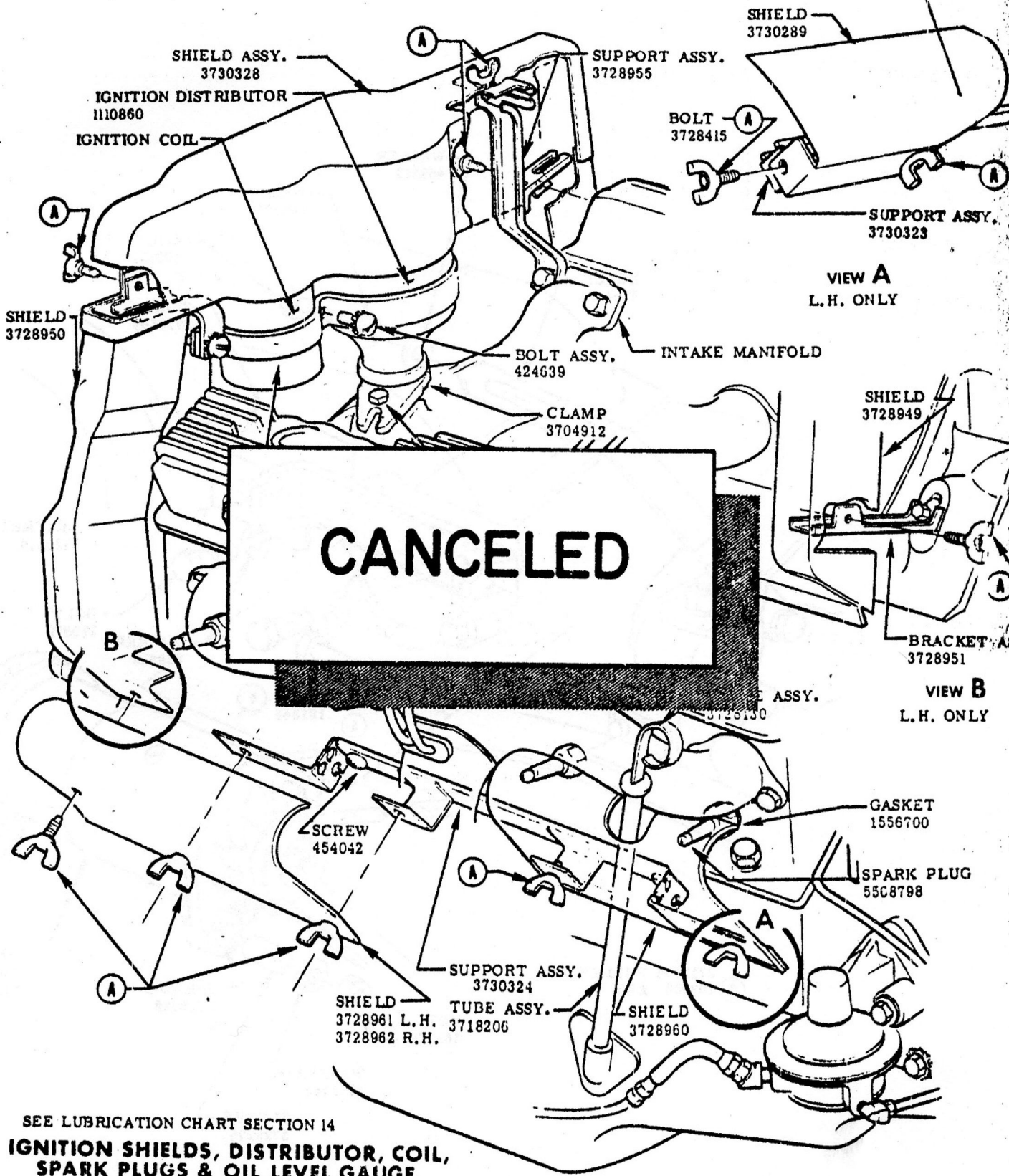

SEE LUBRICATION CHART SECTION 14
**IGNITION SHIELDS, DISTRIBUTOR, COIL,
 SPARK PLUGS & OIL LEVEL GAUGE**

					NAME CORVETTE INSTRUCTION MANUAL				
					REF.	DRAWN W.S.	CHECKED L.S.	SECT.	SHEET
1 SHEET CANCELLED					F				
2-2-56 SEE SHEET 4.00									
DATE	SYM.	REVISION RECORD	AUTH.	DR.	CK.	DATE 9-15-55	PART No. 3726900	6	8.00

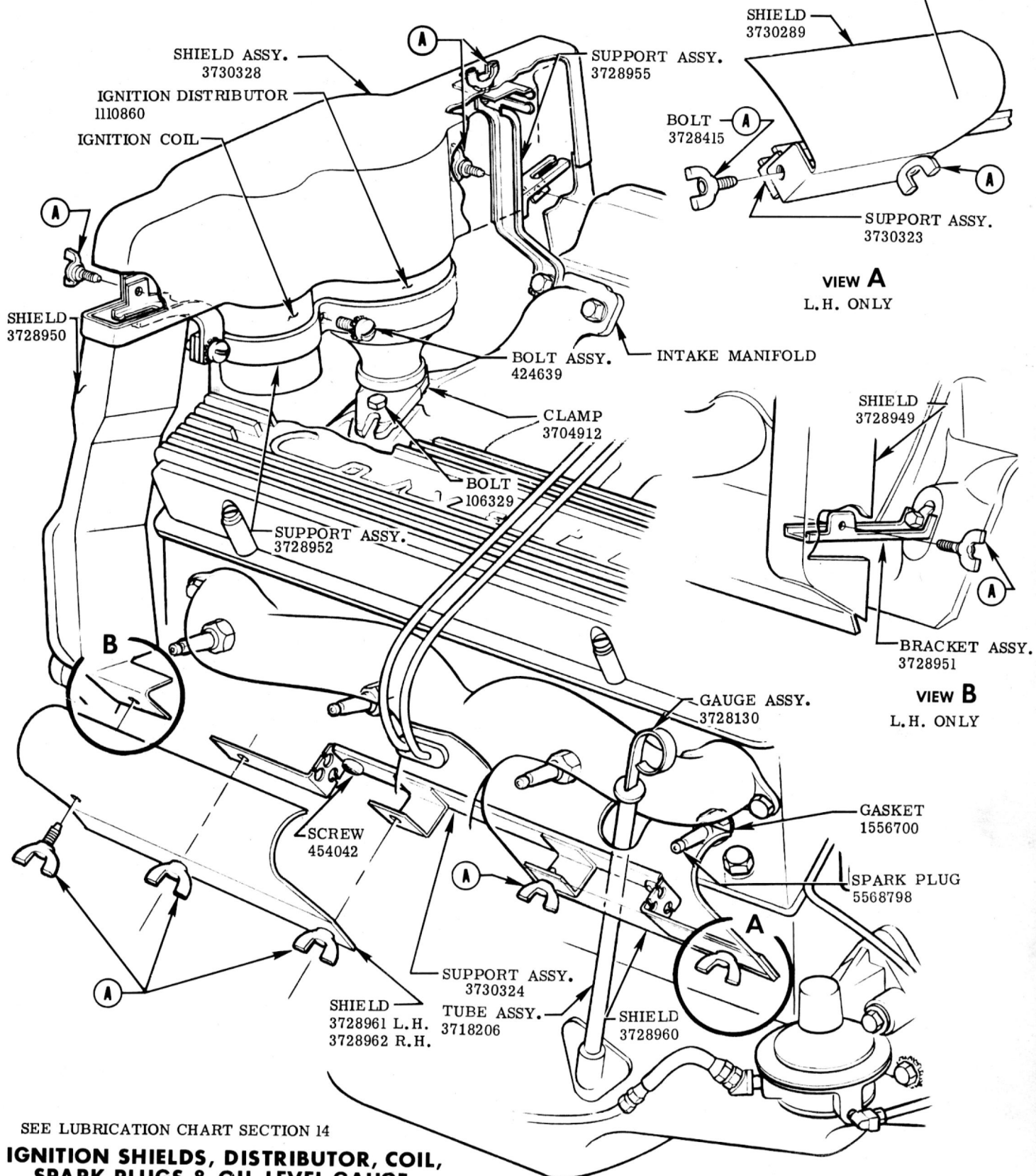

SEE LUBRICATION CHART SECTION 14

**IGNITION SHIELDS, DISTRIBUTOR, COIL,
SPARK PLUGS & OIL LEVEL GAUGE**

					NAME CORVETTE INSTRUCTION MANUAL				
					REF.	DRAWN W.S.	CHECKED L.S.	SECT.	SHEET
					DATE	PART No.		6	8.00
DATE	SYM.	REVISION RECORD	AUTH.	DR. CK.	9-15-55	3726900			

Schwartz

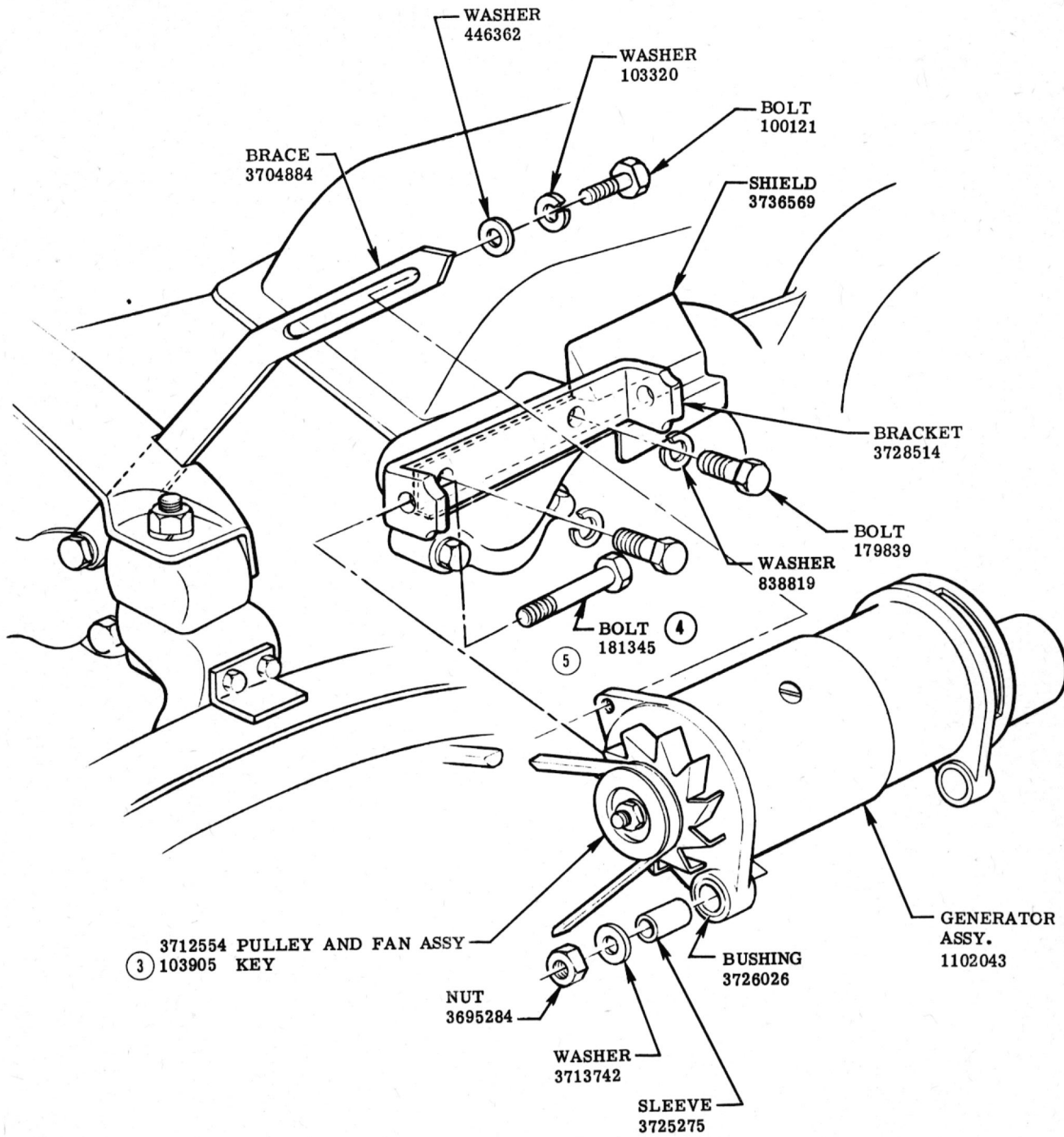

SEE LUBRICATION CHART SECTION 14

GENERATOR

					CORVETTE INSTRUCTION MANUAL					
DATE	SYM.	REVISION RECORD	AUTH.	DR.	CK.	REF.	DRAWN C. C.	CHECKED L. S.	SECT.	SHEET
8-2-57	5	WAS 183147	3064	P	F					
4-9-57	4	WAS 181345	338	V	F					
11-5-56	3	103905 KEY ADDED	5325		F					
6-4-56	2	REDRAWN & REVISED	1460	V	F					
REVISION RECORD						DATE 9-15-55	PART No. 3726900		6	9.00

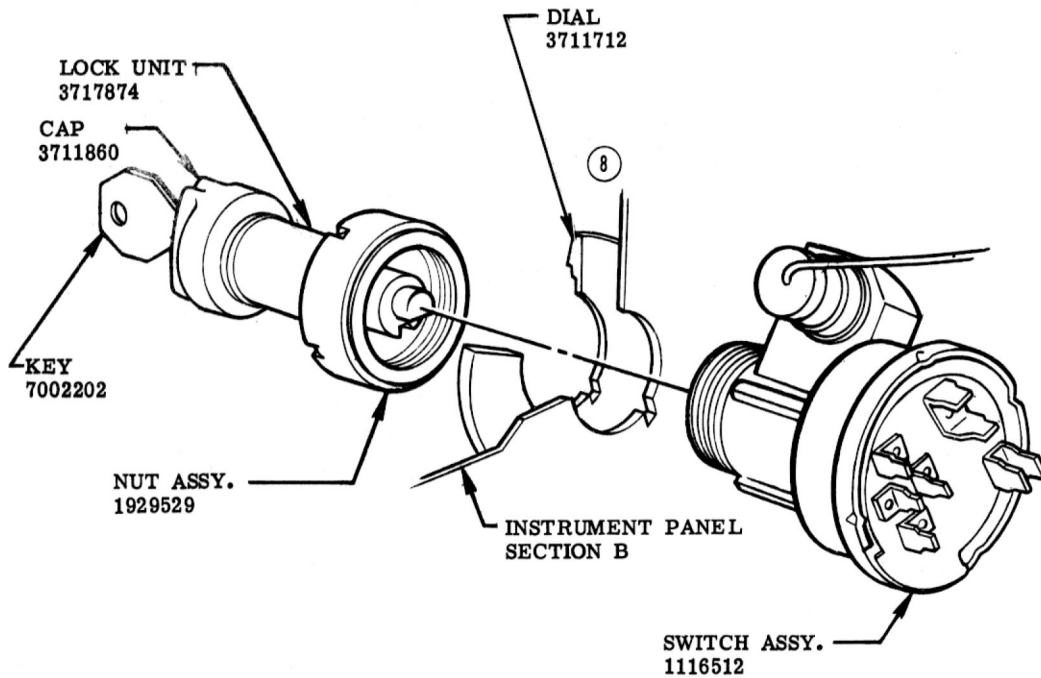
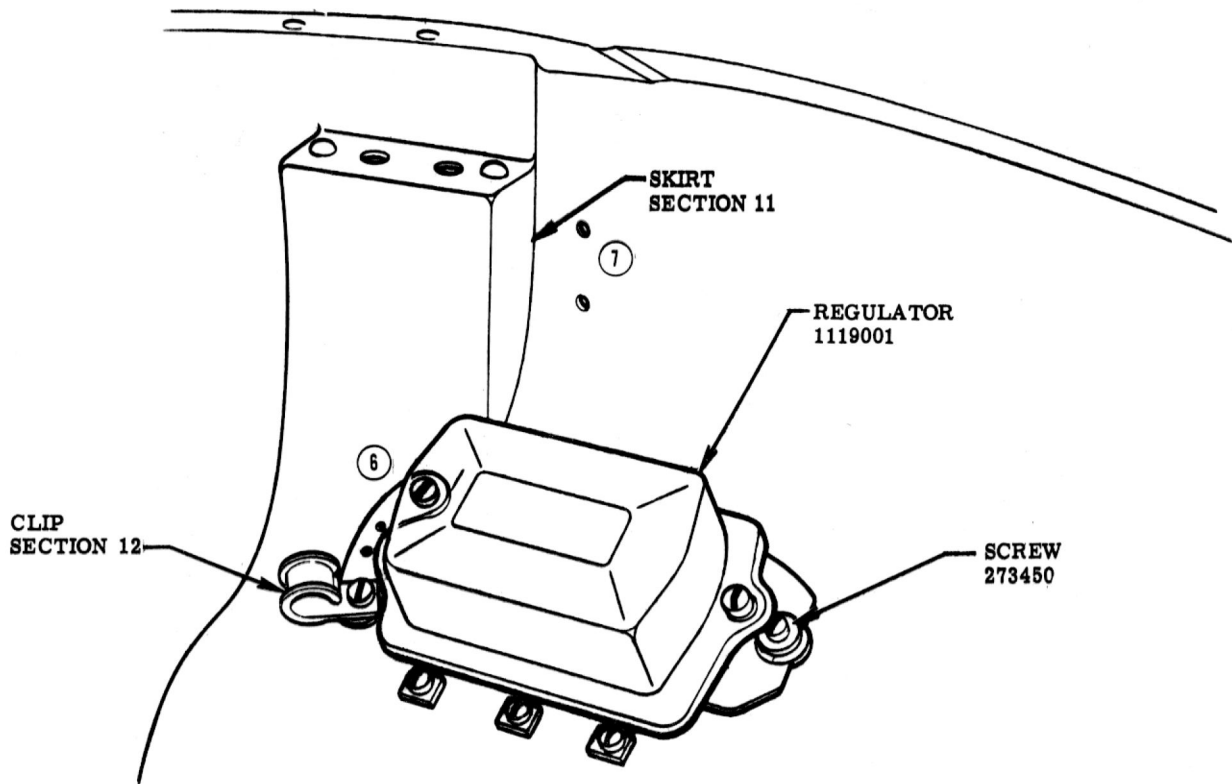

IGNITION SWITCH & VOLTAGE REGULATOR

REVISION RECORD				CORVETTE INSTRUCTION MANUAL						
8		3711713 BEZEL REMOVED	6620	V	F	REF.	DRAWN O. W.	CHECKED W. M.	SECT.	SHEET
7		RELAY MTG HOLES ROTATED				DATE			6	10.00
6		CLIP RELOCATED				9-15-55	PART No. 3726900			
1-21-57	5	REDRAWN	6145							
DATE	SYM.	REVISION RECORD	AUTH.	DR.	CK.					

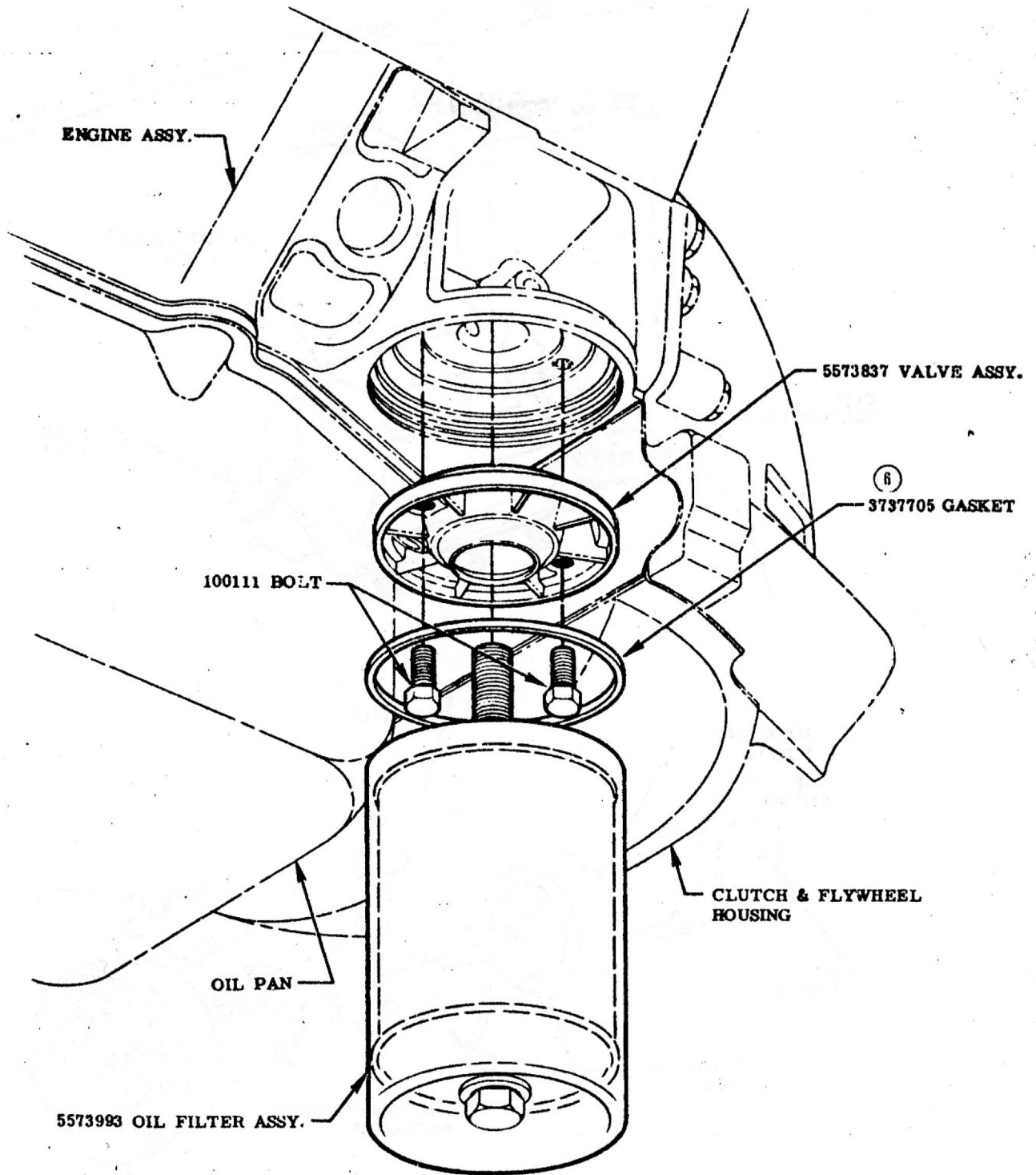

SEE LUBRICATION CHART
SECTION 14

OIL FILTER

					NAME CORVETTE INSTRUCTION MANUAL				
					REF.	DRAWN C. C.	CHECKED W. M.	SECT.	SHEET
5-28-56	6	WAS 5573827	8580	V F	DATE	PART No.	6	11.00	
2-27-56	5	REDRAWN & REVISED	6960	F	9-15-55	3726900			
DATE	SYM.	REVISION RECORD	AUTH.	DR.	CK.				

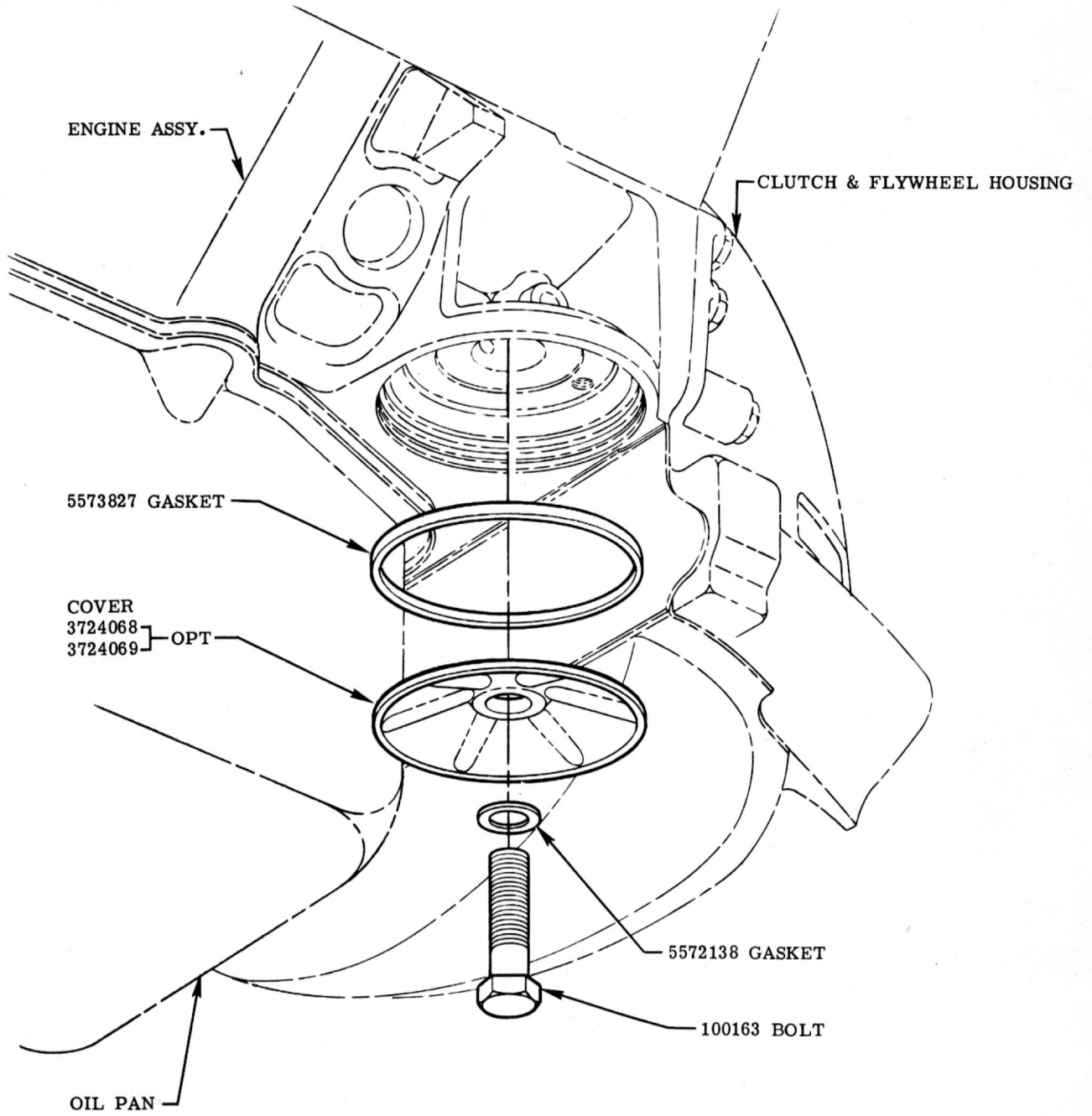

FILTER CAVITY

						NAME	CORVETTE INSTRUCTION MANUAL			
						REF.	DRAWN C.C.	CHECKED W.M.	SECT.	SHEET
						DATE	PART No.		6	11.00
DATE	SYM.	REVISION RECORD	AUTH.	DR.	CK.	9-15-55	3726900			

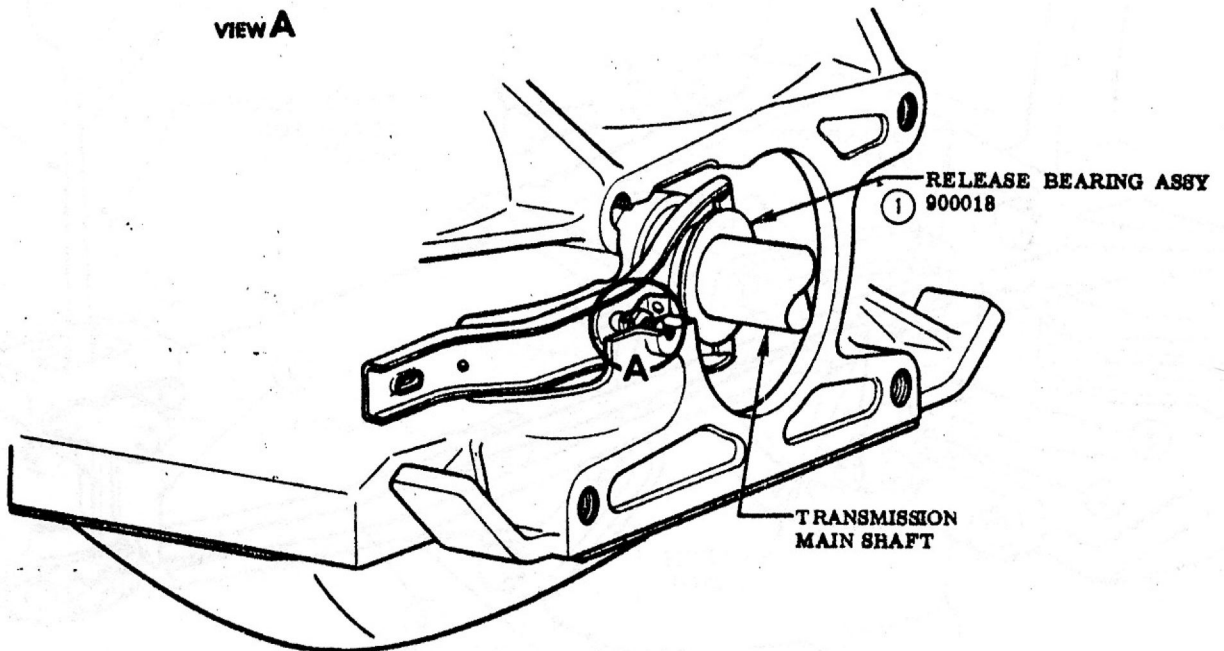
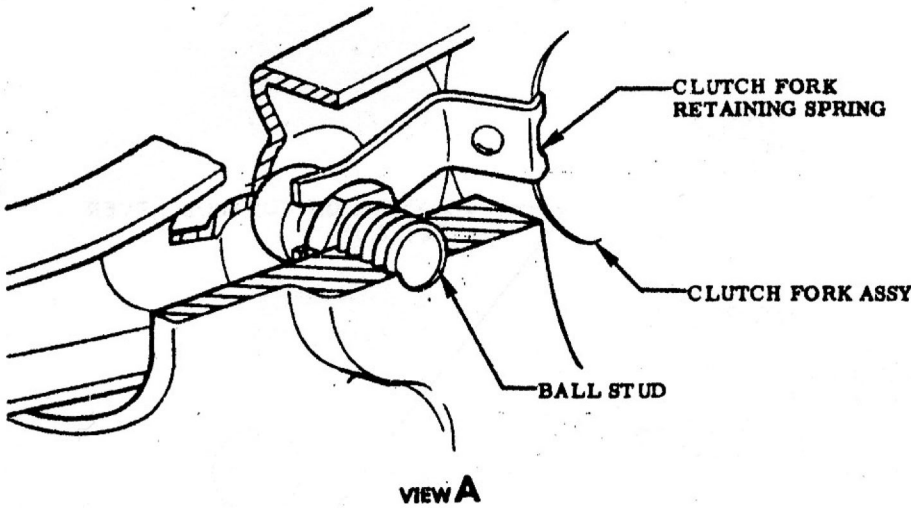

BRUSH A UNIFORM LAYER OF LUBRICANT TO THESE SURFACES FOR FULL CIRCUMFERENCE

FILL THIS GROOVE WITH LUBRICANT FOR FULL CIRCUMFERENCE. APPLY WITH SPECIAL GUN

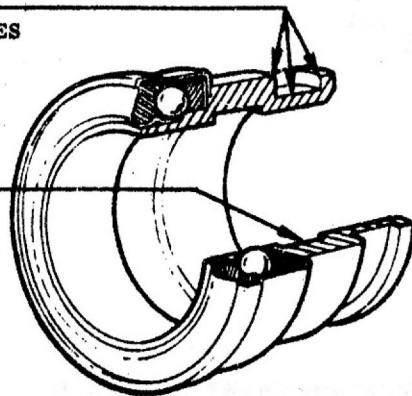

SEE LUBRICATION CHART SECTION 14
CLUTCH RELEASE BEARING

						NAME	CORVETTE INSTRUCTION MANUAL				
						REF.	DRAWN	CHECKED L. B.	SECT.	SHEET	
1-30-54	1	WAS 3724507			F	DATE	PART No.		6	12.00	
DATE	SYM.	REVISION RECORD	AUTH.	DR.	CK.	9-15-55	3726900				

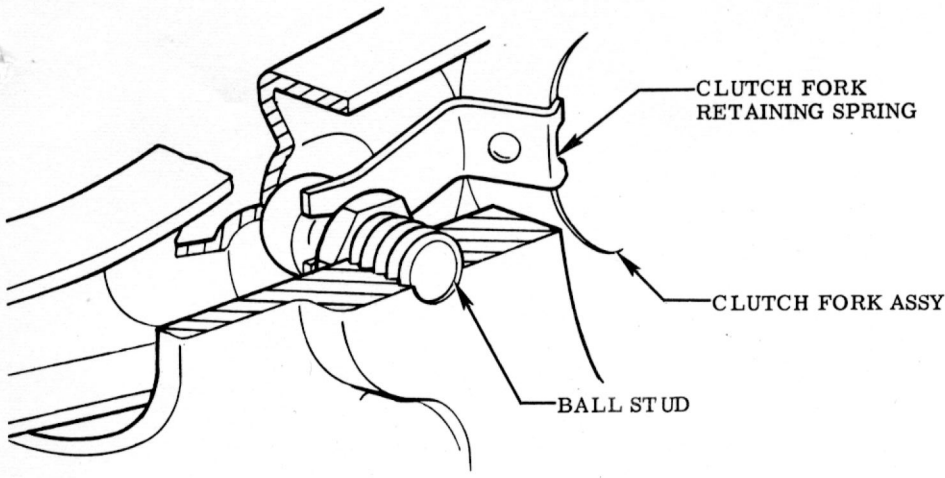

VIEW A

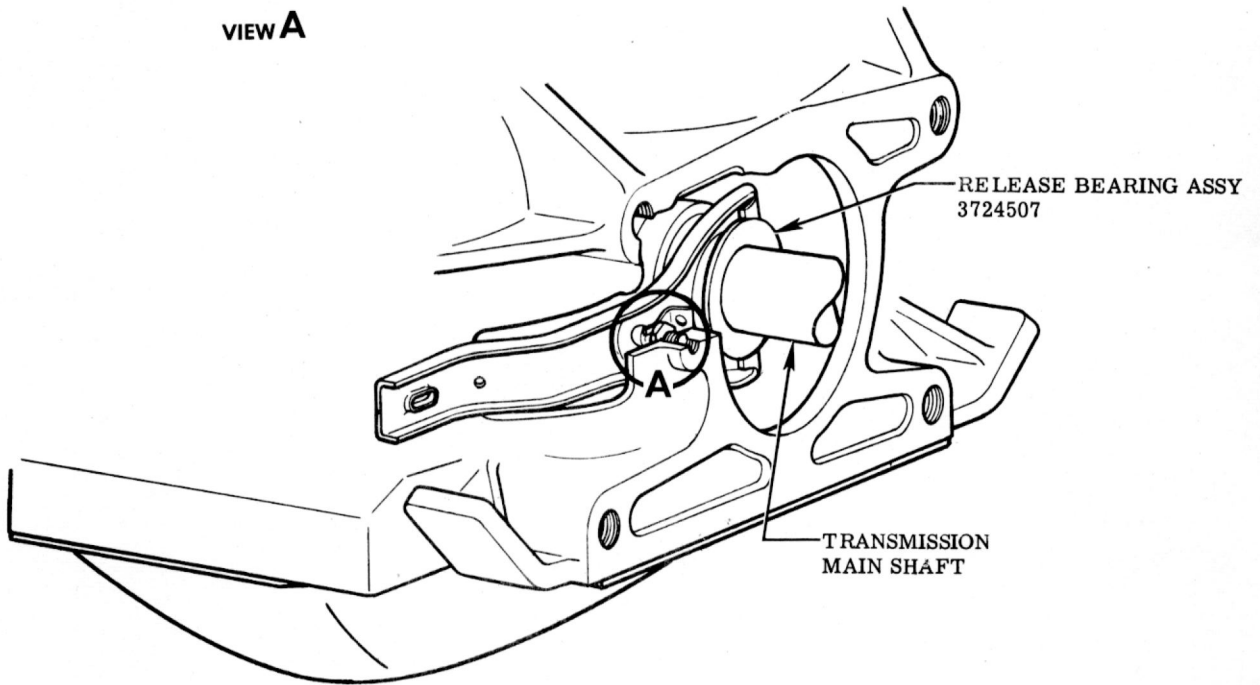

BRUSH A UNIFORM LAYER OF LUBRICANT TO THESE SURFACES FOR FULL CIRCUMFERENCE

FILL THIS GROOVE WITH LUBRICANT FOR FULL CIRCUMFERENCE. APPLY WITH SPECIAL GUN

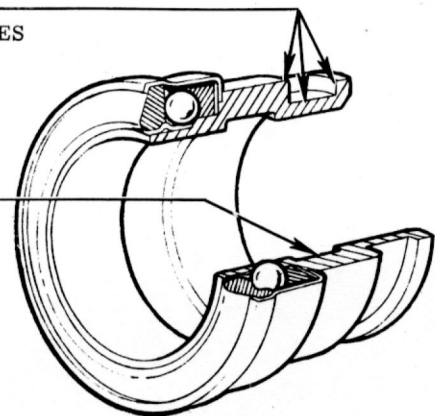

SEE LUBRICATION CHART SECTION 14

CLUTCH RELEASE BEARING

						NAME CORVETTE INSTRUCTION MANUAL				
						REF.	DRAWN	CHECKED L. S.	SECT.	SHEET
						DATE 9-15-55	PART No. 3726900		6	12.00
DATE	SYM.	REVISION RECORD	AUTH.	DR.	CK.					