

MYTEK LEDGER  
MADE FROM CELLULOSE

579 FUEL INJECTION

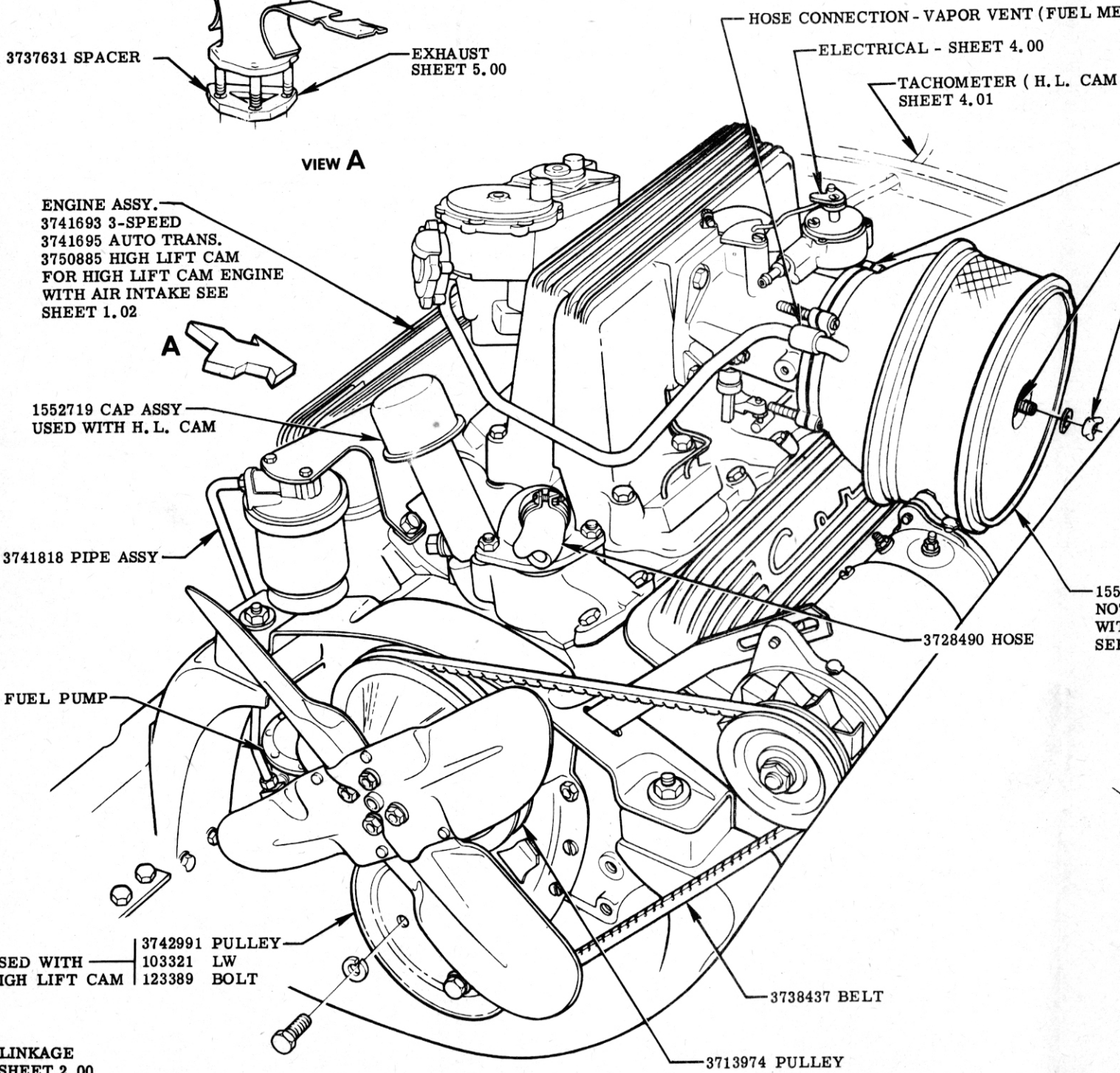

**FUEL INJECTION - ENGINE**

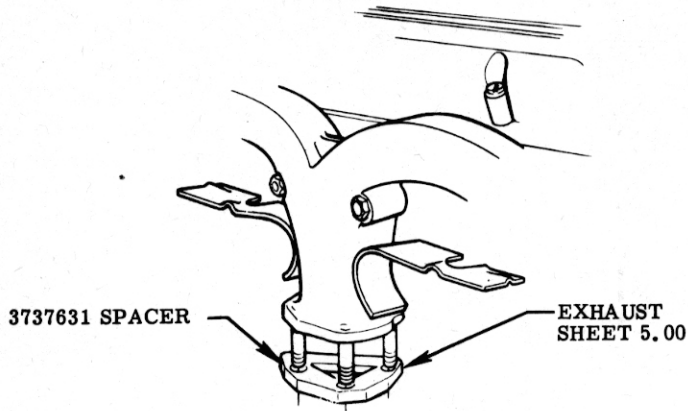

GENERAL MOTORS CORPORATION

3742513 REAR COMPARTMENT LID INSTRUCTION

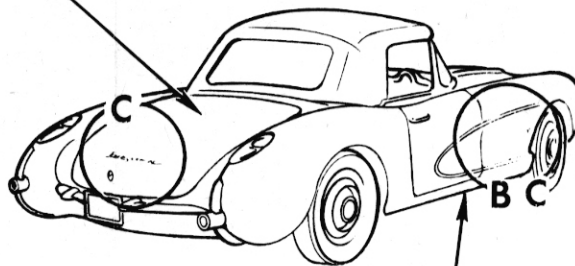

3740280 UNDERBODY ROCKER PANEL INSTRUCTION

FUEL METER)

L. CAM WITH AIR INTAKE ONLY )

3741810 GASKET

3719981 STUD

117204 WING NUT  
120392 WASHER

NOT USED WITH HIGH LIFT CAM WITH AIR INTAKE

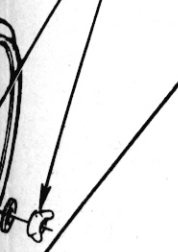

1553556 AIR CLEANER ASSY. NOT USED WITH H. L. CAM WITH AIR INTAKE SEE SHEET 1.01

1174636 NUT

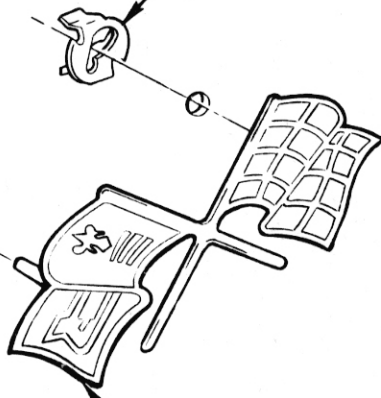

3742212 PLATE

3742213 EMBLEM

VIEW B

VIEW C

							NAME	CORVETTE INSTRUCTION MANUAL			
							REF.	DRAWN	CHECKED	R. P. O.	SHEET
								V	F		
7-25-57	4	REDRAWN & REVISED 8949 8289	1585	V	F	DATE	PART No.	3726900		579	1.00
DATE	SYM.	REVISION RECORD	AUTH.	DR.	CK.	9-15-56					

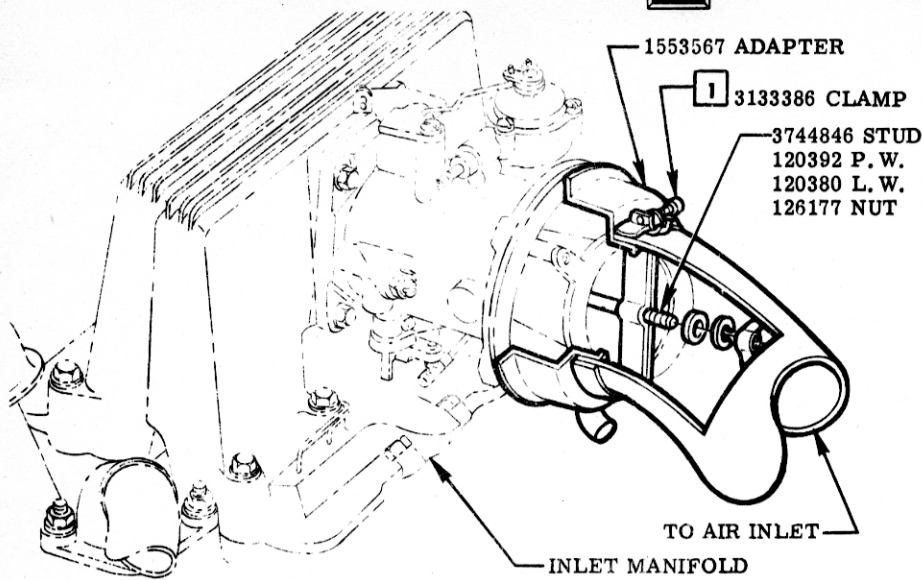

ATTACHMENT AT ENGINE INLET MANIFOLD

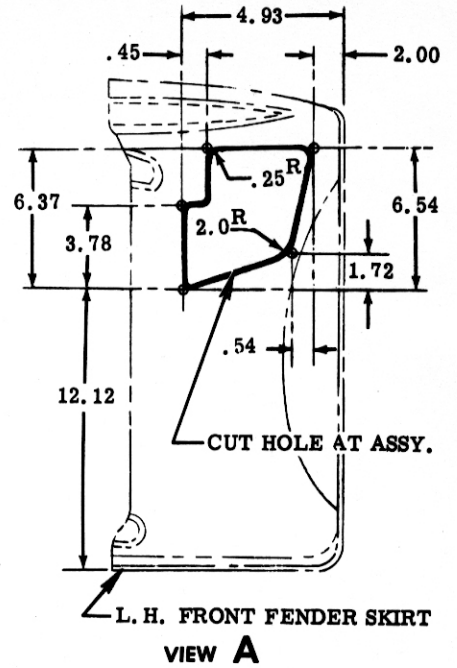

L. H. FRONT FENDER SKIRT  
VIEW A

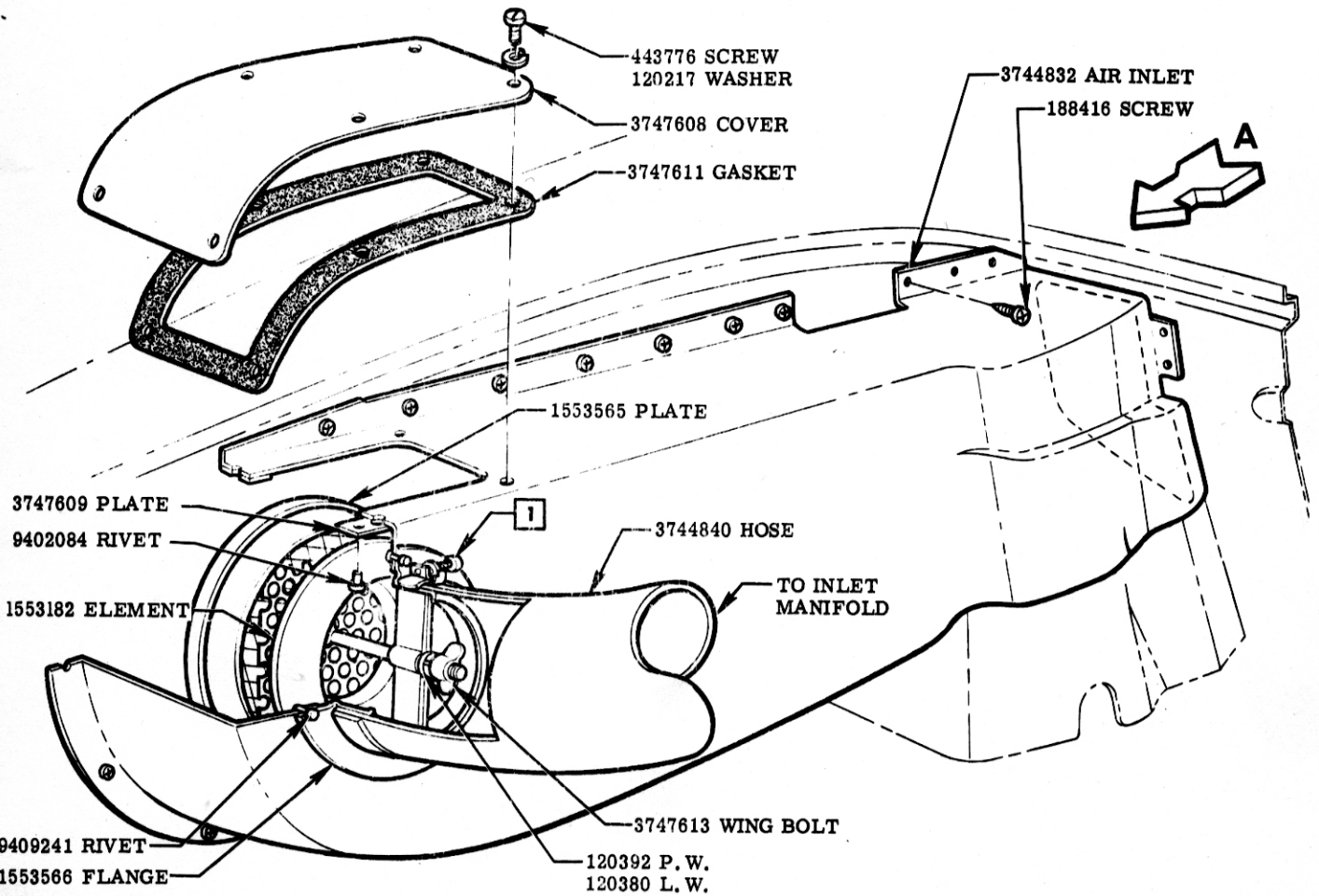

FUEL INJECTION— HIGH LIFT CAM WITH AIR INTAKE

					NAME										
					CORVETTE INSTRUCTION MANUAL										
						REF.		DRAWN		CHECKED		R. P. O.		SHEET	
7-25-57		RELEASED		6814				V		F		579		1.01	
DATE		SYM.		REVISION RECORD		AUTH.		DR.		CK.		DATE		PART No.	
												7-9-57		3726900	

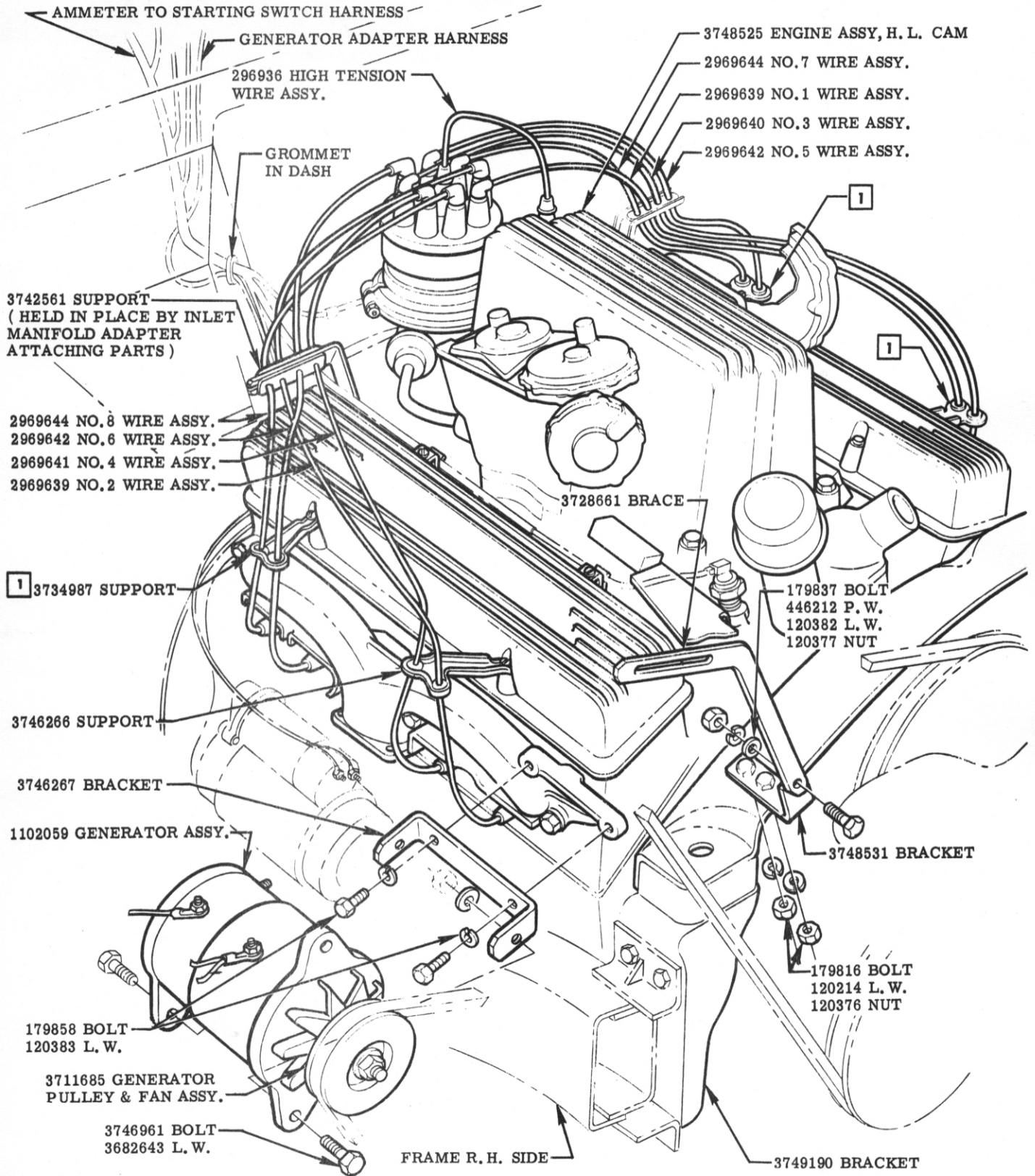

**FUEL INJECTION—HIGH LIFT CAM WITH AIR INTAKE, ENGINE & WIRING**

						NAME CORVETTE INSTRUCTION MANUAL				
						REF.	DRAWN	CHECKED	R. P. O.	SHEET
								V	F	
7-25-57		RELEASED	8949	603		DATE	PART No. 3726900		579	1.02
DATE	SYM.	REVISION RECORD		AUTH.	DR.	CK.	5-17-57			

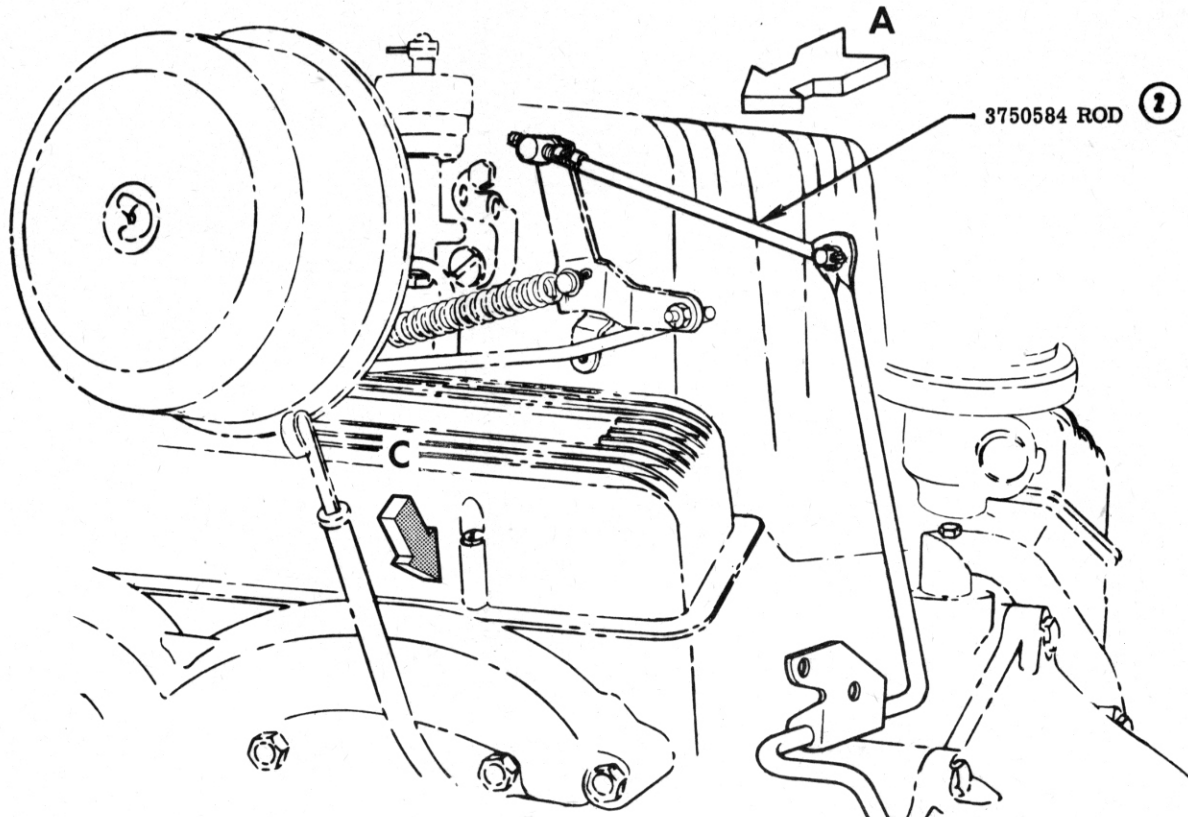

3750584 ROD ②

ACCELERATOR PEDAL

3741761 PEDAL ROD ASSY.

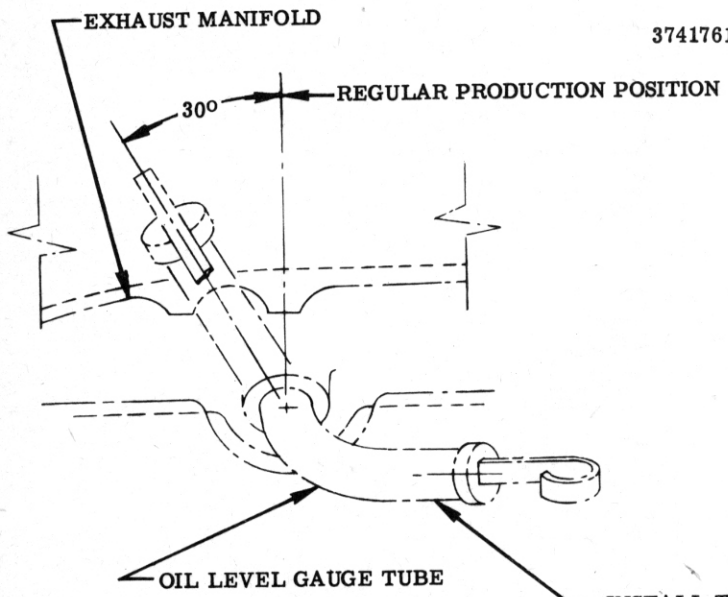

EXHAUST MANIFOLD

REGULAR PRODUCTION POSITION

30°

OIL LEVEL GAUGE TUBE

INSTALL TUBE AT 120° FROM REGULAR PRODUCTION POSITION

③ VIEW C (TRUE VIEW)

(HIGH LIFT CAM ENGINE WITH AIR INTAKE ONLY)

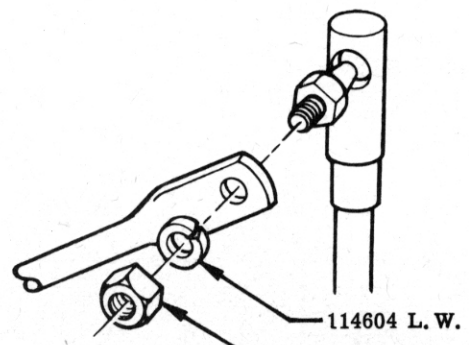

VIEW B

114604 L. W.

142247 NUT

FUEL INJECTION - LINKAGE



GENERAL MOTORS CORPORATION

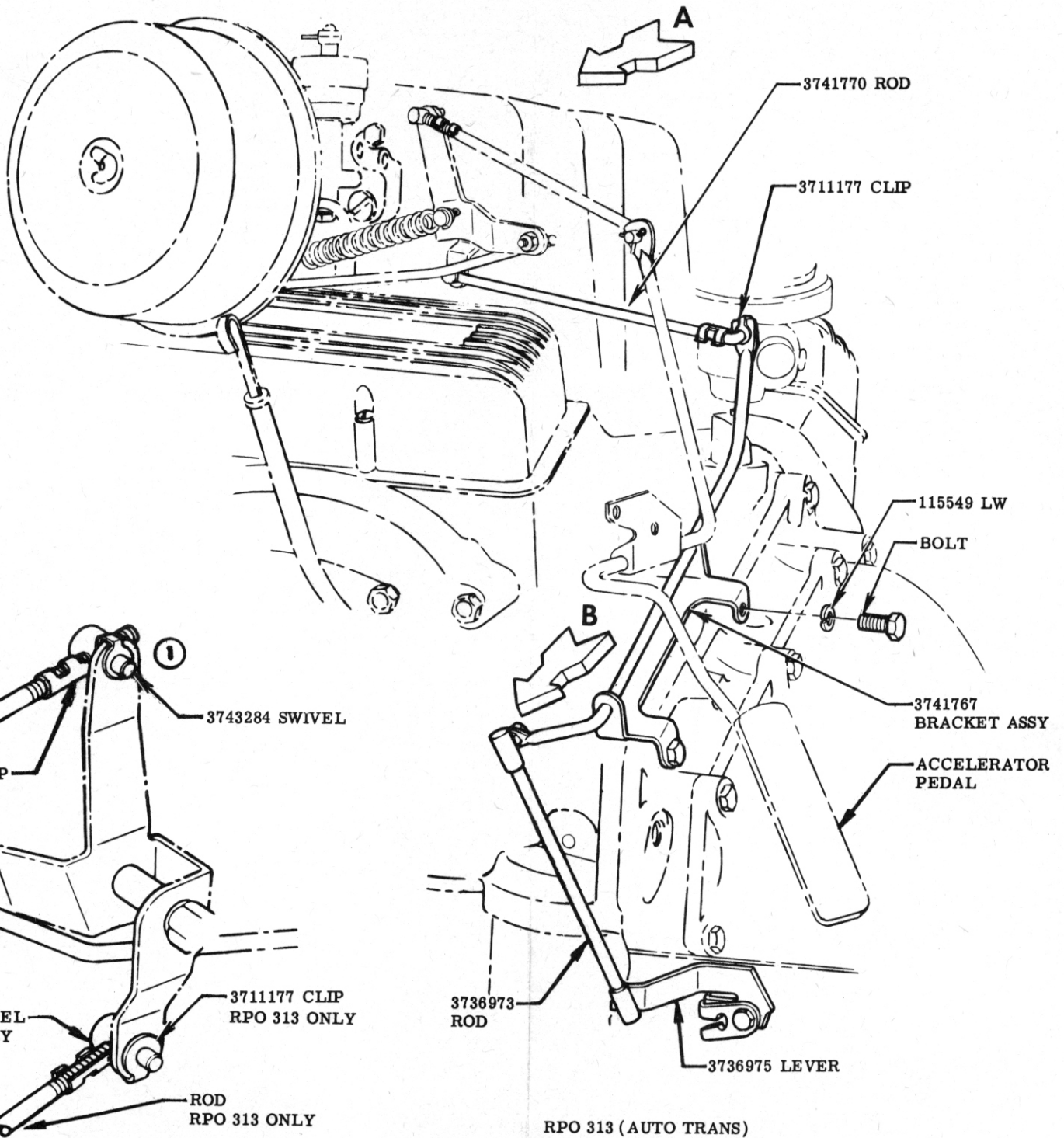

VIEW A

RPO 313 (AUTO TRANS)

					NAME CORVETTE INSTRUCTION MANUAL					
7-25-57	3	VIEW ADDED	6814		F	REF.	DRAWN	CHECKED	R. P. O.	SHEET
4-12-57	2	WAS 3741764	617				V	F		
10-22-56	1	3743295 SPRING REMOVED	305		F	DATE	PART No.		579	2.00
		RELEASED	3750			10-2-56	3726900			
DATE	SYM.	REVISION RECORD	AUTH.	DR.	CK.					

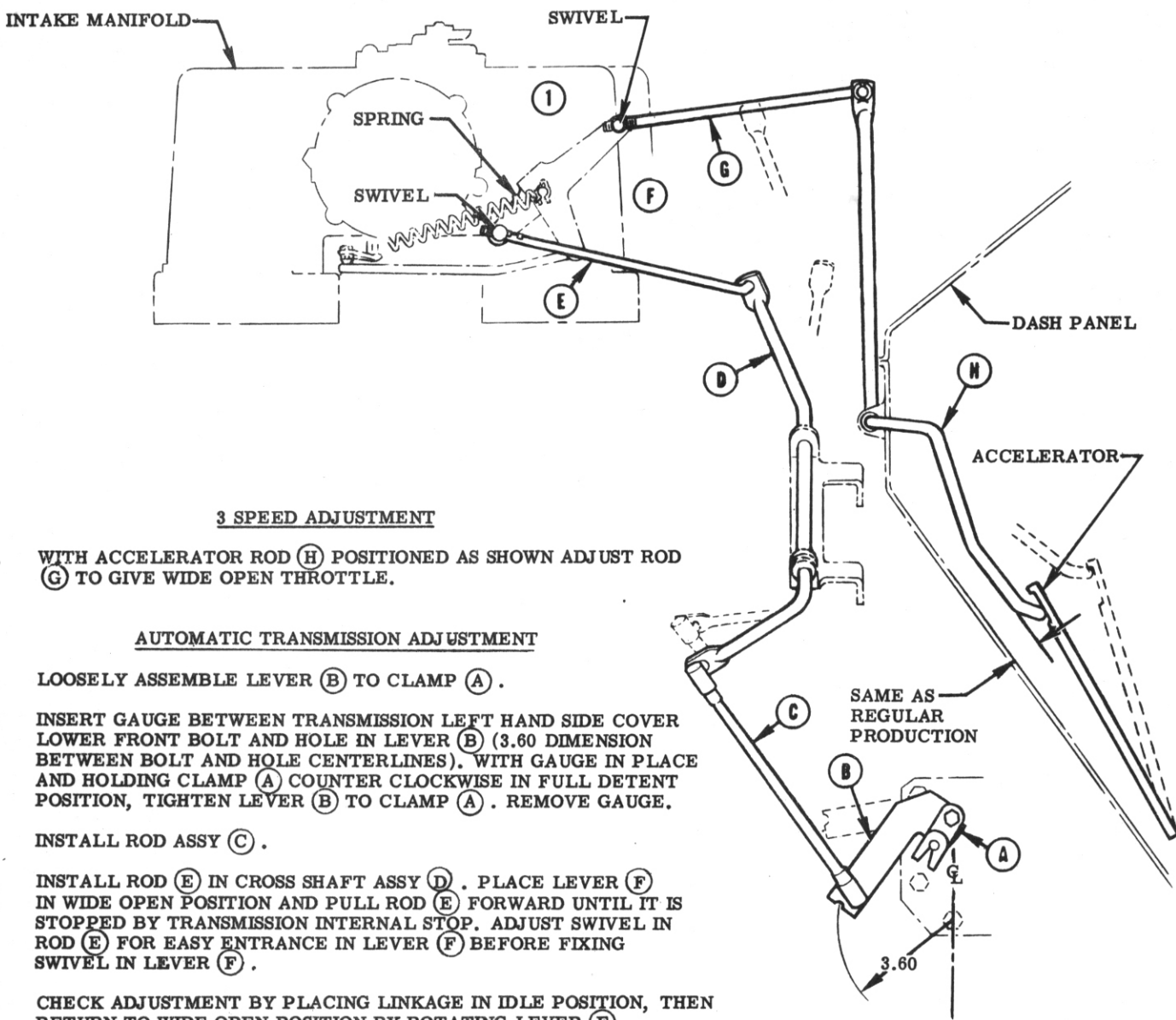

**3 SPEED ADJUSTMENT**

1. WITH ACCELERATOR ROD (H) POSITIONED AS SHOWN ADJUST ROD (G) TO GIVE WIDE OPEN THROTTLE.

**AUTOMATIC TRANSMISSION ADJUSTMENT**

1. LOOSELY ASSEMBLE LEVER (B) TO CLAMP (A).
2. INSERT GAUGE BETWEEN TRANSMISSION LEFT HAND SIDE COVER LOWER FRONT BOLT AND HOLE IN LEVER (B) (3.60 DIMENSION BETWEEN BOLT AND HOLE CENTERLINES). WITH GAUGE IN PLACE AND HOLDING CLAMP (A) COUNTER CLOCKWISE IN FULL DETENT POSITION, TIGHTEN LEVER (B) TO CLAMP (A). REMOVE GAUGE.
3. INSTALL ROD ASSY (C).
4. INSTALL ROD (E) IN CROSS SHAFT ASSY (D). PLACE LEVER (F) IN WIDE OPEN POSITION AND PULL ROD (E) FORWARD UNTIL IT IS STOPPED BY TRANSMISSION INTERNAL STOP. ADJUST SWIVEL IN ROD (E) FOR EASY ENTRANCE IN LEVER (F) BEFORE FIXING SWIVEL IN LEVER (F).
5. CHECK ADJUSTMENT BY PLACING LINKAGE IN IDLE POSITION, THEN RETURN TO WIDE OPEN POSITION BY ROTATING LEVER (F). PUSH UPWARD ON LEVER (B) AND NOTE IF ROD (C) DEFLECTS, MEANING TRANSMISSION IS NOT ON INTERNAL STOP. IF ROD DEFLECTS, OR LEVER (F) WILL NOT REACH WIDE OPEN POSITION, REPEAT ADJUSTMENT 4.
6. WITH ACCELERATOR PEDAL DEPRESSED, PLACING LOWEST POINT ON ACCELERATOR ROD THE SAME DISTANCE ABOVE THE TOE PANEL AS REGULAR PRODUCTION, AND LEVER (F) ROTATED TO WIDE OPEN POSITION, ADJUST SWIVEL IN ROD (G) FOR FREE ENTRY INTO LEVER (F) BEFORE FIXING SWIVEL TO LEVER (F).
7. CHECK ADJUSTMENT BY RELEASING, THEN DEPRESSING ACCELERATOR PEDAL. CHECK LEVER (F) FOR WIDE OPEN POSITION. IF LEVER (F) WILL NOT REACH WIDE OPEN POSITION, REPEAT STEP 6.

**FUEL INJECTION - LINKAGE ADJUSTMENT**

					NAME					CORVETTE INSTRUCTION MANUAL				
					REF.		DRAWN		CHECKED		R. P. O.		SHEET	
4-12-57	1	SPRING REMOVED	305	V	F	V		F						
10-22-56		RELEASED	3750											
DATE	SYM.	REVISION RECORD	AUTH.	DR.	CK.	DATE		PART No.		579		3.00		
						10-3-56		3726900						



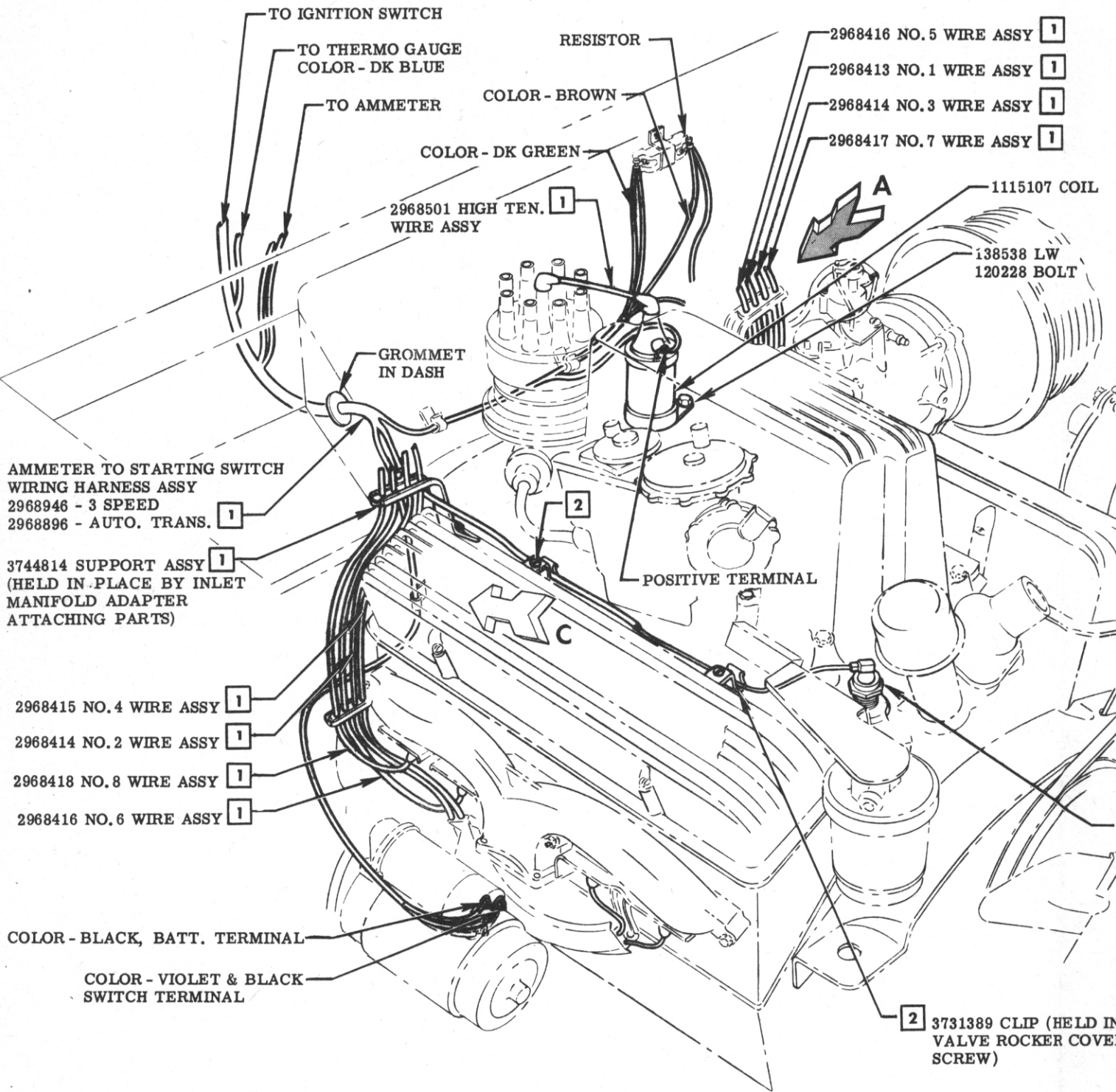

**1** NOT USED WITH HIGH LIFT CAM ENGINE WITH AIR INTAKE. SEE SHEET 1.02

**FUEL INJECTION - ELECTRICAL**



GENERAL MOTORS CORPORATION

COLOR - BROWN, TO TOP TERMINAL OF RESISTOR

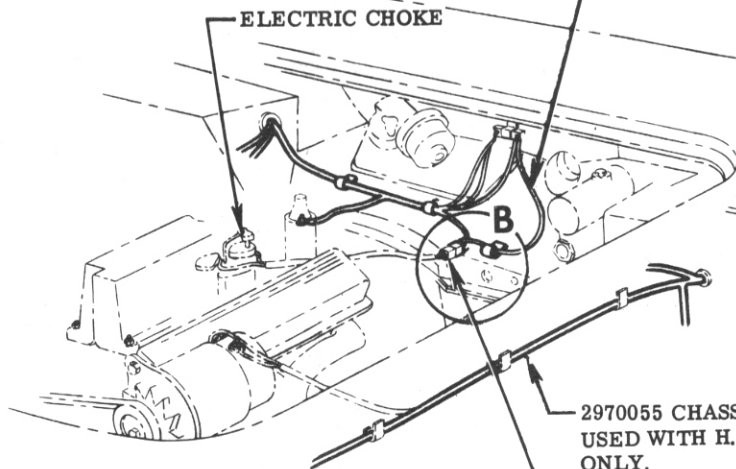

2970055 CHASSIS WIRING HARNESS ASSY. USED WITH H. L. CAM WITH AIR INTAKE ONLY.  
CONNECTOR - ELECTRIC CHOKE & FUEL METER WIRING

VIEW A

COIL  
T

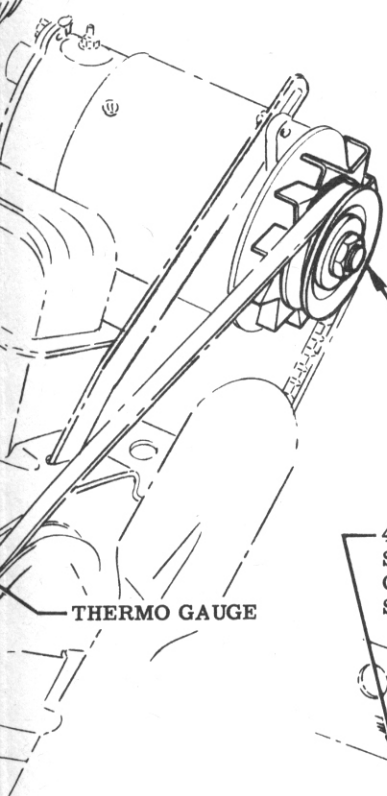

3711766 GENERATOR PULLEY & FAN ASSY I

THERMO GAUGE

4 INCH LONG WIRE, TO SOLENOID TERMINAL ON STARTER MOTOR SOLENOID

6 INCH LONG WIRE, TO SOLENOID TERMINAL ON IGNITION SWITCH

HELD IN PLACE BY COVER ATTACHING

VIEW C  
RPO 313 ONLY

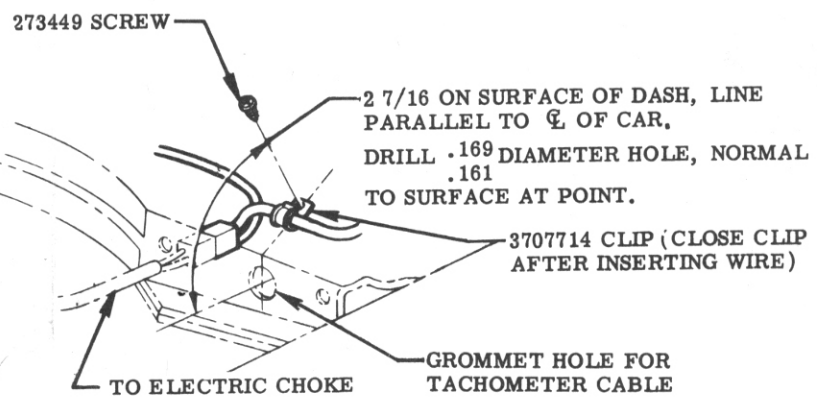

273449 SCREW

2 7/16 ON SURFACE OF DASH, LINE PARALLEL TO C OF CAR. DRILL .169 DIAMETER HOLE, NORMAL .161 TO SURFACE AT POINT.

3707714 CLIP (CLOSE CLIP AFTER INSERTING WIRE)

TO ELECTRIC CHOKE

GROMMET HOLE FOR TACHOMETER CABLE

VIEW B

CORVETTE INSTRUCTION MANUAL									
NAME		CORVETTE INSTRUCTION MANUAL							
REF.	DRAWN	CHECKED	R. P. O.	SHEET					
		V	F	579 4.00					
7-25-57	5	REDRAWN & REVISED	8949	603	V	F	DATE	PART No.	3726900
DATE	SYM.	REVISION RECORD		AUTH.	DR.	CK.	9-5-56		

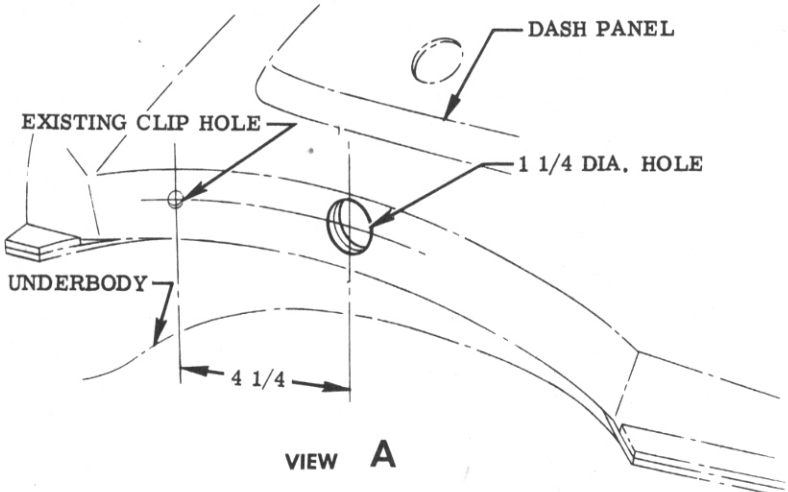

NOTE: COVER TACHOMETER HOLE IN INSTRUMENT PANEL BY USING .10 FLAT PLASTIC SHEET. CEMENT IN PLACE AND FINISH OFF.

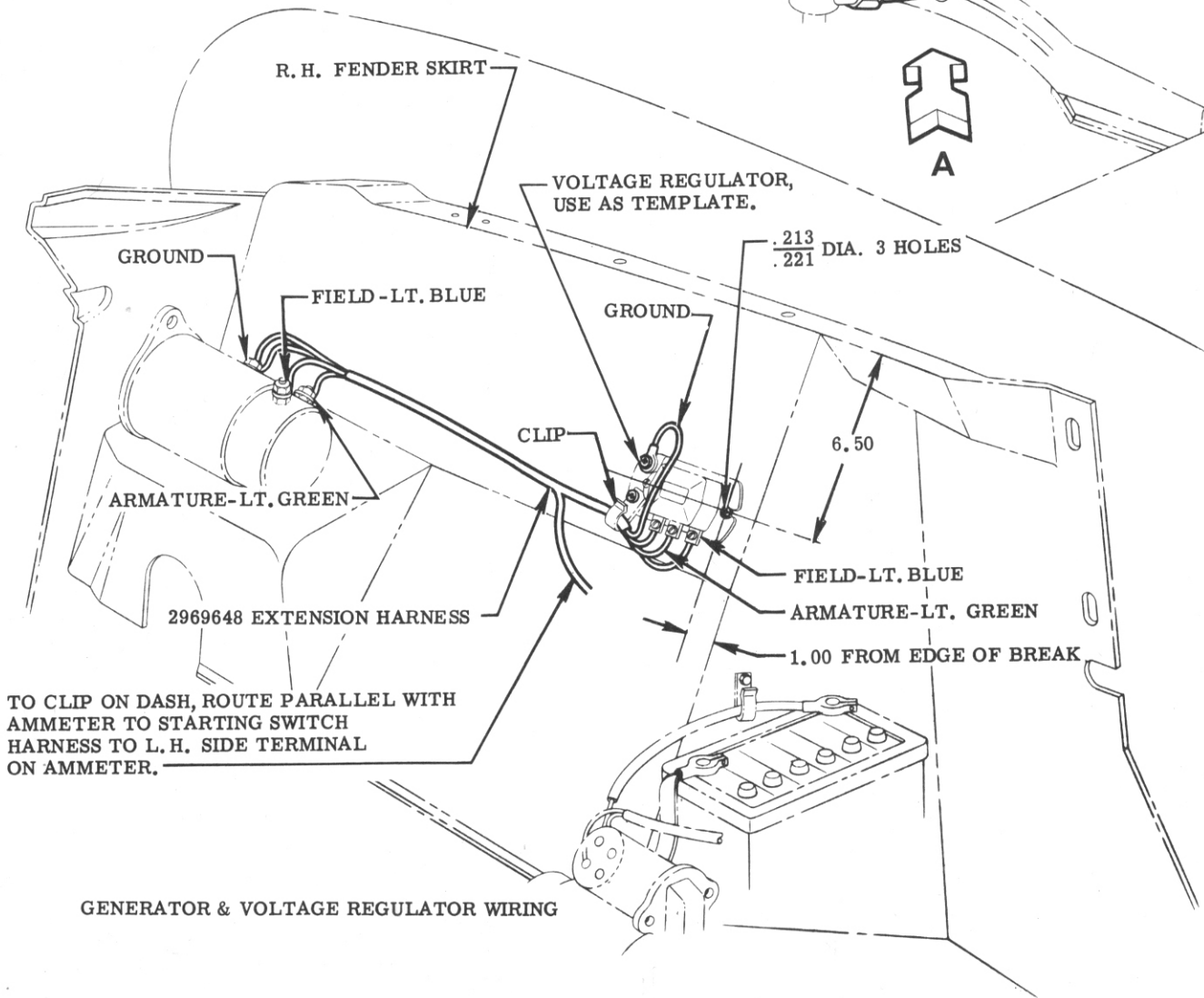
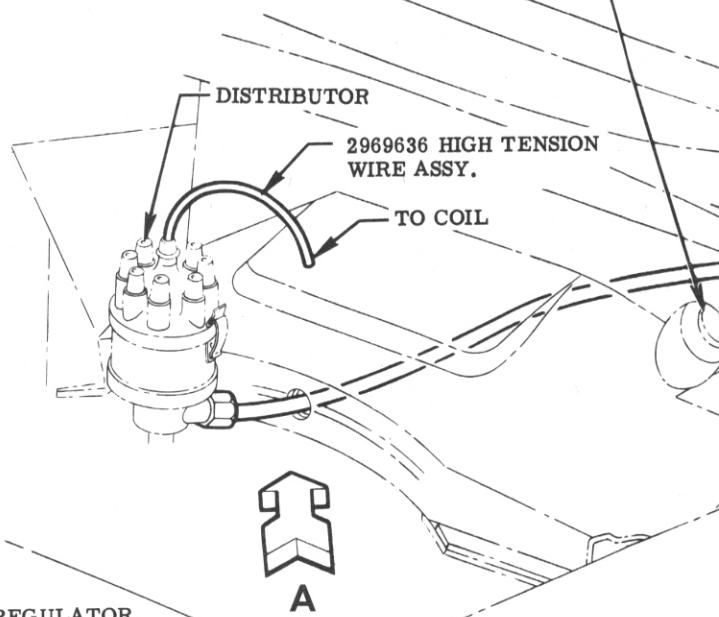



GENERAL MOTORS CORPORATION

INSTRUMENT  
ASSEMBLY

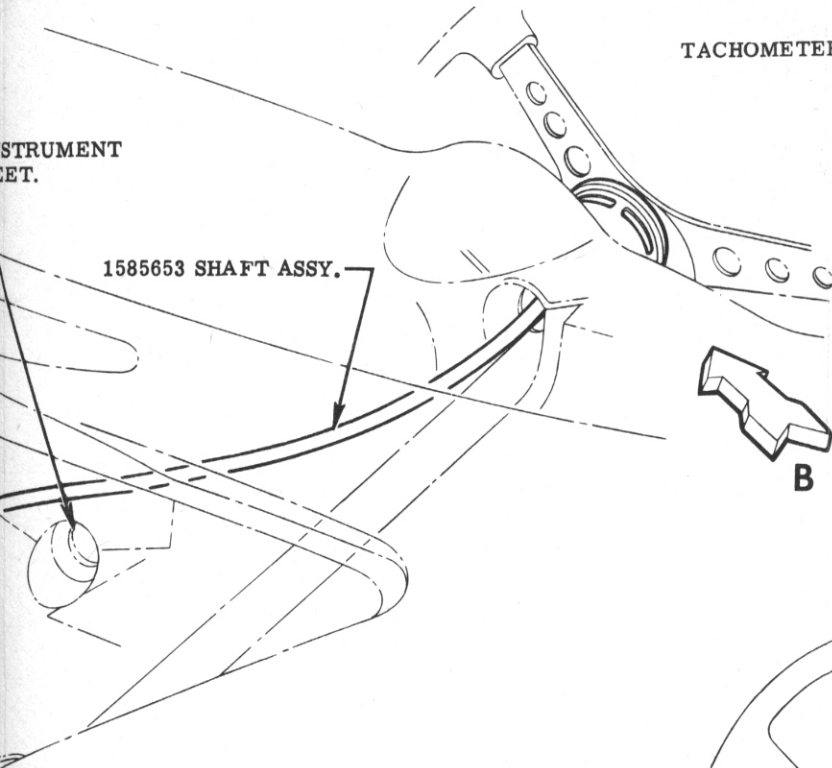

TACHOMETER ASSY

SWITCH ASSY

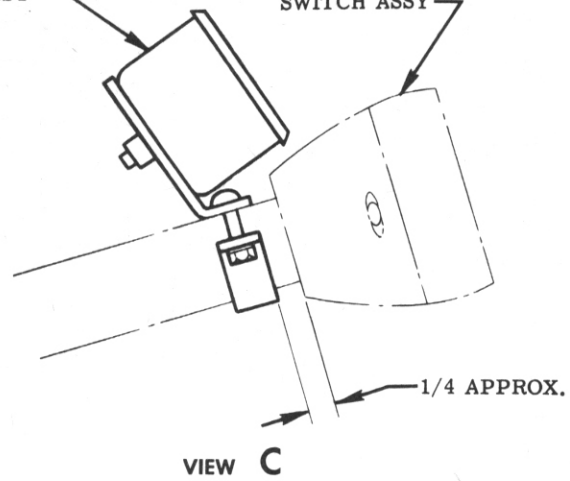

B

INSTRUMENT PANEL

120217 WASHER

120614 NUT

SHAFT ASSY

3748452 BRACKET

3748451 CLAMP

1548680 TACHOMETER ASSY

134551 NUT  
120380 WASHER  
450997 SCREW

VIEW B

						NAME	CORVETTE INSTRUCTION MANUAL			
						REF.	DRAWN	CHECKED	R. P. O.	SHEET
							V	F		
7-25-57	1	REDRAWN & REVISED	603	V	F	DATE	PART No.		579	4.01
DATE	SYM.	REVISION RECORD	AUTH.	DR.	CK.	3-18-57	3726900			

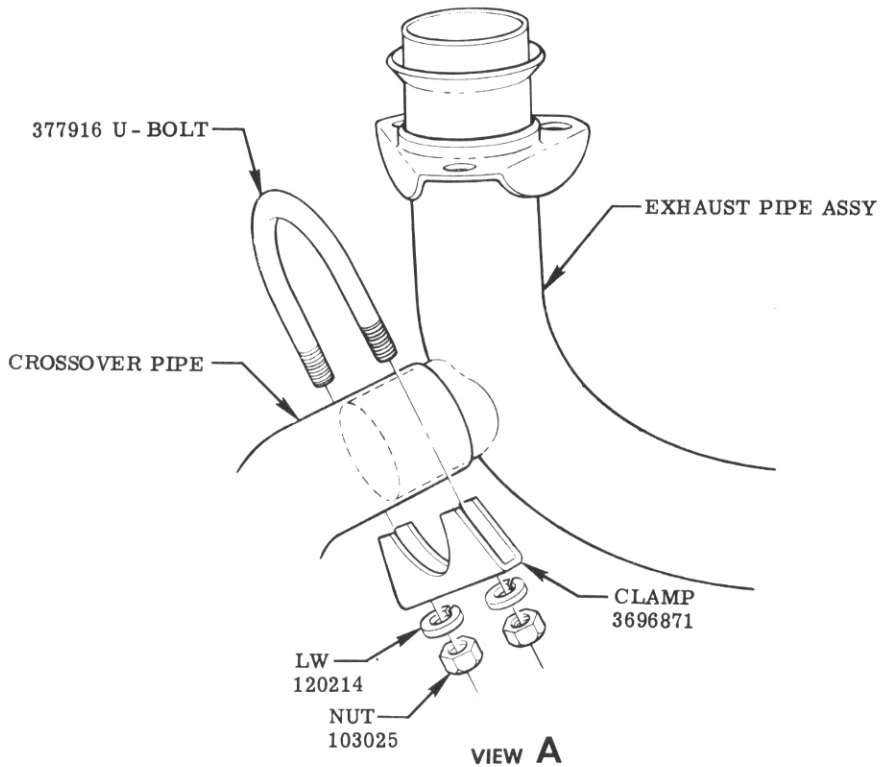
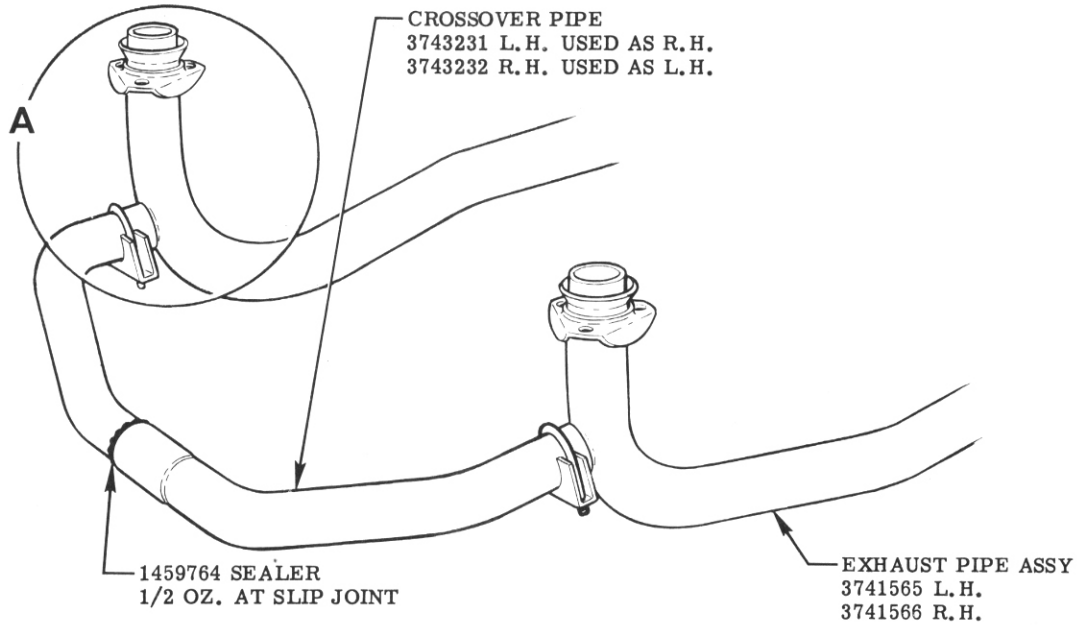

FUEL INJECTION - EXHAUST

				NAME					CORVETTE INSTRUCTION MANUAL	
				REF.	DRAWN	CHECKED	R. P. O.	SHEET		
					V	F				
10-22-56		RELEASED	3750	DATE	PART No.		579 5.00			
DATE	SYM.	REVISION RECORD	AUTH. DR. CK.	10-9-56	3726900					