

MYTEK LEDGER
MADE FROM CELLULOSE

579 FUEL INJECTION

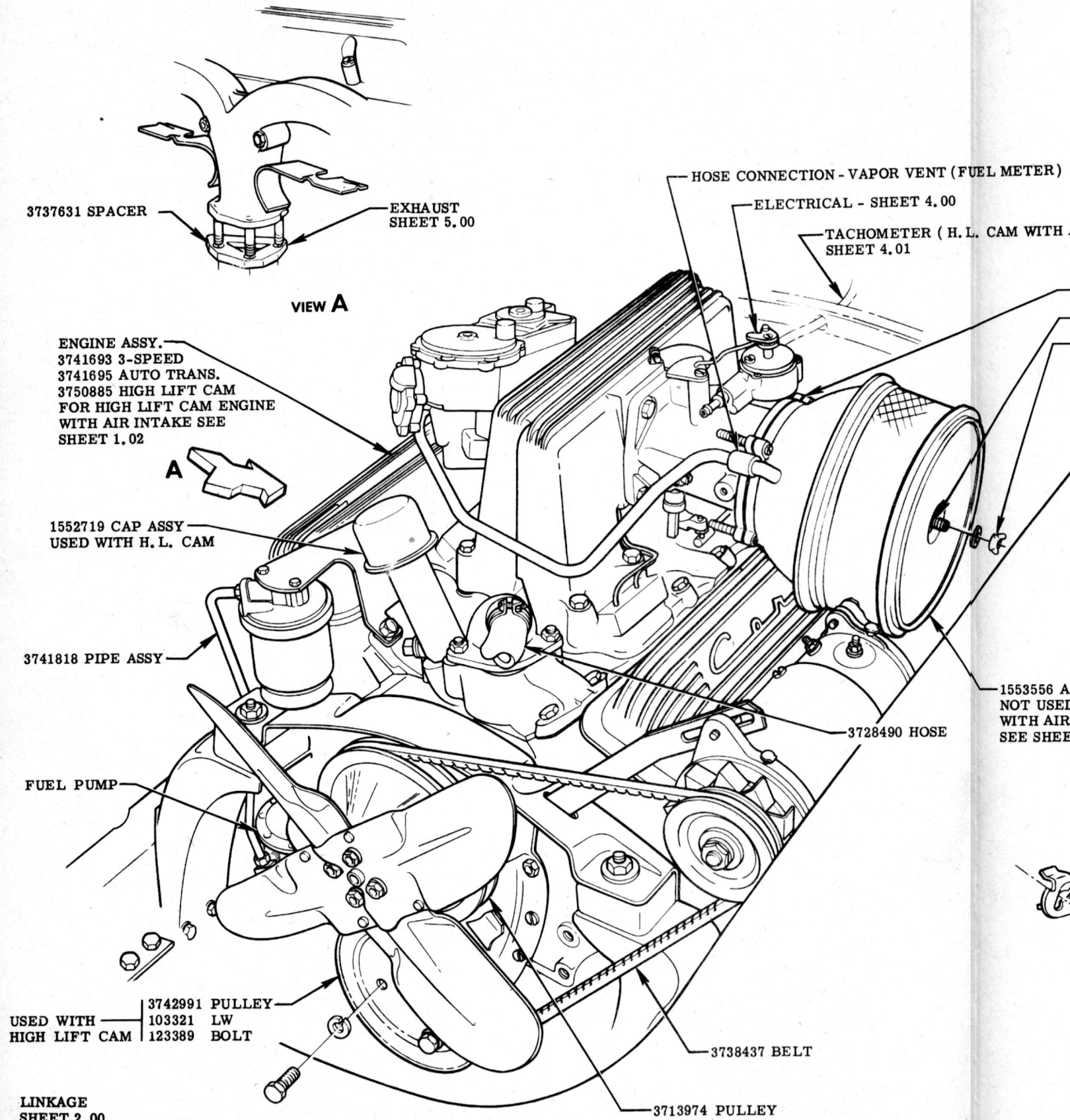

3742513 REAR COMPARTMENT LID INSTRUCTION

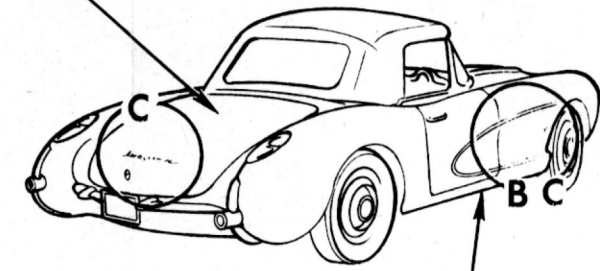

3740280 UNDERBODY ROCKER PANEL INSTRUCTION

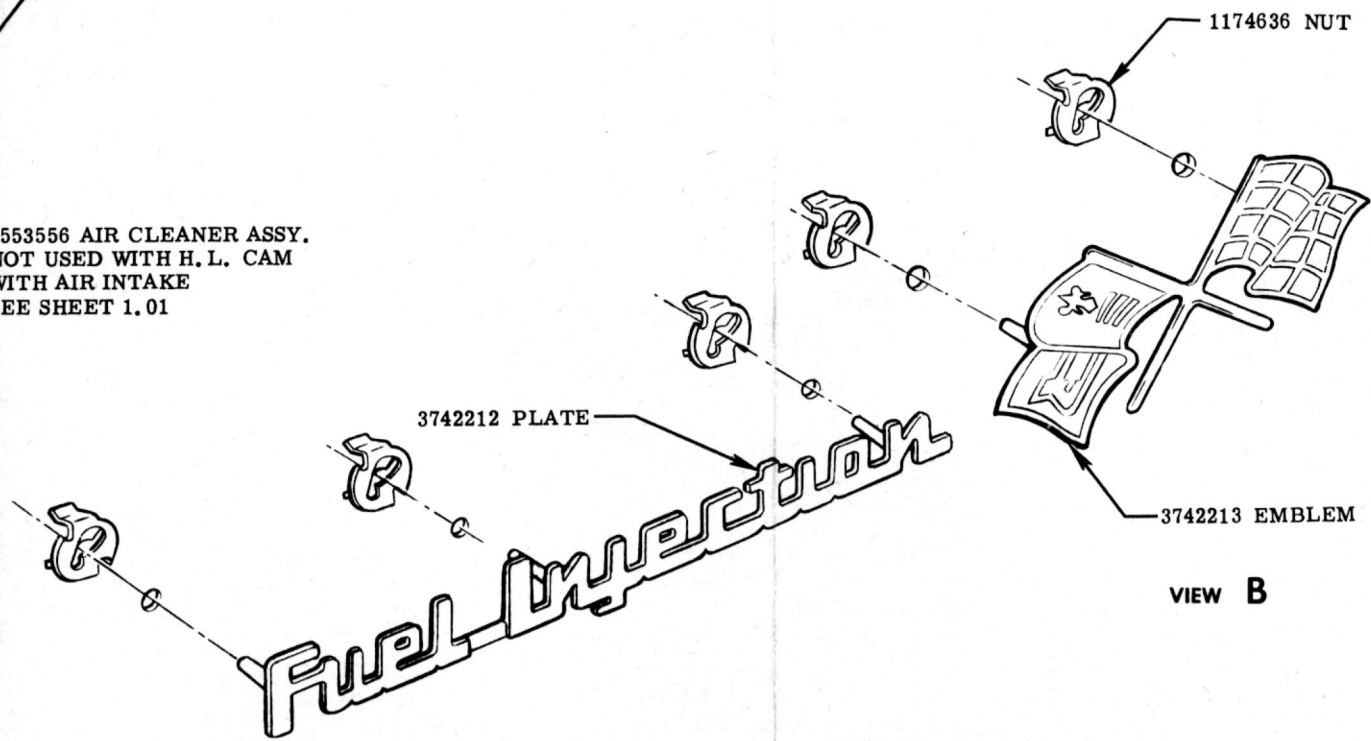

LINKAGE SHEET 2.00

LINKAGE ADJUSTMENT SHEET 3.00

FUEL INJECTION - ENGINE

CORVETTE INSTRUCTION MANUAL									
DATE	SYM.	REVISION RECORD	AUTH.	DR.	CK.	DATE	PART No.	R. P. O.	SHEET
7-25-57	4	REDRAWN & REVISED 8949 8289	1585	V	F	9-15-56	3726900	579	1.00

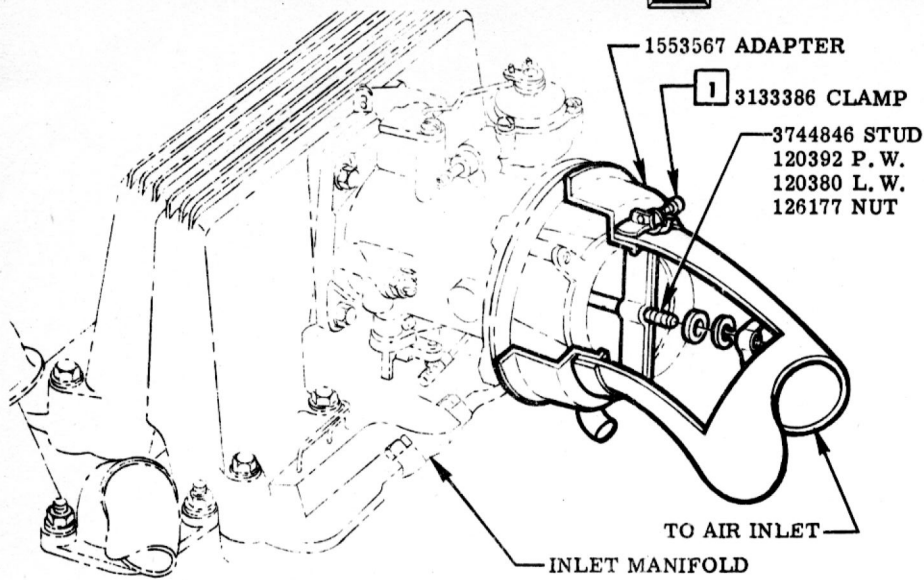

ATTACHMENT AT ENGINE INLET MANIFOLD

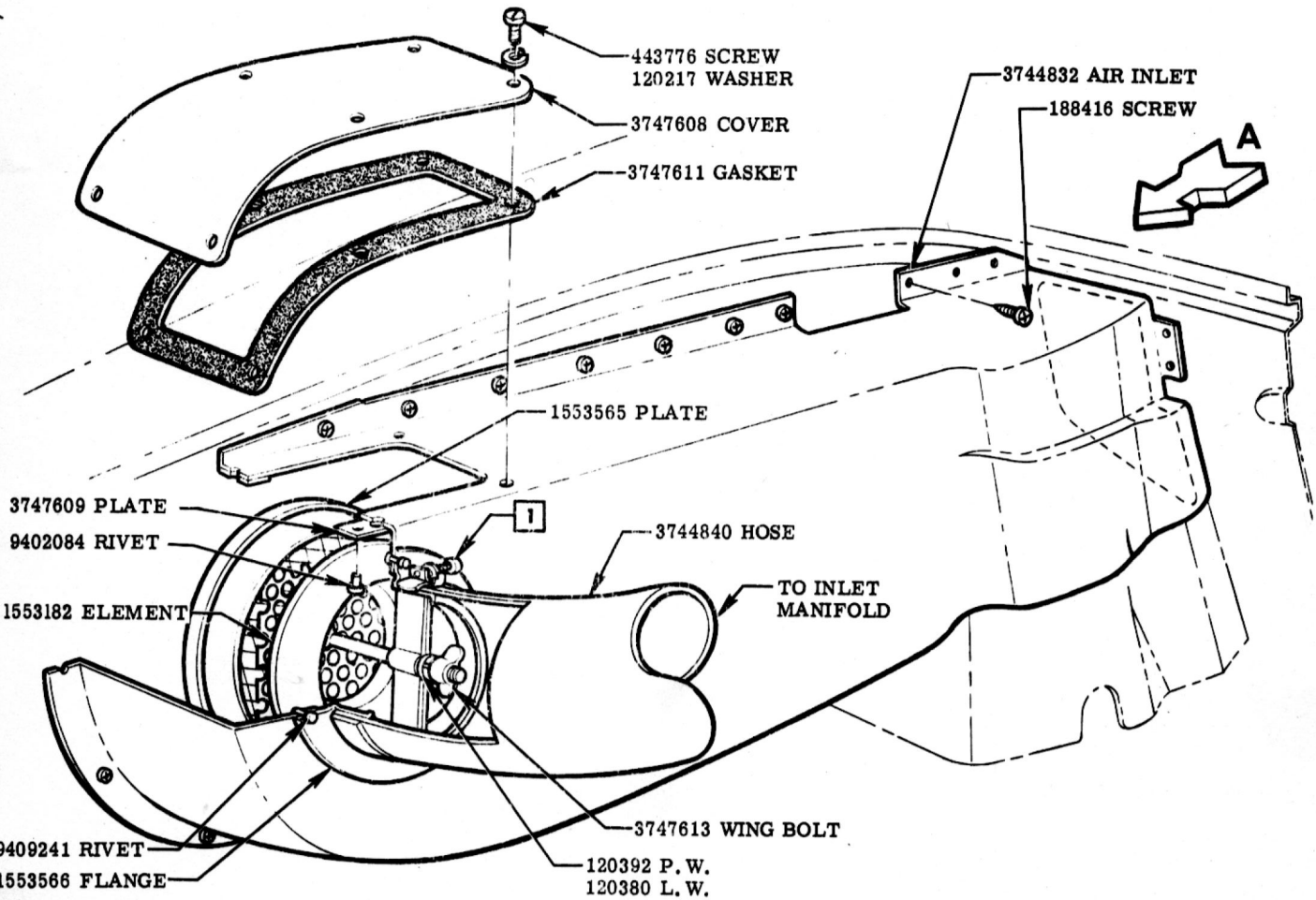
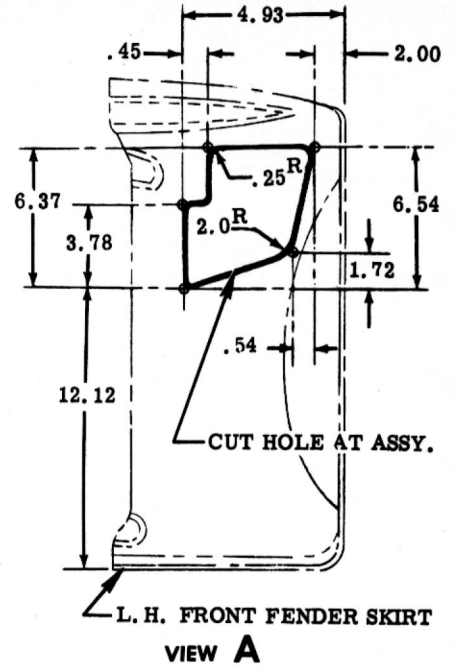

FUEL INJECTION— HIGH LIFT CAM WITH AIR INTAKE

					NAME	CORVETTE INSTRUCTION MANUAL			
					REF.	DRAWN	CHECKED	R. P. O.	SHEET
7-25-57	RELEASED	6814			DATE	V	F	579	1.01
DATE	SYM.	REVISION RECORD	AUTH.	DR.	CK.	PART No.	3726900		
						7-9-57			

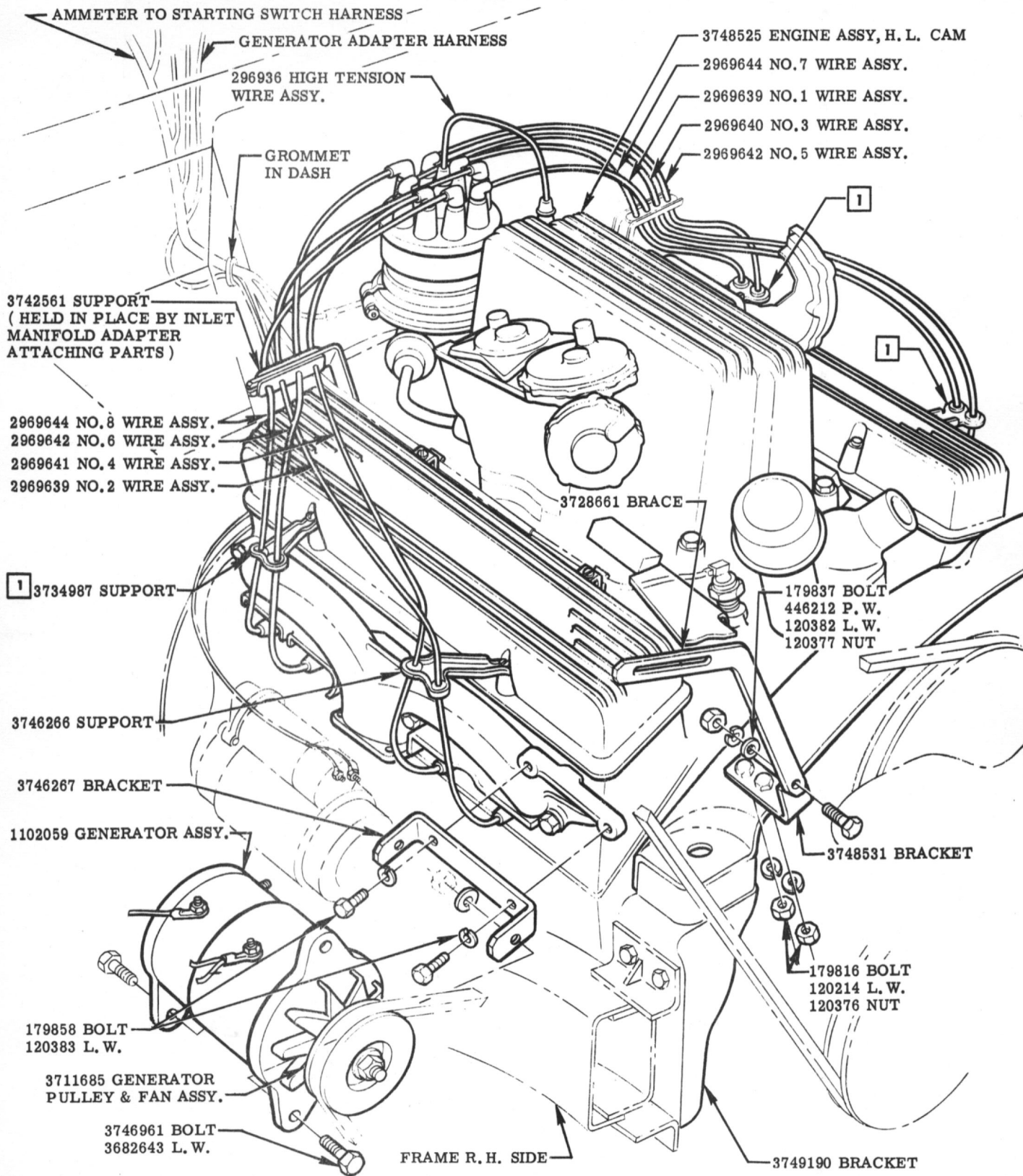

FUEL INJECTION—HIGH LIFT CAM WITH AIR INTAKE, ENGINE & WIRING

					NAME					CORVETTE INSTRUCTION MANUAL				
					REF.		DRAWN		CHECKED		R. P. O.		SHEET	
							V		F		579		1.02	
7-25-57					RELEASED					8949 603				
DATE					SYM.					REVISION RECORD				
					AUTH.					DR. CK.				
					5-17-57					PART No. 3726900				

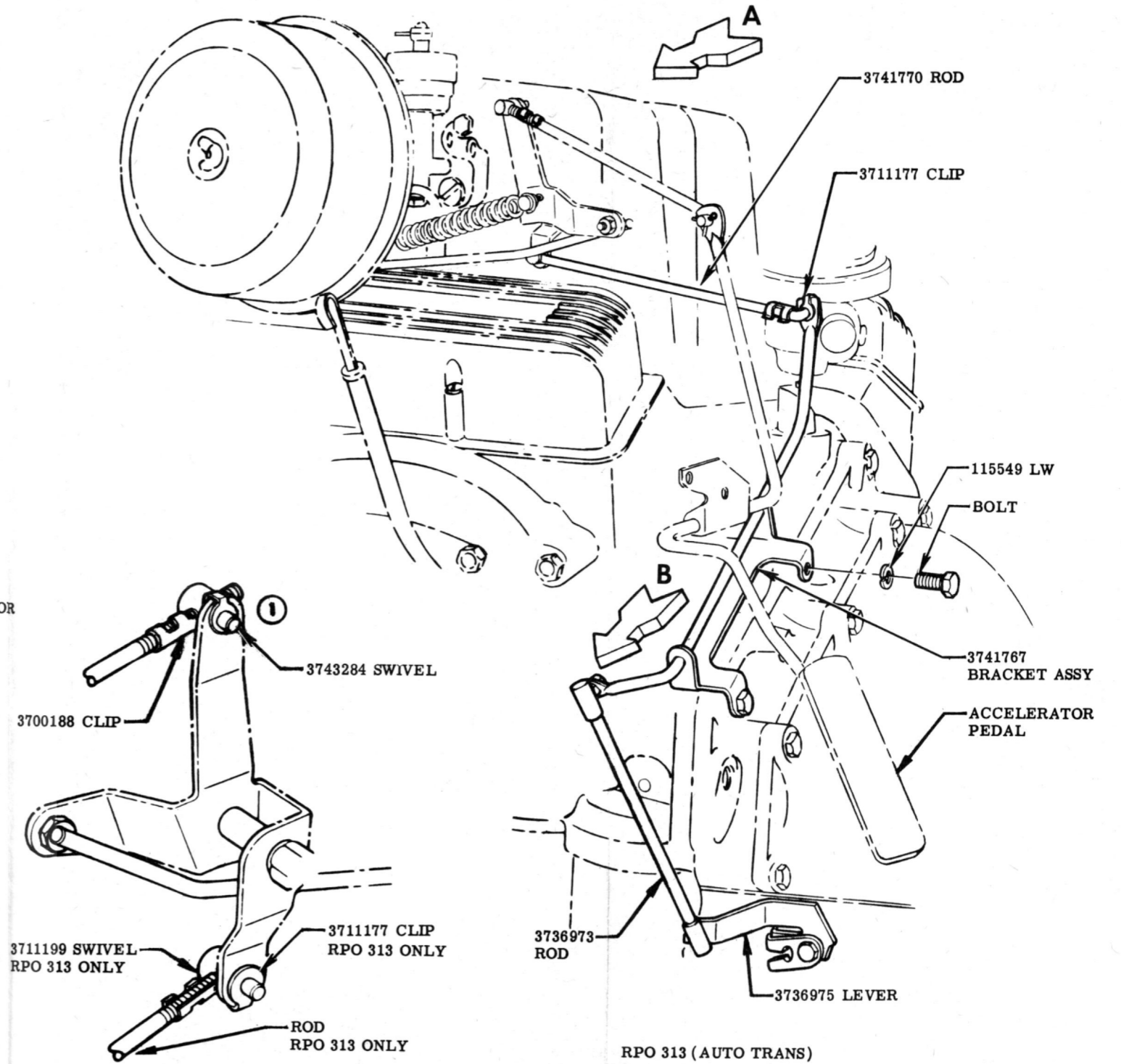
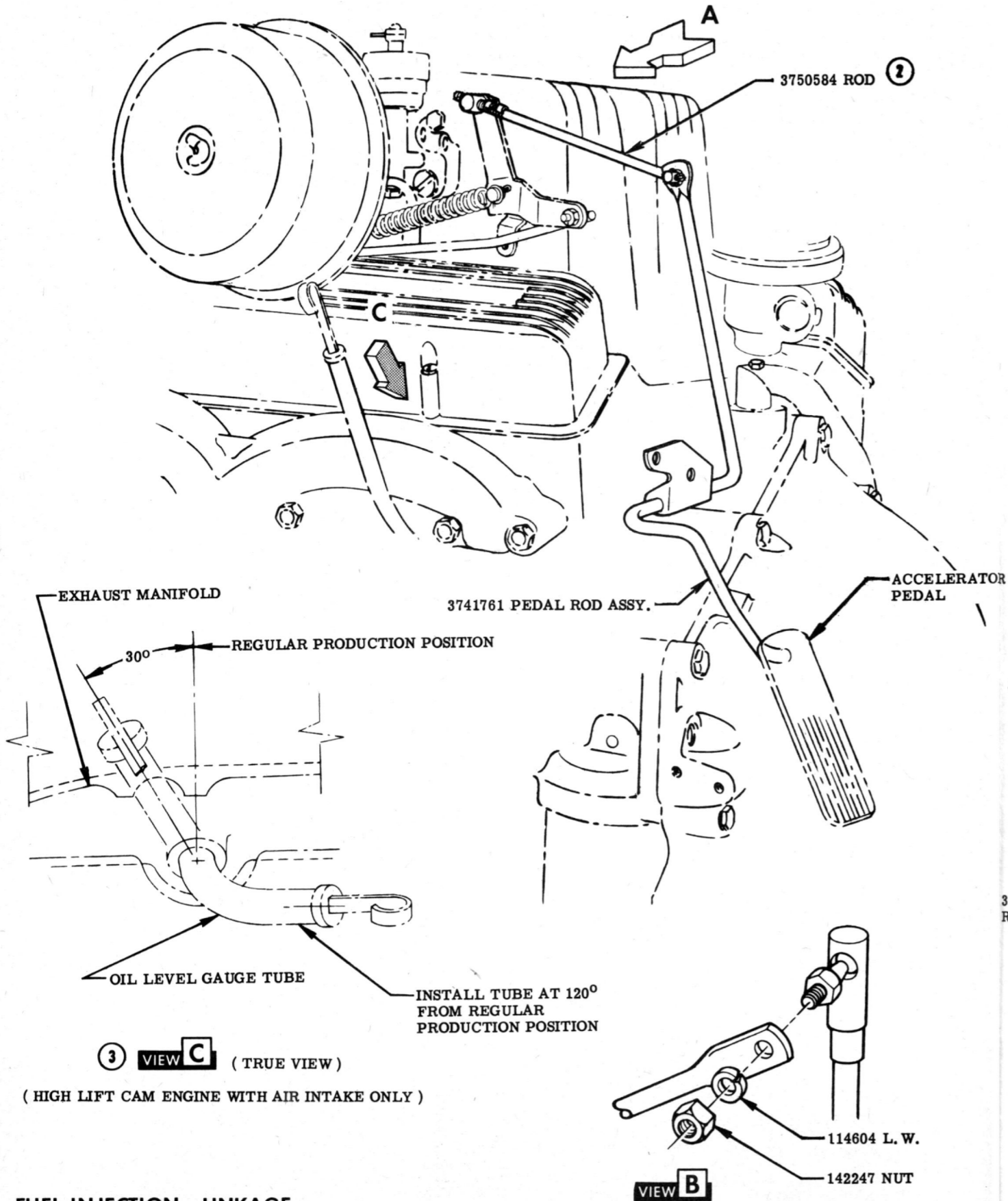

CORVETTE INSTRUCTION MANUAL					
7-25-57	2	WAS 3741764	6814		F
4-12-57	1	3743295 SPRING REMOVED	617		F
10-22-56		RELEASED	305		
			3750		
DATE	SYM.	REVISION RECORD	AUTH.	DR.	CK.
			NAME		
			CORVETTE INSTRUCTION MANUAL		
			REF.	DRAWN	CHECKED
				V	F
			DATE	PART No.	R. P. O.
			10-2-56	3726900	579
					SHEET
					2.00

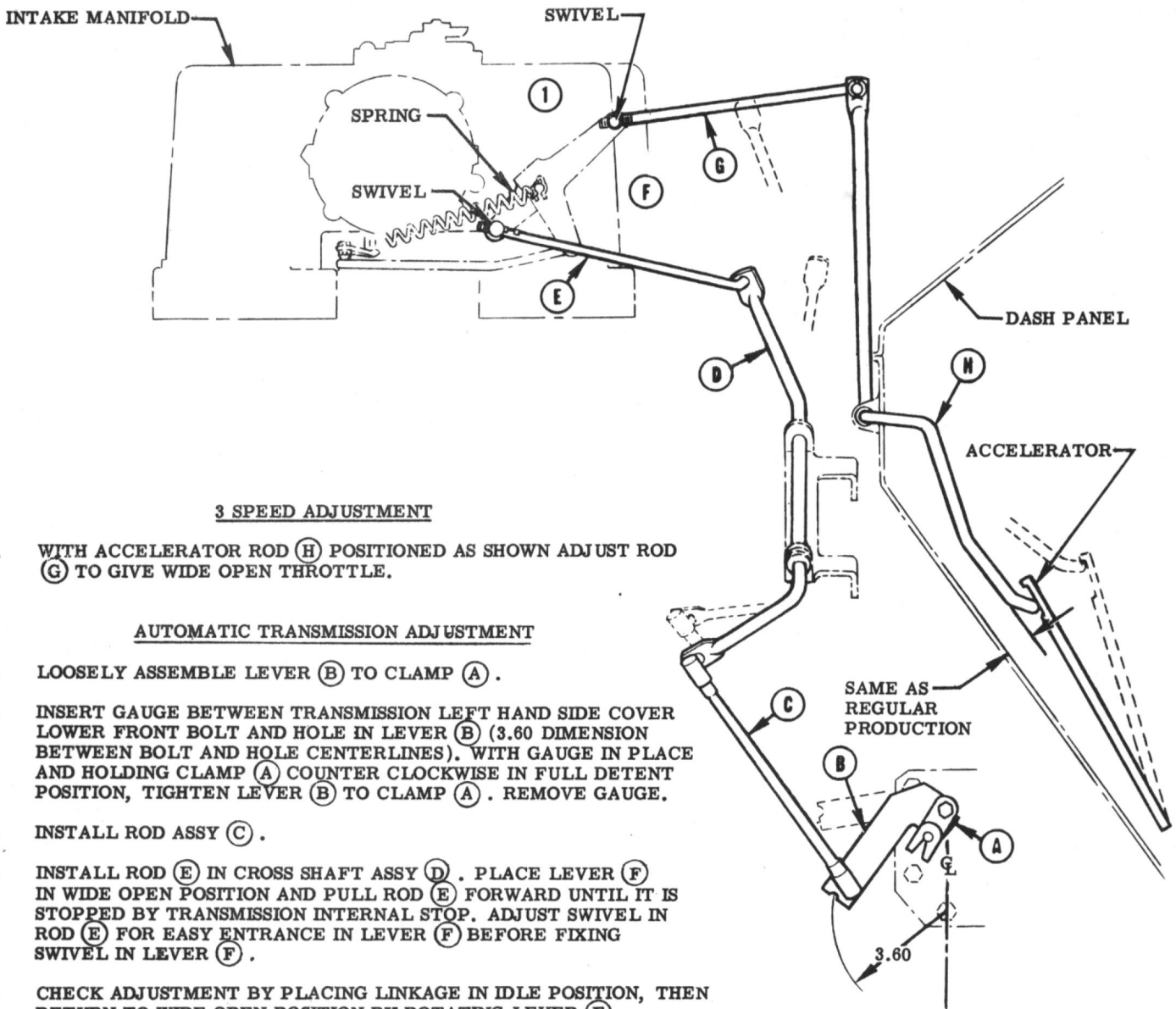

3 SPEED ADJUSTMENT

1. WITH ACCELERATOR ROD (H) POSITIONED AS SHOWN ADJUST ROD (G) TO GIVE WIDE OPEN THROTTLE.

AUTOMATIC TRANSMISSION ADJUSTMENT

1. LOOSELY ASSEMBLE LEVER (B) TO CLAMP (A).
2. INSERT GAUGE BETWEEN TRANSMISSION LEFT HAND SIDE COVER LOWER FRONT BOLT AND HOLE IN LEVER (B) (3.60 DIMENSION BETWEEN BOLT AND HOLE CENTERLINES). WITH GAUGE IN PLACE AND HOLDING CLAMP (A) COUNTER CLOCKWISE IN FULL DETENT POSITION, TIGHTEN LEVER (B) TO CLAMP (A). REMOVE GAUGE.
3. INSTALL ROD ASSY (C).
4. INSTALL ROD (E) IN CROSS SHAFT ASSY (D). PLACE LEVER (F) IN WIDE OPEN POSITION AND PULL ROD (E) FORWARD UNTIL IT IS STOPPED BY TRANSMISSION INTERNAL STOP. ADJUST SWIVEL IN ROD (E) FOR EASY ENTRANCE IN LEVER (F) BEFORE FIXING SWIVEL IN LEVER (F).
5. CHECK ADJUSTMENT BY PLACING LINKAGE IN IDLE POSITION, THEN RETURN TO WIDE OPEN POSITION BY ROTATING LEVER (F). PUSH UPWARD ON LEVER (B) AND NOTE IF ROD (C) DEFLECTS, MEANING TRANSMISSION IS NOT ON INTERNAL STOP. IF ROD DEFLECTS, OR LEVER (F) WILL NOT REACH WIDE OPEN POSITION, REPEAT ADJUSTMENT 4.
6. WITH ACCELERATOR PEDAL DEPRESSED, PLACING LOWEST POINT ON ACCELERATOR ROD THE SAME DISTANCE ABOVE THE TOE PANEL AS REGULAR PRODUCTION, AND LEVER (F) ROTATED TO WIDE OPEN POSITION, ADJUST SWIVEL IN ROD (G) FOR FREE ENTRY INTO LEVER (F) BEFORE FIXING SWIVEL TO LEVER (F).
7. CHECK ADJUSTMENT BY RELEASING, THEN DEPRESSING ACCELERATOR PEDAL. CHECK LEVER (F) FOR WIDE OPEN POSITION. IF LEVER (F) WILL NOT REACH WIDE OPEN POSITION, REPEAT STEP 6.

FUEL INJECTION - LINKAGE ADJUSTMENT

					NAME						
					CORVETTE INSTRUCTION MANUAL						
DATE		SYM.	REVISION RECORD	AUTH.	DR.	CK.	REF.	DRAWN	CHECKED	R. P. O.	SHEET
4-12-57	1		SPRING REMOVED	305	V	F		V	F		
10-22-56			RELEASED	3750							
							DATE	PART No.		579	3.00
							10-3-56	3726900			

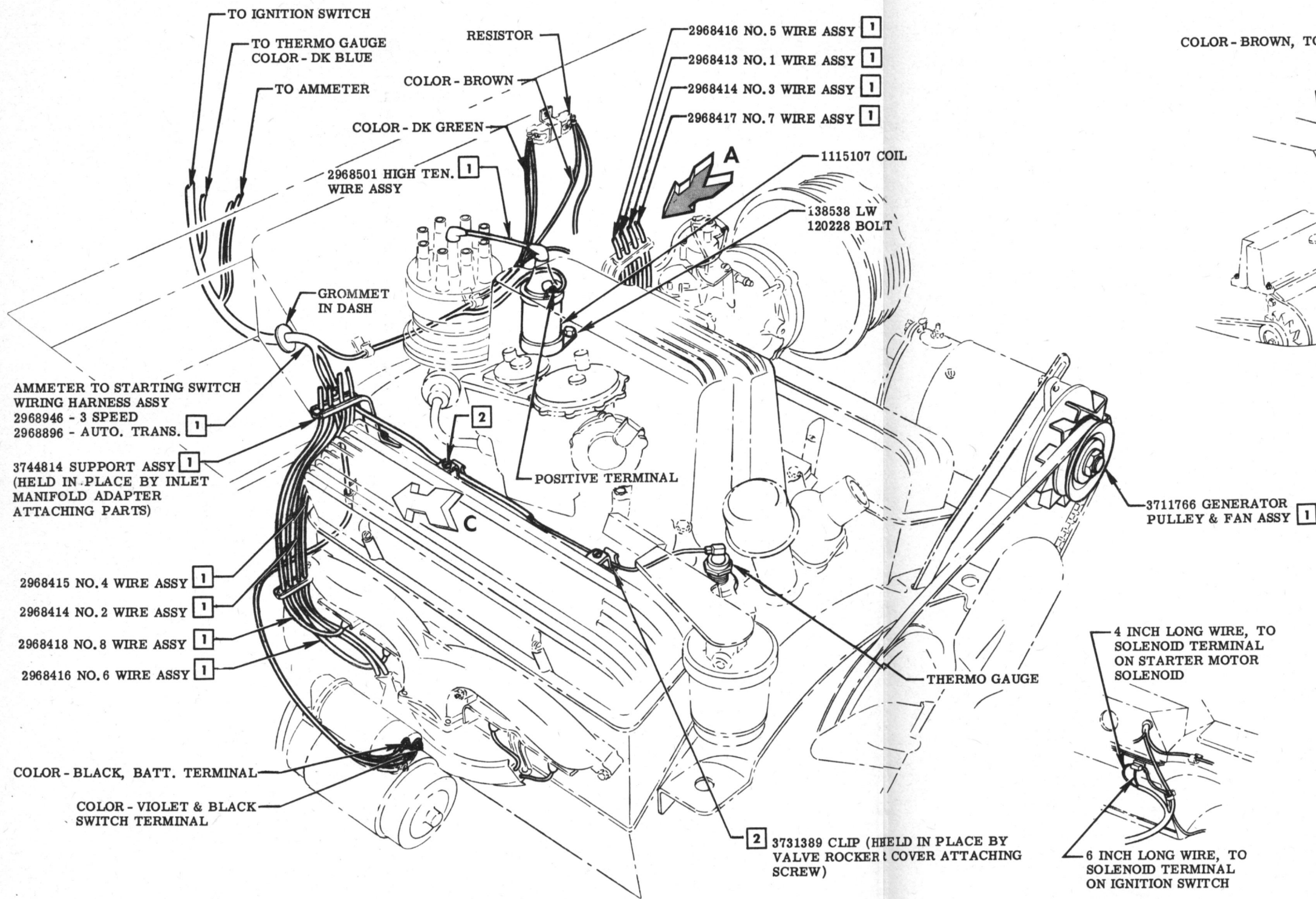

COLOR - BROWN, TO TOP TERMINAL OF RESISTOR

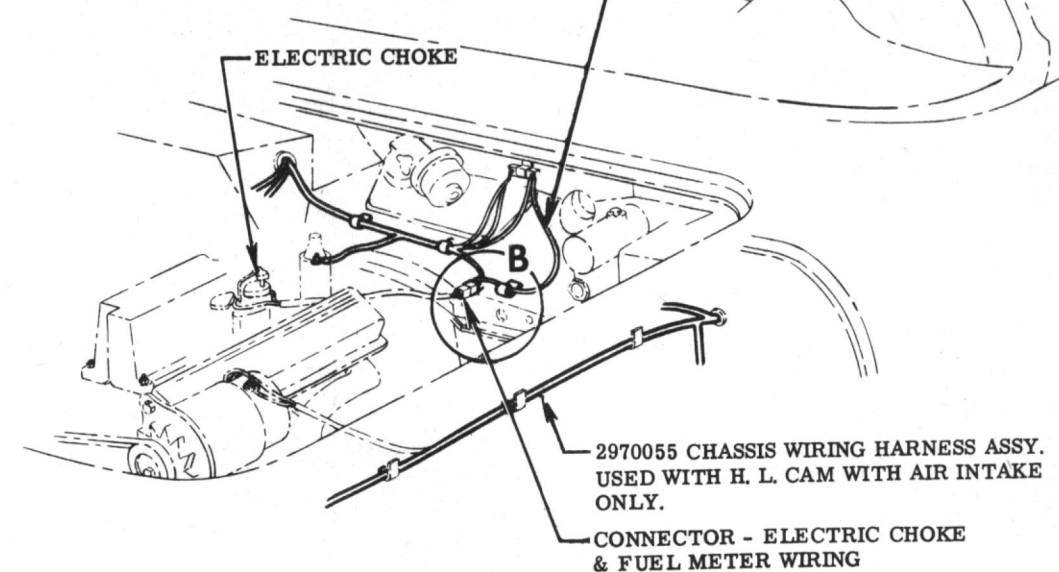

VIEW A

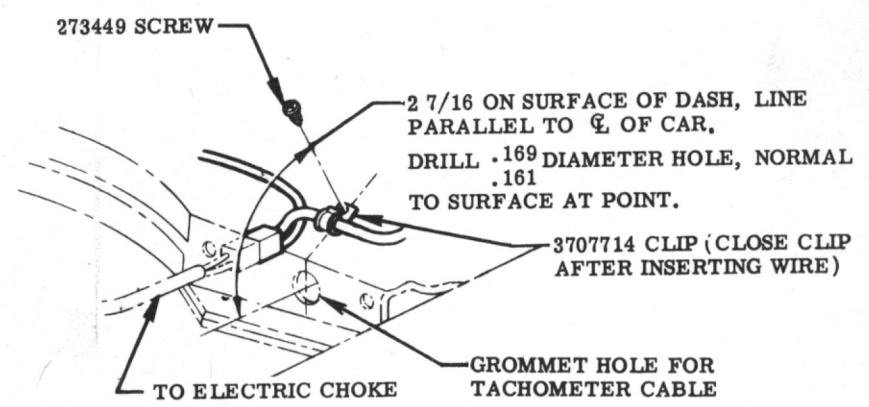

VIEW B

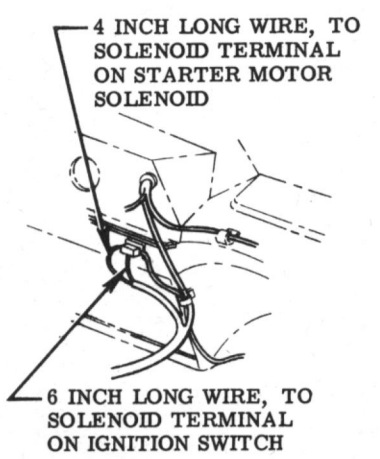

VIEW C
RPO 313 ONLY

1 NOT USED WITH HIGH LIFT CAM ENGINE WITH AIR INTAKE. SEE SHEET 1.02

FUEL INJECTION - ELECTRICAL

							NAME CORVETTE INSTRUCTION MANUAL				
							REF.	DRAWN	CHECKED	R. P. O.	SHEET
								V	F		
7-25-57	5	REDRAWN & REVISED	8949	603	V	F	DATE	PART No.	3726900	579	4.00
DATE	SYM.	REVISION RECORD		AUTH.	DR.	CK.	9-5-56				

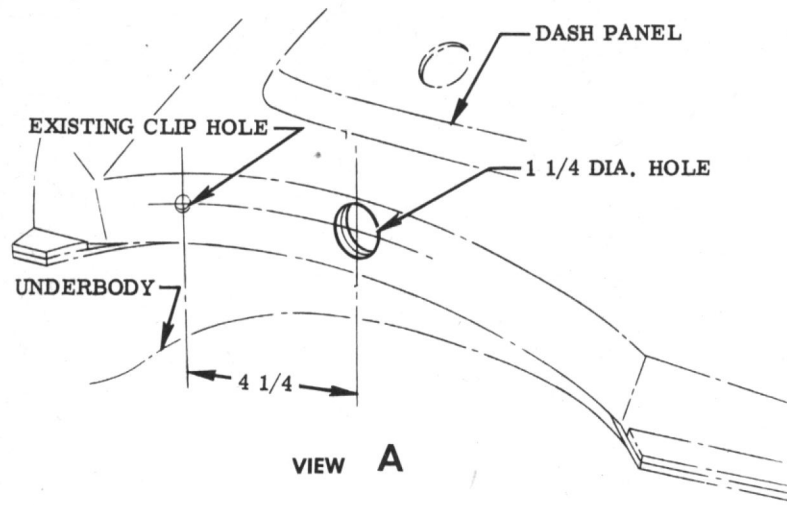

NOTE: COVER TACHOMETER HOLE IN INSTRUMENT PANEL BY USING .10 FLAT PLASTIC SHEET. CEMENT IN PLACE AND FINISH OFF.

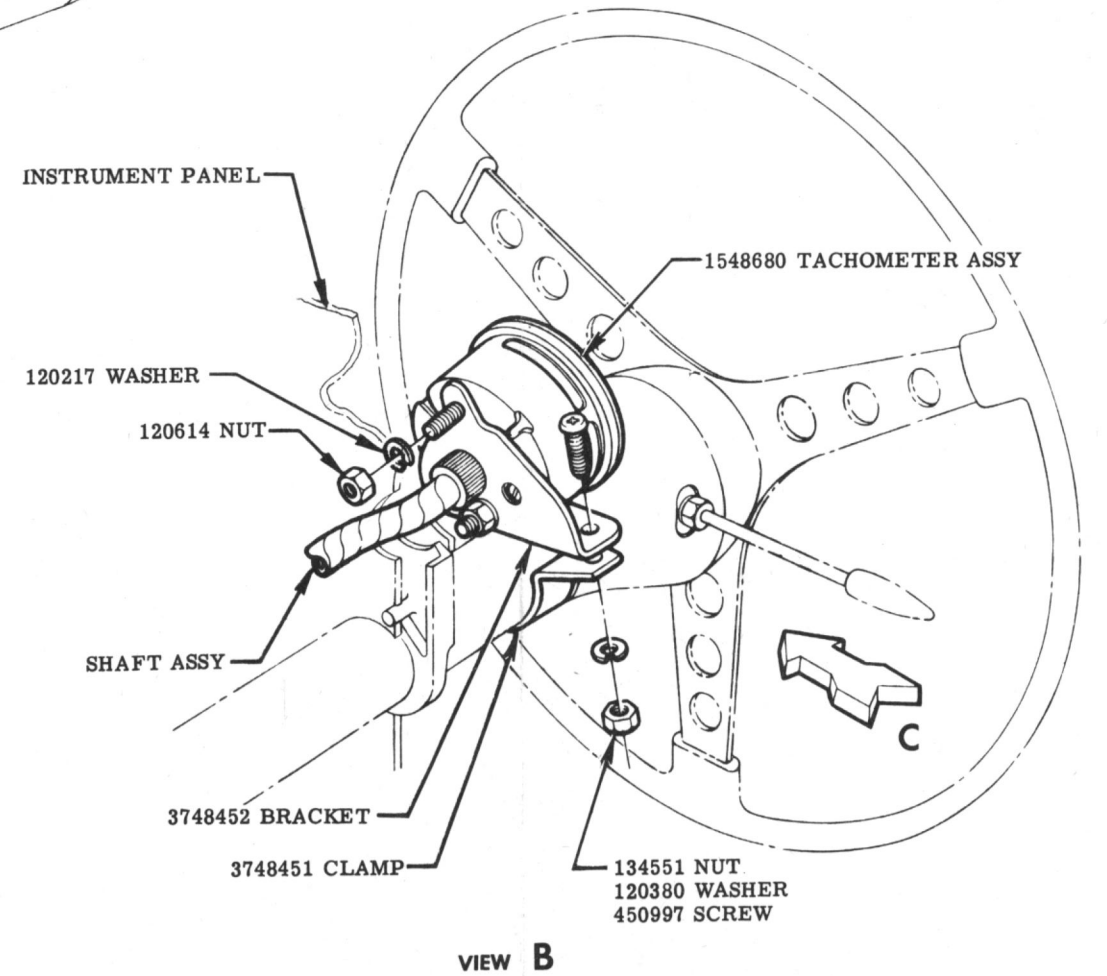
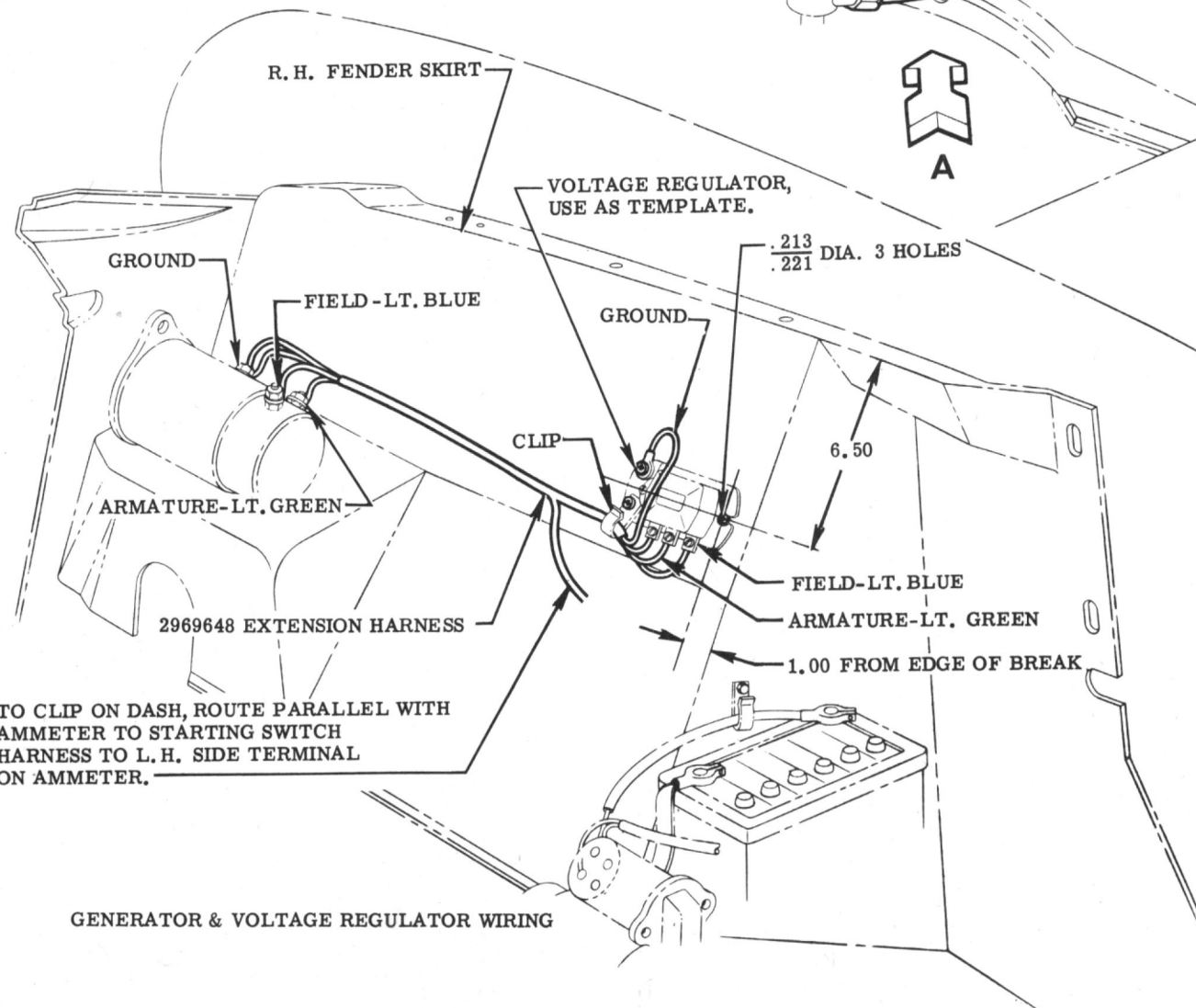
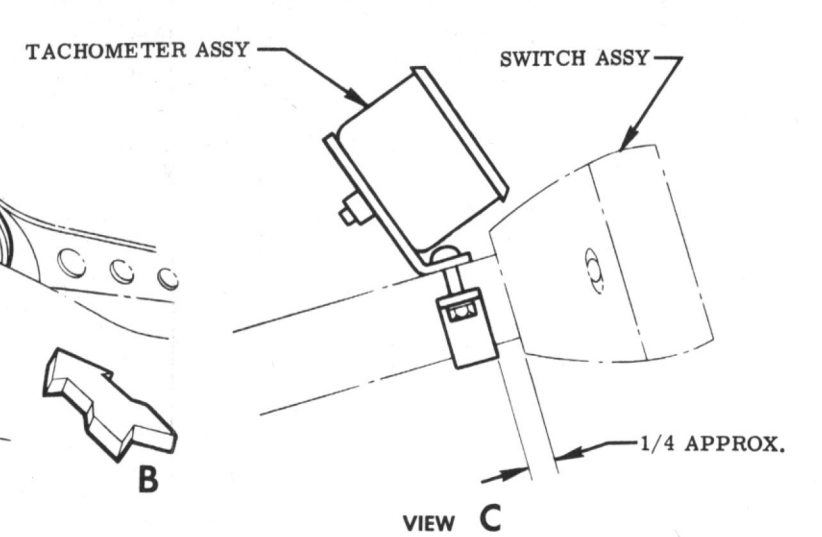
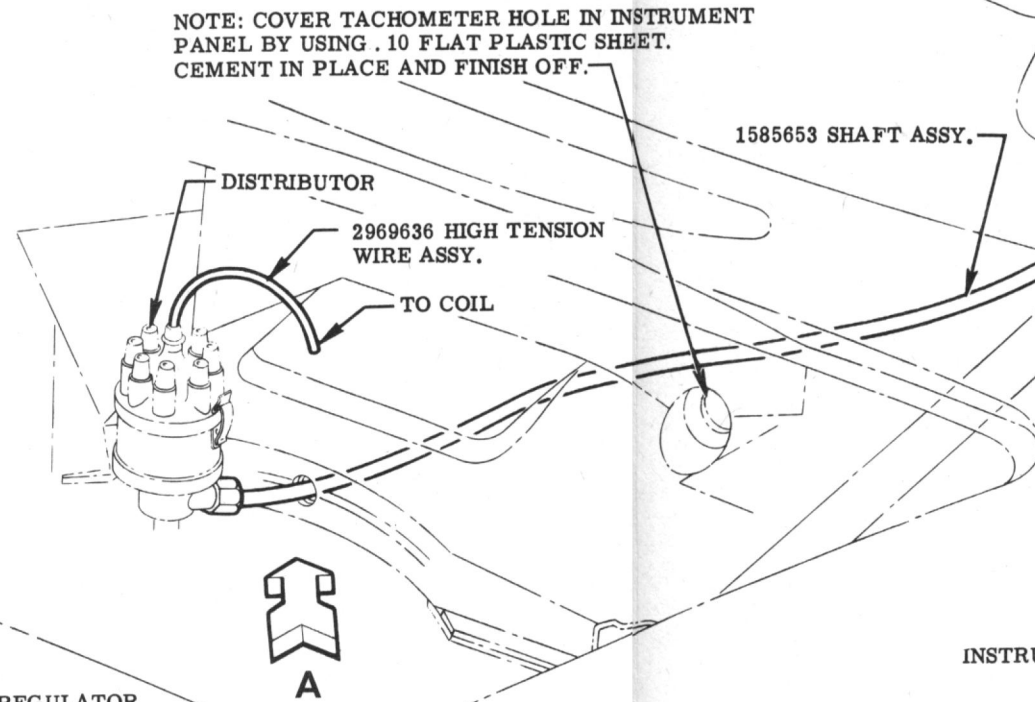

NAME							CORVETTE INSTRUCTION MANUAL			
DATE	SYM.	REVISION RECORD	AUTH.	DR.	CK.	DATE	PART No.	CHECKED	R. P. O.	SHEET
7-25-57	1	REDRAWN & REVISED	603	V	F	3-18-57	3726900	V	F	579 4.01

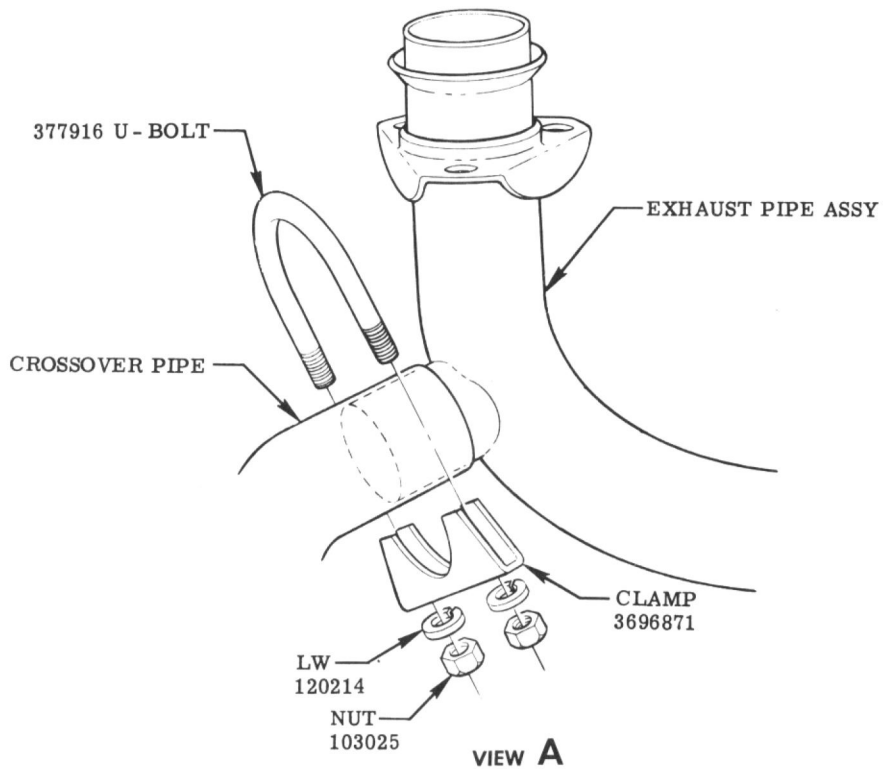
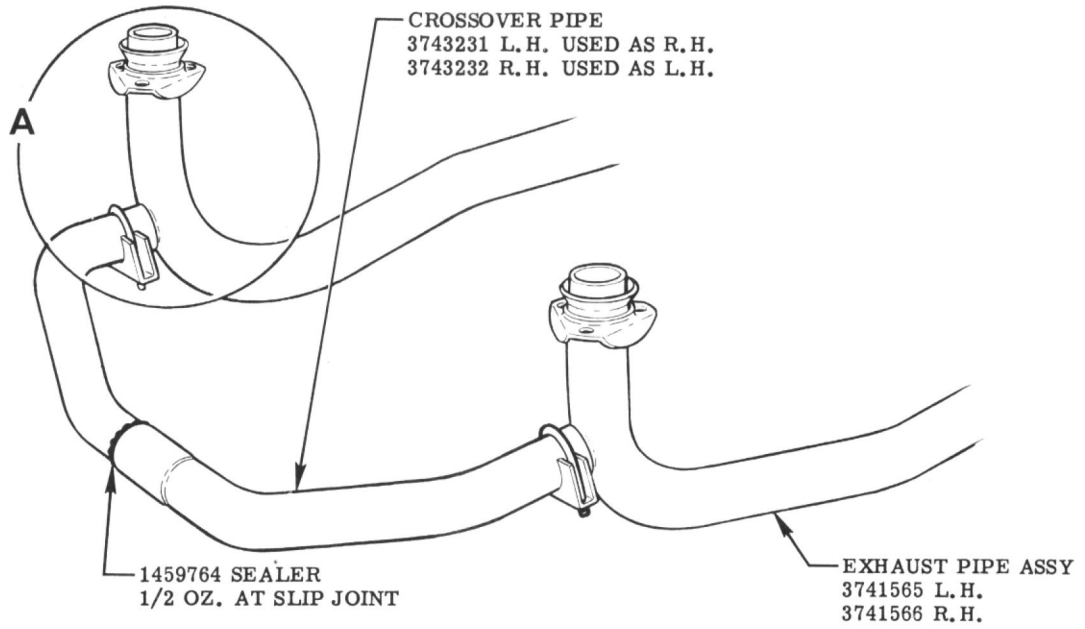

FUEL INJECTION - EXHAUST

				NAME					CORVETTE INSTRUCTION MANUAL	
				REF.	DRAWN	CHECKED	R. P. O.	SHEET		
					V	F	579		5.00	
10-22-56		RELEASED	3750	DATE	PART No.					
DATE	SYM.	REVISION RECORD	AUTH. DR. CK.	10-9-56	3726900					