

WALKER BROTHERS
MANUFACTURING CO.

4 REAR
SUSPENSION

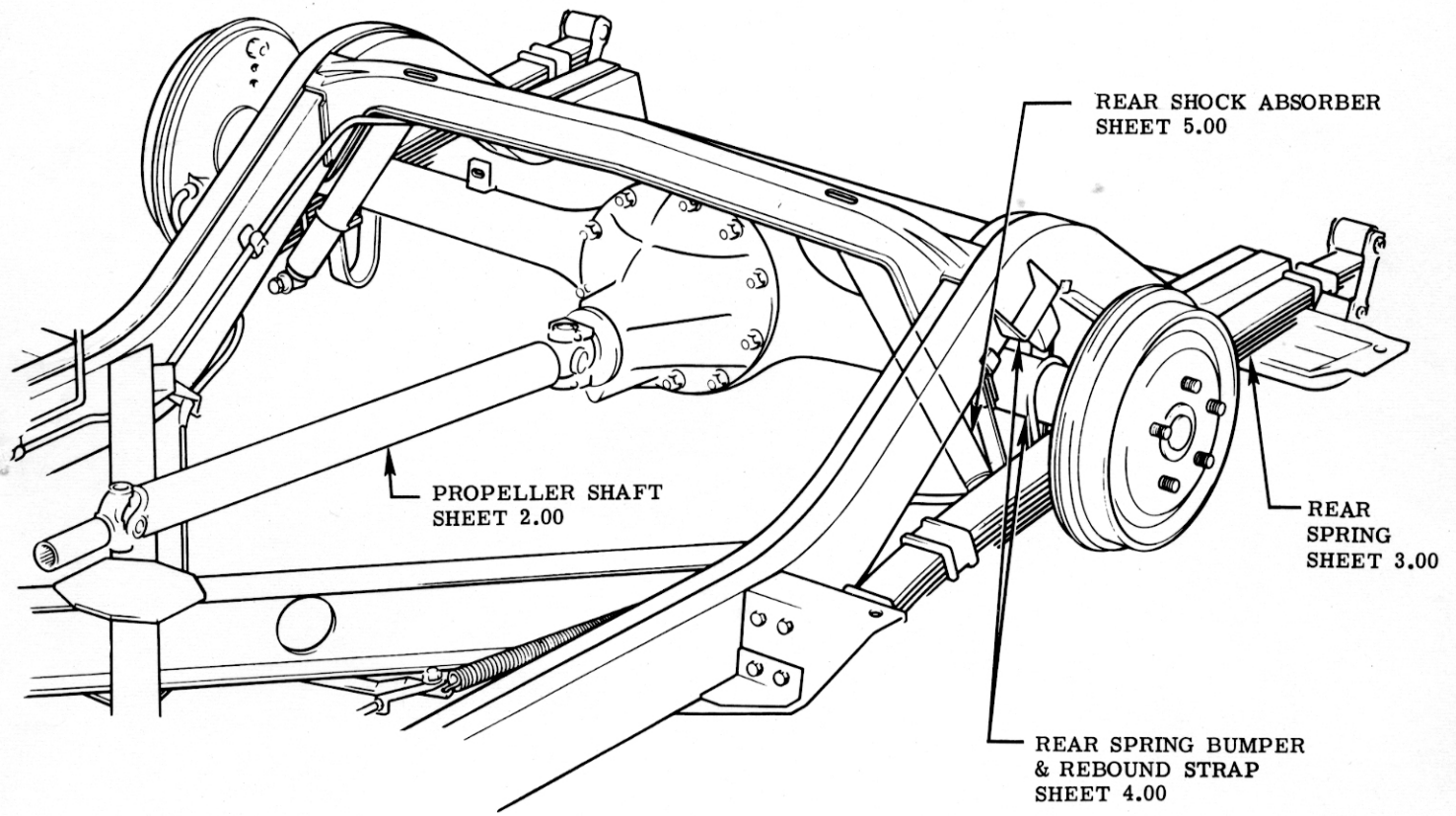

REAR SUSPENSION

						NAME	CORVETTE INSTRUCTION MANUAL			
						REF.	DRAWN O. W.	CHECKED N. D.	SECT.	SHEET
						DATE	PART No.	3726900	4	1.00
DATE	SYM.	REVISION RECORD	AUTH.	DR.	CK.	9-15-55				

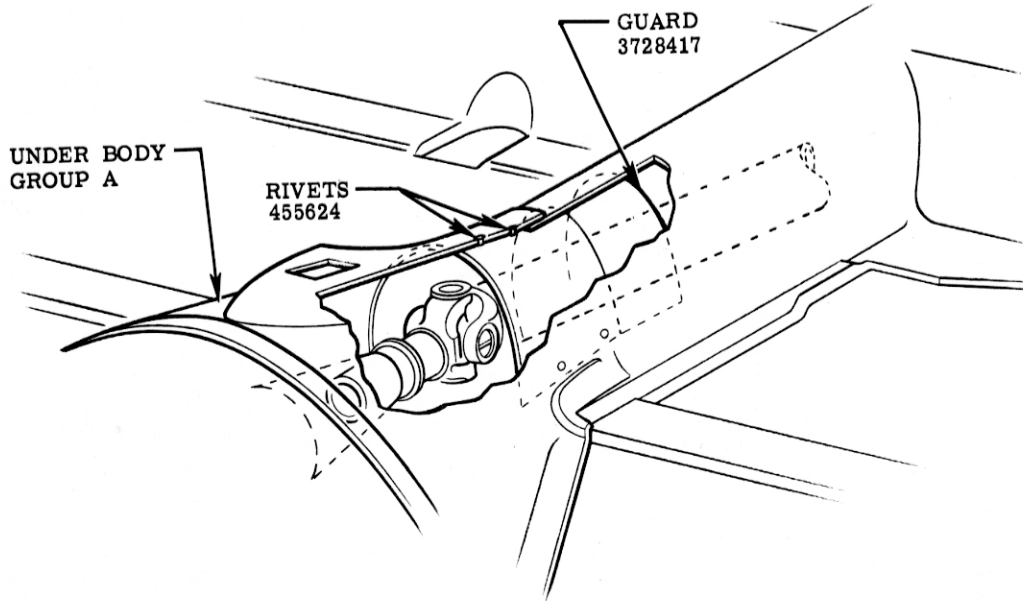
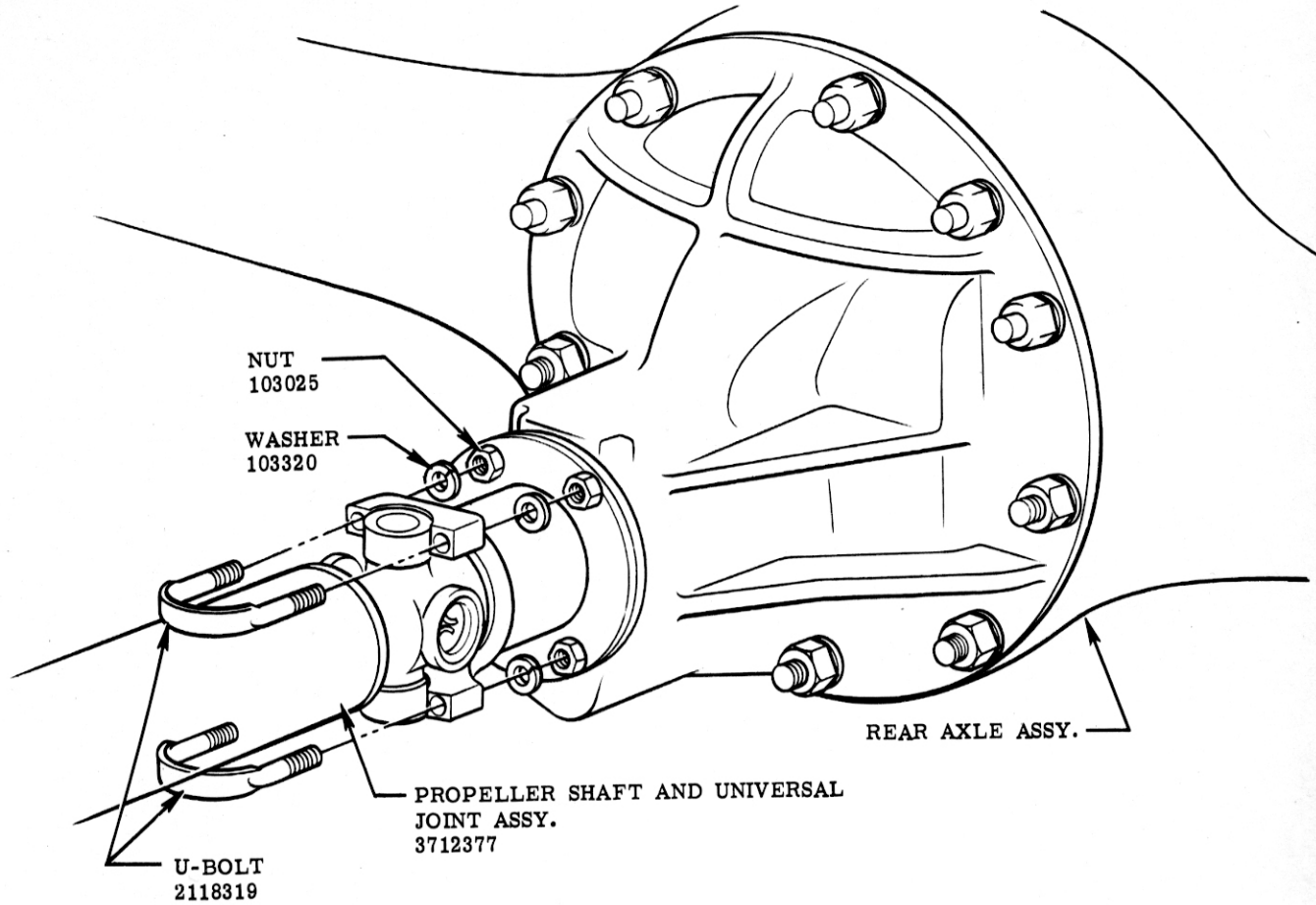

SEE LUBRICATION CHART SECTION 14
PROPELLER SHAFT

						NAME				
						CORVETTE INSTRUCTION MANUAL				
						REF.	DRAWN W.S.	CHECKED N.D.	SECT.	SHEET
						DATE	PART No.		4	2.00
						9-15-55	3726900			
DATE	SYM.	REVISION RECORD			AUTH.	DR.	CK.			

Schwartz

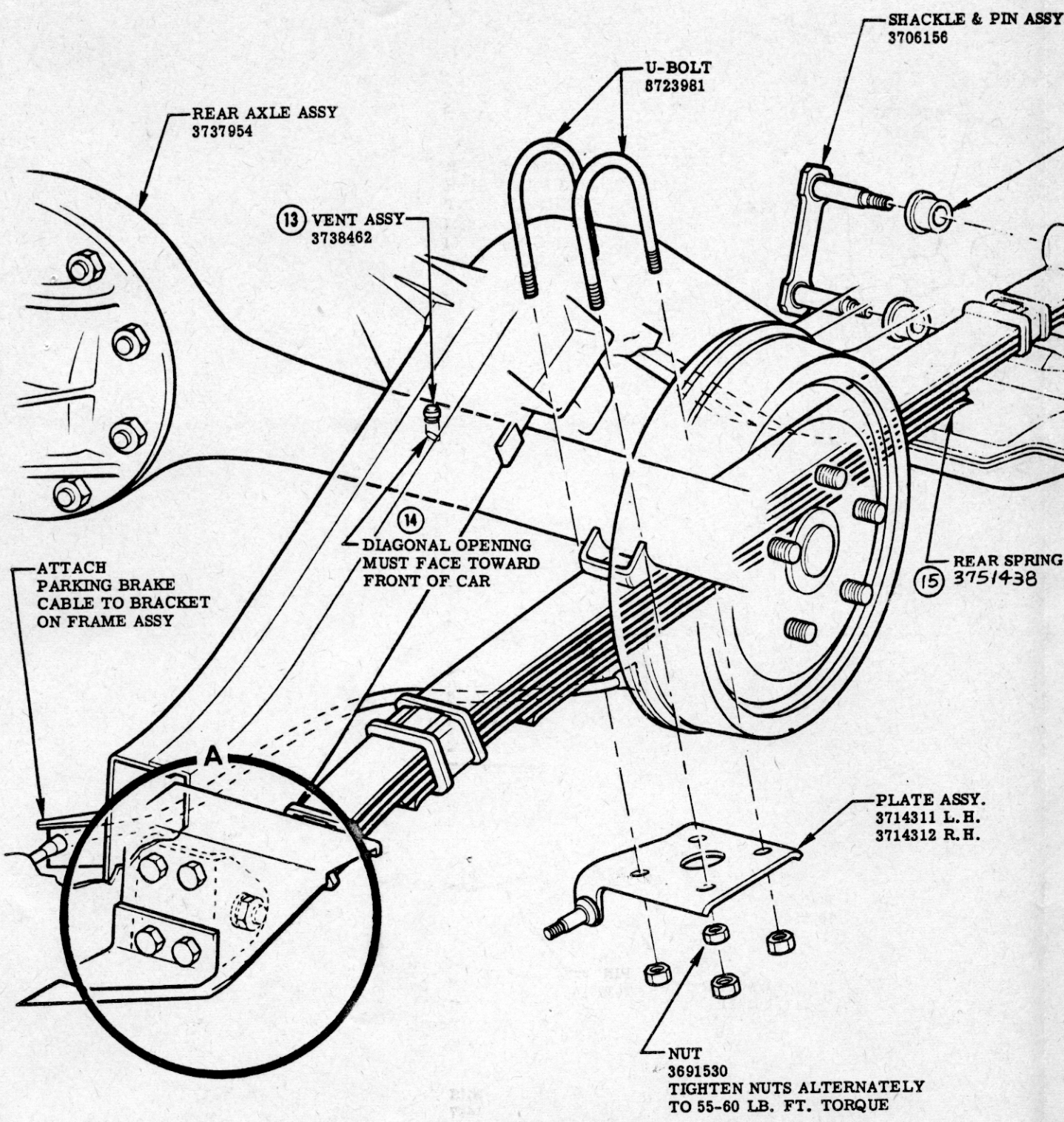

SEE LUBRICATION CHART SECTION 14

REAR SPRING & REAR AXLE

SY

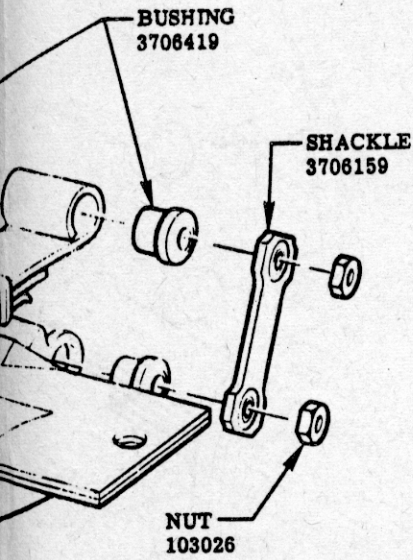

SHACKLE ASSEMBLY INSTRUCTION

1. CLEAN CENTERS & EDGES OF BOTH SPRING EYES.
2. CLEAN EYE OF REAR SPRING REAR HANGER.
3. PLACE ONE BUSHING ON EACH BOLT OF THE SHACKLE & PIN ASSY. & INSERT ASS'Y. INTO HANGER & SPRING.
4. ASSEMBLE REMAINING BUSHINGS & SHACKLE.
5. TIGHTEN NUTS ALTERNATELY, TO PREVENT COCKING OR BINDING, TO A TORQUE OF 25 - 30 LB. FT. WITH A SLOW SPEED WRENCH.

NG ASSY.

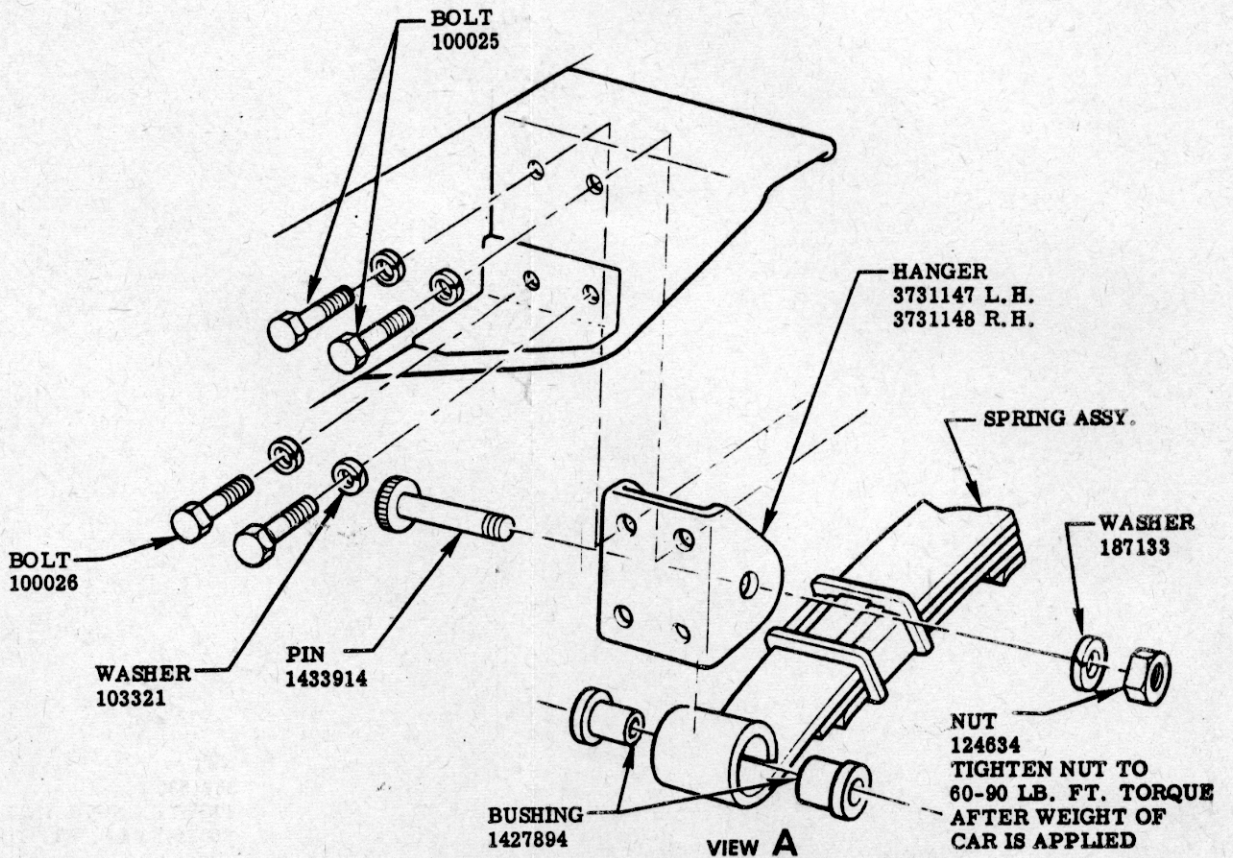

					NAME CORVETTE INSTRUCTION MANUAL				
6-18-57	15	WAS 3711550	2071	F	REF.	DRAWN	CHECKED	SECT.	SHEET
	14	NOTE ADDED		F		O. W.	N. D.	4	3.00
	13	WAS 3700490			DATE	PART No.	3726900		
11-15-56	12	REDRAWN	5223	V	9-15-55				
DATE	SYM.	REVISION RECORD	AUTH.	DR.	CK.				

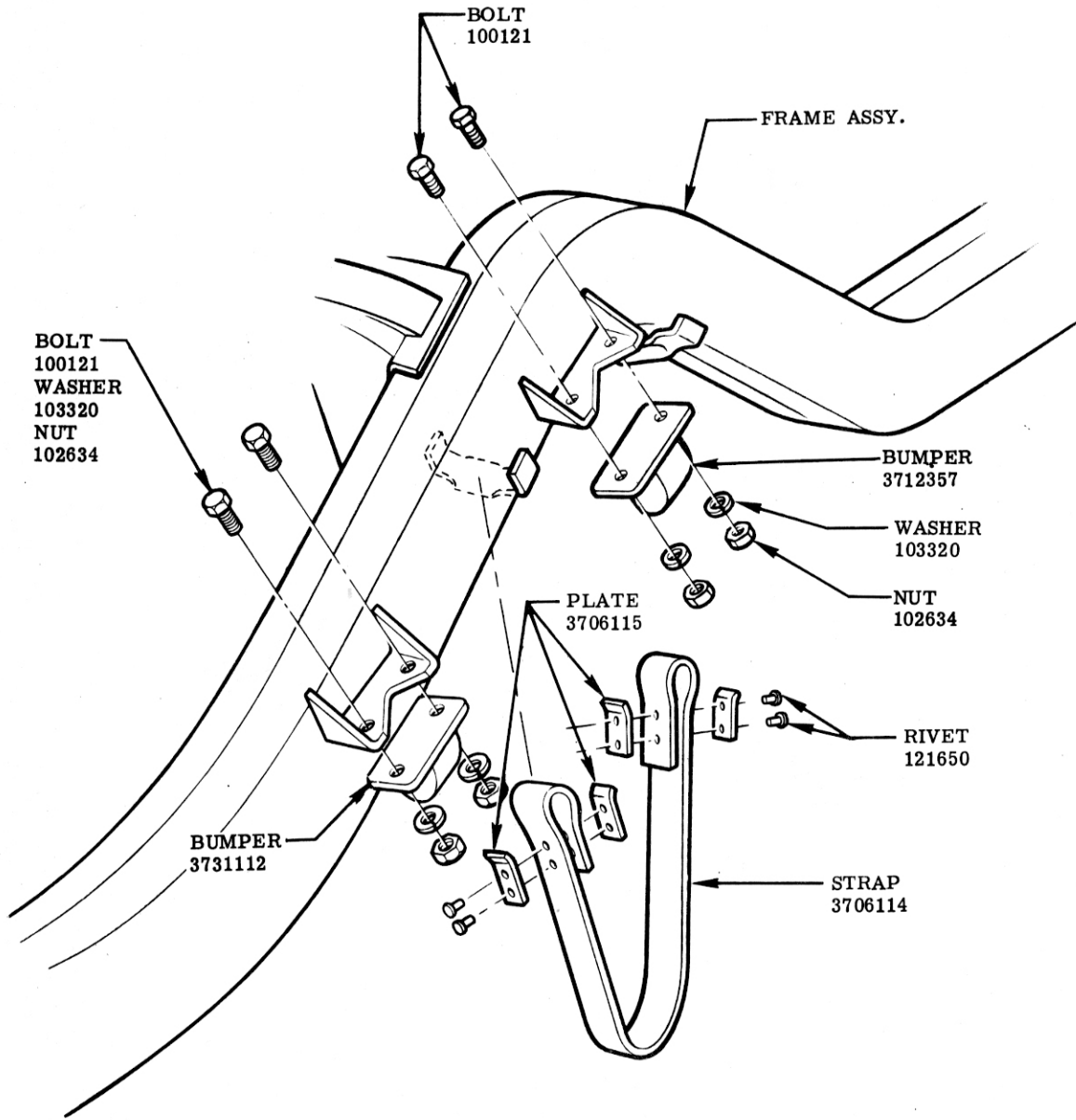

BUMPERS & REBOUND STRAP.

						NAME	CORVETTE INSTRUCTION MANUAL			
						REF.	DRAWN O. W.	CHECKED N. D.	SECT.	SHEET
4-2-57	5	REDRAWN & REVISED	374	V	F	DATE	PART No.		4	4.00
DATE	SYM.	REVISION RECORD	AUTH.	DR.	CK.	9-15-55	3726900			

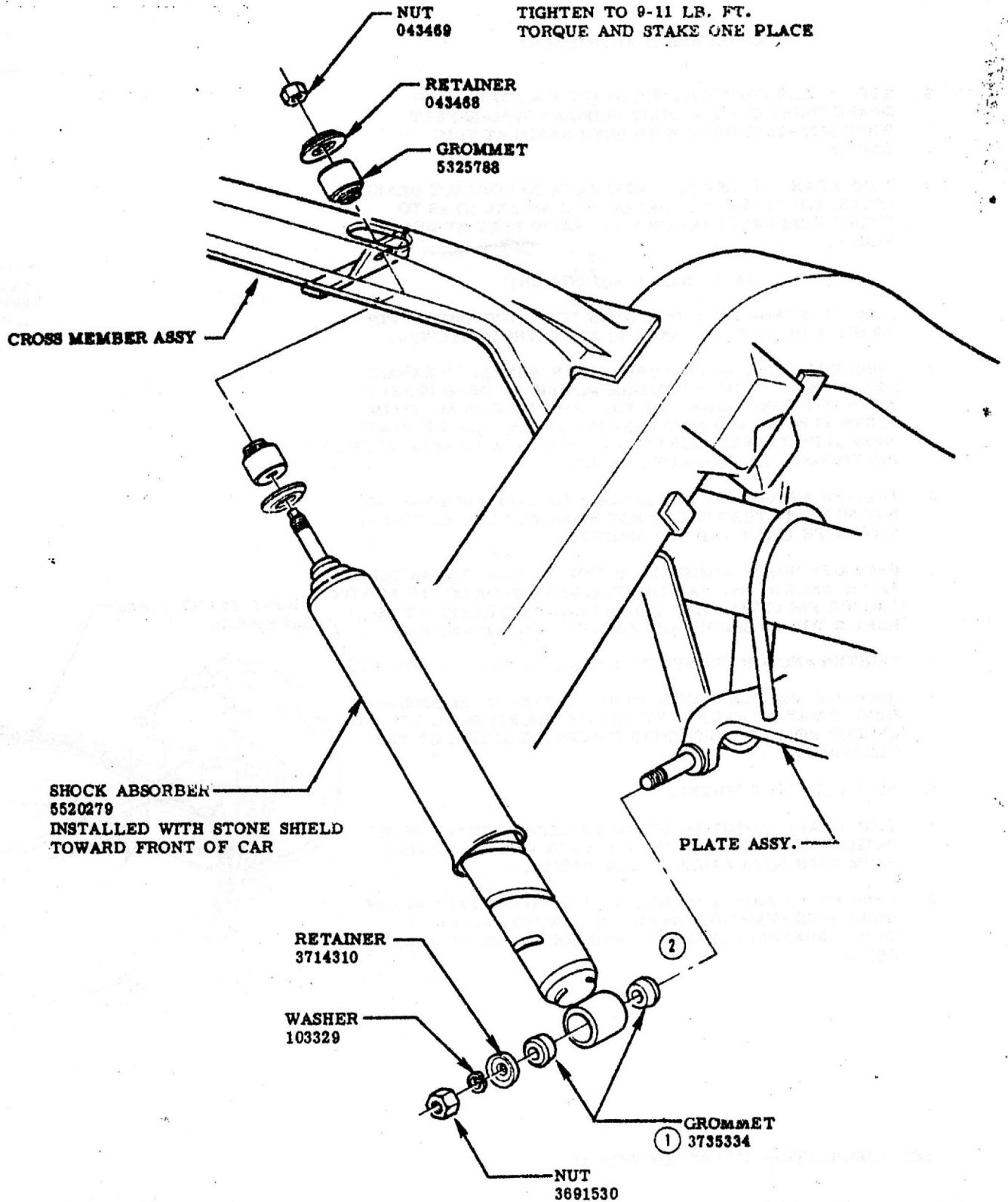

REAR SHOCK ABSORBER.

					NAME CORVETTE INSTRUCTION MANUAL				
					REF.	DRAWN O. W.	CHECKED N. D.	SECT.	SHEET
3-12-56	2	VIEW REVISED		F	DATE	PAR. N.	3726900	4	5.00
3-27-56	1	WAS 5313726	7445	F	9-15-55				
DATE	SYM.	REVISION RECORD	AUTH.	DR.	CK.				

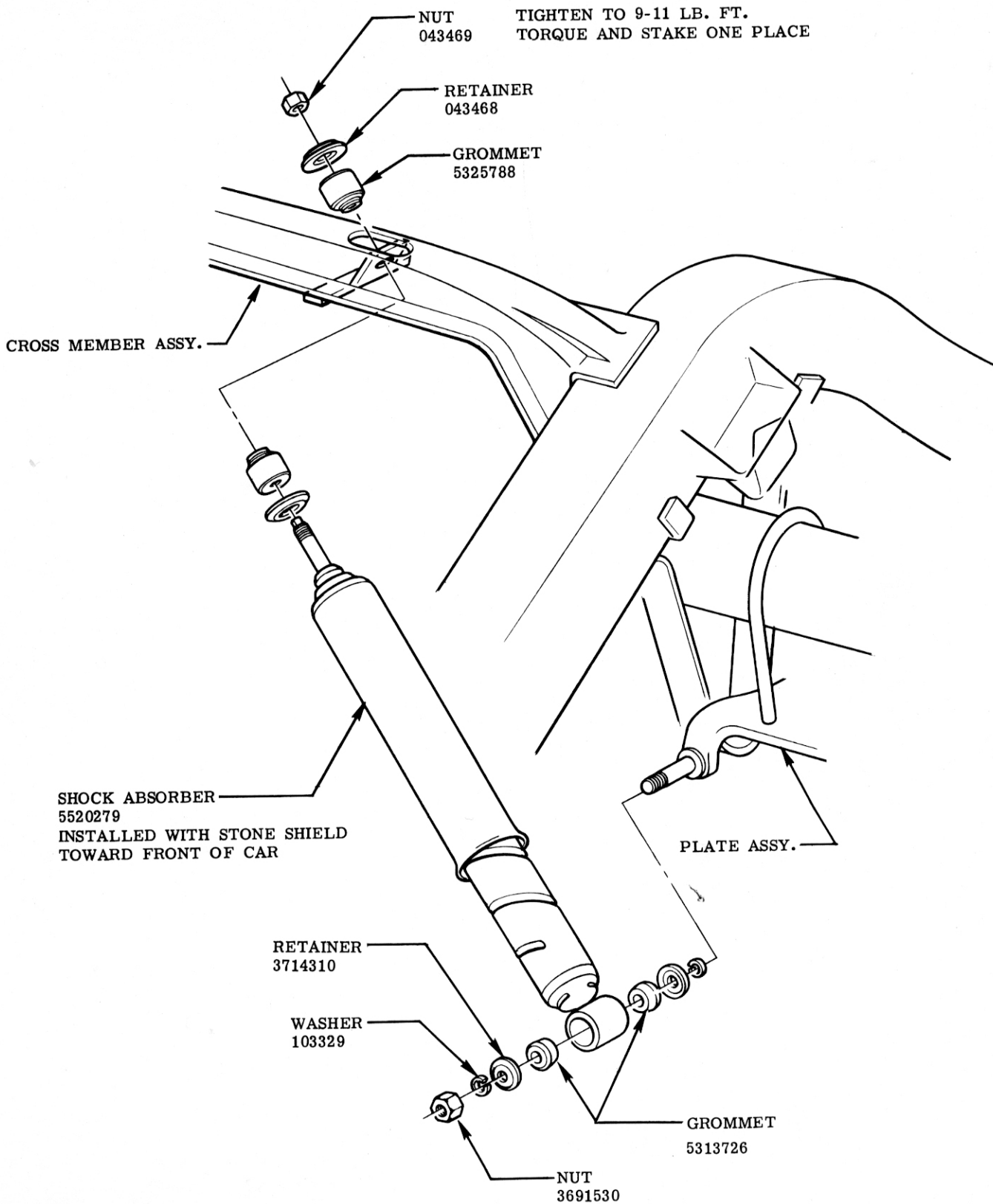

REAR SHOCK ABSORBER

						NAME	CORVETTE INSTRUCTION MANUAL			
						REF.	DRAWN O. W.	CHECKED N. D.	SECT.	SHEET
						DATE	PART No.		4	5.00
DATE	SYM.	REVISION RECORD		AUTH.	DR.	CK.	9-15-55	3726900		